

Excellent Integrated System Limited

Stocking Distributor

Click to view price, real time Inventory, Delivery & Lifecycle Information:

[Molex Connector Corporation](#)
[0357607205](#)

For any questions, you can email us directly:

sales@integrated-circuit.com

DWG. NO. SD 35760-7**0
 SIMILAR ITEM
 PROJECT NO.
 c
 B
 DO NOT SCALE DRAWING
 DIMENSION IN METRIC

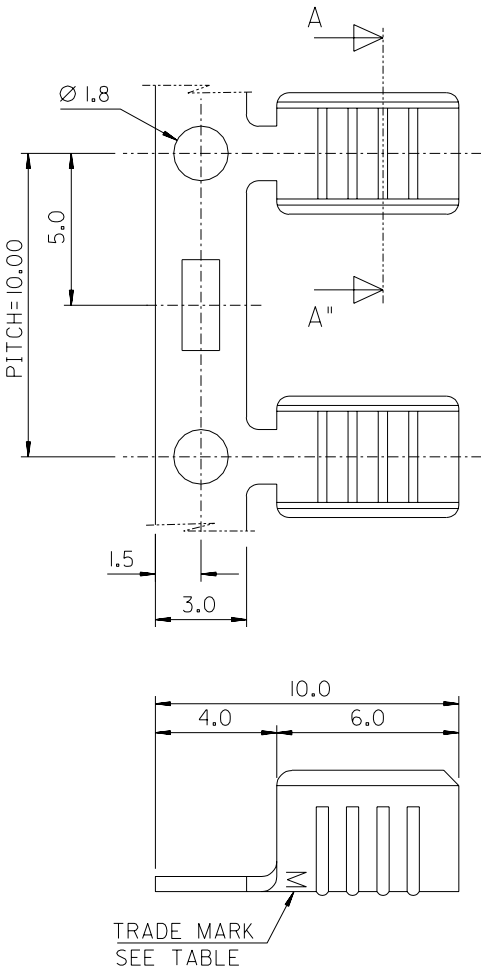

NOTES

1. MATERIAL : BRASS , 0.5mm THICKNESS
2. PART NO.

PART NO.	DIM'S		FINISH	WIRE SIZE	MAT'L THICK'	TRADE MARK
	a	b				
35760-7100	3.3	3.3	UNPLATED	#20-#16	0.5mm	MK2
35760-7110			POST PLATED TIN			
35760-7140			TIN-LEAD			
35760-7200	4.2	4.2	UNPLATED	#16-#12	0.4mm	MK24
35760-7210			POST PLATED TIN			
35760-7240			TIN-LEAD			
35760-7205			POST PLATED TIN			

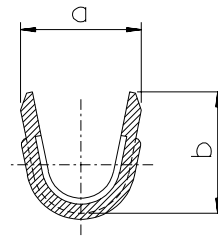

SEC' : A-A''

REVISED	EC NO. DRAWN BY: YANG 01/11/15 CHK: APPR:	DESCRIPTION	QUALITY SYMBOLS	GENERAL TOLERANCES: (UNLESS SPECIFIED)		SCALE 8:1	DESIGN UNITS <input checked="" type="checkbox"/> mm <input type="checkbox"/> INCH	DIMENSIONS: <input type="checkbox"/> INCH <input type="checkbox"/> INCH <input checked="" type="checkbox"/> mm <input type="checkbox"/> mm ONLY		SHT	REV
			MAJOR = 0	mm	INCH	DRAWN BY & DATE J.S.KANG 93/10/07		THIRD ANGLE PROJECTION		REVISE ON CAD ONLY	
			CRITICAL = 0	±	±	CHECKED BY & DATE B.K.CHOI 93/10/07		TITLE: WIRE SPLICE (S),(SM)			
				±0.20	±	APPROVED BY & DATE C.W.LEE 93/10/07		MOLEX INCORPORATED KOREA			
B	REV		±0.30	±	ANGULAR: ± °	CAD FILENAME S7607100.DGN	MATERIAL NO. SEE TABLE	DRAWING NO. SD-35760-7**0	SHEET NO. 1 OF 1	SIZE B	
DRAFT WHERE APPLICABLE MUST REMAIN WITHIN DIMENSIONS						THIS DRAWING CONTAINS INFORMATION THAT IS PROPRIETARY TO MOLEX INCORPORATED AND SHOULD NOT BE USED WITHOUT WRITTEN PERMISSION.					