

Excellent Integrated System Limited

Stocking Distributor

Click to view price, real time Inventory, Delivery & Lifecycle Information:

[Switchcraft Inc.](#)
[EN3IPCAP](#)

For any questions, you can email us directly:

sales@integrated-circuit.com

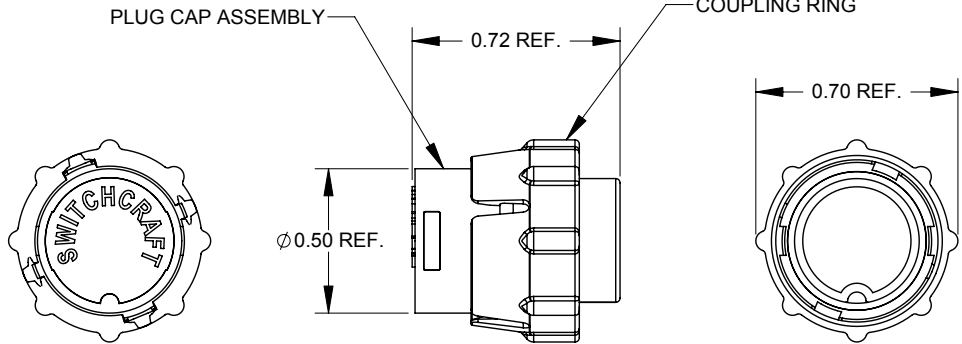
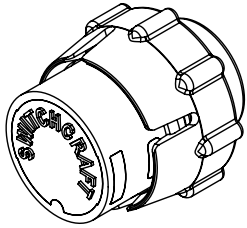

NOTES:

1. EN3 SERIES PLUG CAP MATES WITH ANY EN3 SERIES PANEL MOUNT CONNECTOR TO PROVIDE THE FOLLOWING ENVIRONMENTAL PROTECTION:
IP16/IP18
IP66/IP68
NEMA 250 (6P)
CFR 46 PART 110.20
2. MATERIAL:
CORD CONNECTOR SHELL, COUPLING RING - THERMOPLASTIC, FLAME RETARDANT
CONNECTOR SHELL INTERIOR - THERMOPLASTIC RUBBER, FLAME RETARDANT
3. DIMENSIONS SHOWN FOR REFERENCE ONLY
4. THIS PRODUCT IS RoHS COMPLIANT

CUSTOMER DRAWING

					THIS DRAWING DESCRIBES A DESIGN CONSIDERED PROPRIETARY IN NATURE, DEVELOPED AND MANUFACTURED BY SWITCHCRAFT INC. AND IS RELEASED ON A CONFIDENTIAL BASIS FOR IDENTIFICATION PURPOSES ONLY.								
UNLESS OTHERWISE SPECIFIED 1. ALL DIMENSIONS IN INCHES - TWO PLACE DECIMALS ±0.02 - THREE PLACE DECIMALS ±0.005					SIZE *	WIDTH *	MULT *	LBS/M *	TEMPER *				
					FINISH *				MATERIAL (SEE NOTES)				
					SPEC No. *				SPEC No. *				
					FIRST USED ON *				SCALE 2:1				
DATE DRAWN	BY	CHKD	APVD										
9/6/07	PNK	PNK	SRC										
REVISIONS					NAME		PART No.			REV			
					PLUG CAP, EN3 SERIES		EN3IPCAP			A			

DO NOT SCALE DRAWING
SolidWorks CAD File