

Excellent Integrated System Limited

Stocking Distributor

Click to view price, real time Inventory, Delivery & Lifecycle Information:

[FCI](#)
[95121-003](#)

For any questions, you can email us directly:
sales@integrated-circuit.com

Tous droits strictement réservés. Reproduction ou communication à des tiers interdite sans autorisation écrite du propriétaire. Propriété de FCI. Droits de reproduction FCI.



All rights strictly reserved. Reproduction or issue to third parties in any form whatsoever is not permitted without written authority from the proprietor. Property of FCI. Copyright FCI.

PRODUCT NO.	DIM L	APPLICATION ④	STAND-OFF HEIGHT (mm)
95121-001	6	SINGLE DECK	0
95121-002	12	SINGLE DECK DOUBLE DECK	5
95121-003	14	DOUBLE DECK	2, 2.2
95121-004	8	SINGLE DECK	2, 2.2
95121-005	10	SINGLE DECK	4, 4.3
95121-006	16	DOUBLE DECK	4, 4.3
95121-007	18	DOUBLE DECK	5
95121-008	20	DOUBLE DECK	6

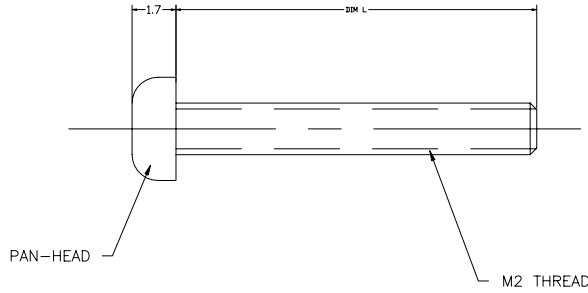
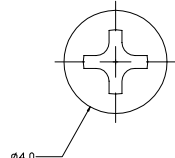

NOTES:

- ① MATERIAL: STEEL
- 2 PLATING: NICKEL OR ZINC
- 3 PACKAGING: BAGS OF 1,000
- ④ BASED ON .062in (1.57mm) PCB THICKNESS.
- 5 USE WITH HEX NUT 92869-001
- 6 THE P/N WITH "LF" SUFFIX IS LEAD FREE PART NUMBER
- 7 IF LEAD FREE P/N.THE PRODUCT MEETS EUROPEAN UNION DIRECTIVES AND OTHER COUNTRY REGULATIONS AS DESCRIBED IN GS-22-008
- 8 LEAD FREE P/N PACKAGING MEETS GS-14-920 SPECIFICATION

mat'l. code		NOTE 1		tolerances unless otherwise specified		CUSTOMER COPY		FCI Electronics www.fciconnect.com	
ltr	ecn no	dr	date	linear	.X±.3	projection	title	M2 THREADED SCREW	
D	V12164	TFG	8/17/01		.XX±.13	MM	product family	MCS	code
E	V20092	RGD	1/15/02	angles	.XXX±.051	5:1	size	A4	dwg no
F	N07-0109	DT	4/26/07		0° ±2°		sheet	1 of 1	
				dr	D.SHEAFFER	11/1/94			
				enfr	D.BRANN	11/1/94			
				chr	D.BRANN	11/1/94			
				appd	D.BRANN	11/1/94			
sheet index	revision sheet	G	1						