

Excellent Integrated System Limited

Stocking Distributor

Click to view price, real time Inventory, Delivery & Lifecycle Information:

[FCI](#)
[HM2P09PDK3H0N9LF](#)

For any questions, you can email us directly:
sales@integrated-circuit.com

LOADING PATTERN MATING SIDE

f	0	0	0	0	0	0	0	0	0	0
e	4	4	4	4	4	6	4	4	4	4
d	4	4	4	4	4	6	4	4	4	4
c	4	4	4	4	4	6	4	4	4	4
b	4	4	4	4	4	6	4	4	4	4
a	6	6	6	6	4	6	4	4	4	4
z	0	0	0	0	0	0	0	0	0	0
P	0									
O	1									
S		5								
									1	

LOADED CONNECTOR ASSEMBLY
(FOR EXAMPLE)

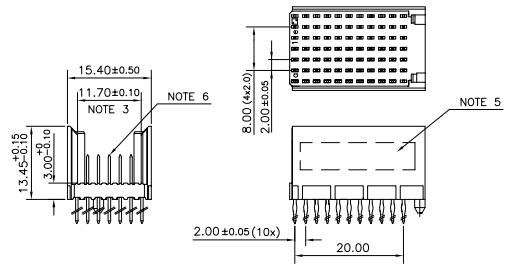

CONTACT OVERVIEW

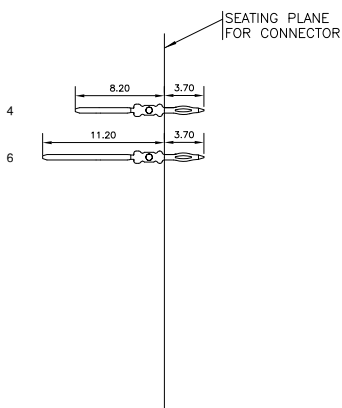

LAY-OUT P.C.B.-HOLE

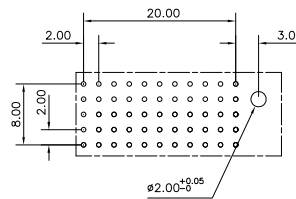

HM2P09PDK3H0N9LF
LEAD FREE INDICATOR : LF = LEAD FREE (DIGIT 15 & 16)
PLATING CODE (DIGIT 13 AND 14)
(REF DRW NO. BS,C , 201844 , 003)

NOTES

- THIS PRODUCT IS CSA APPROVED.
 - THIS PRODUCT IS UL RECOGNIZED.
 - MEASURED AT THE BOTTOM.
 - MATERIAL CONTACT: PHOSPHORBRONZE
HOUSING: CREAM WHITE GLASS FILLED POLYESTER UL-94V0
 - CONNECTOR PRINTED WITH P/N AND DATE CODE.
 - FOR ACTUAL CONTACT LOADINGS, SEE LOADING PATTERN MATING SIDE.
 - SHAPE OF CONNECTOR HOUSING CAN ALTER DEPENDING ON PRODUCTION LOCATION
 - THIS PRODUCT (LF) MEETS EUROPEAN UNION DIRECTIVES AND OTHER COUNTRY REGULATIONS AS DESCRIBED IN GS-22-008
 - FOR RECOMMENDED PTH DIMENSIONS REFER DRAWING : BS, A , 201572 , 001
- CATALOG NO: HM2P09PDK3H0----

mat'l. code	SEE NOTE 4	surface	tolerance	projection	product family
ISO 1302	ISO 406	ISO 1101			MILLIPACS
tr	ecn no	dr	date	tolerances unless otherwise specified	title
A	108-0004	MINI	2008-01-12	angles linear	MM
				0°±1"	scale
		dr	MINI K VANDANATH	2008-01-12	dwg no
		enrg	ALEX BABU	2008-01-12	sheet 1 of 1
		chr	ALEX BABU	2008-01-12	BS, C ,203028, 795
		appd	BIJU K PAUL	2008-01-12	A3
sheet	revision	A			type
index	sheet	1			Product Customer Drawing