

Excellent Integrated System Limited

Stocking Distributor

Click to view price, real time Inventory, Delivery & Lifecycle Information:

[FCI](#)
[HM2P66PNE364GF](#)

For any questions, you can email us directly:
sales@integrated-circuit.com

LOADING PATTERN MATING SIDE

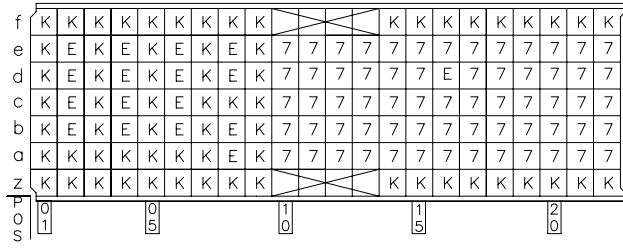

LOADED CONNECTOR ASSEMBLY
(FOR EXAMPLE)

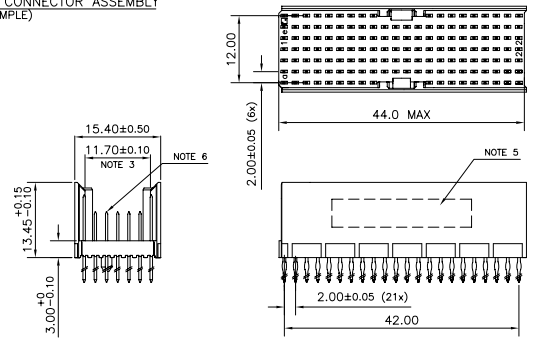

CONTACT OVERVIEW

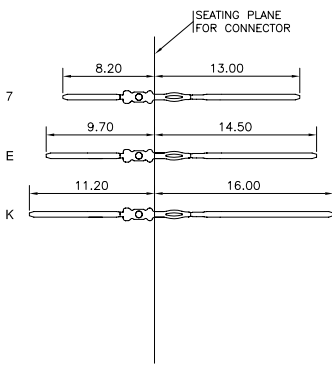

LAY-OUT P.C.B.-HOLE

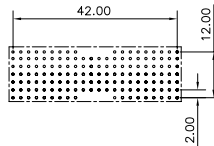

HM2P66PNE364 **LF** LEAD FREE INDICATOR : LF = LEAD FREE (DIGIT 15 & 16)
PLATING CODE (DIGIT 13 AND 14) (REF DRW NO. BS, C , 201844 , 003)

NOTES

- THIS PRODUCT IS CSA APPROVED.
 - THIS PRODUCT IS UL RECOGNIZED.
 - MEASURED AT THE BOTTOM.
 - MATERIAL CONTACT: PHOSPHORBRONZE
HOUSING: CREAM WHITE GLASS FILLED POLYESTER UL-94V0
 - CONNECTOR PRINTED WITH P/N AND DATE CODE.
 - FOR ACTUAL CONTACT LOADINGS, SEE LOADING PATTERN MATING SIDE.
 - SHAPE OF CONNECTOR HOUSING CAN ALTER DEPENDING ON PRODUCTION LOCATION
 - THE PRODUCT (LF) MEETS EUROPEAN UNION DIRECTIVES AND OTHER COUNTRY REGULATIONS AS DESCRIBED IN GS-22-008
 - FOR RECOMMENDED PTH DIMENSIONS REFER DRAWING : BS, A , 201572 , 001
- CATALOG NO: HM2P66PNE364----

mat'l. code		SEE NOTE 4		surface	tolerance	projection	product family
		ISO 1302	ISO 406	ISO 1101	ISO 1101	MM	MILLIPACS
tr	ecn no	dr	date	tolerances unless otherwise specified	linear	MM	title
A	104-0035	MNI	2004/05/12	0°±1°	0±0.2	MM	MPACS 5+2R STR HDR PF CONN TYPE AB 22 POS.
B	105-0188	MNI	2005/10/13	0°±1°	0.0±0.1	MM	
C	106-0090	MNI	2006/06/23	0°±1°	0.0±0.1	MM	
sheet index		revision sheet	C	1			type Product Customer Drawing