

## Excellent Integrated System Limited

Stocking Distributor

Click to view price, real time Inventory, Delivery & Lifecycle Information:

[FCI](#)  
[HM2P67PMA3T4GF](#)

For any questions, you can email us directly:  
[sales@integrated-circuit.com](mailto:sales@integrated-circuit.com)

**LOADING PATTERN MATING SIDE**

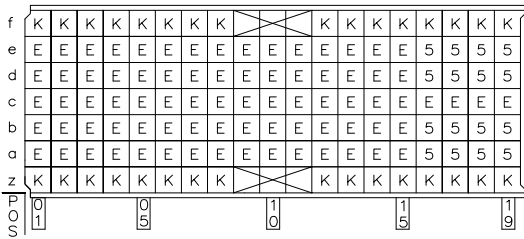

**LOADED CONNECTOR ASSEMBLY (FOR EXAMPLE)**

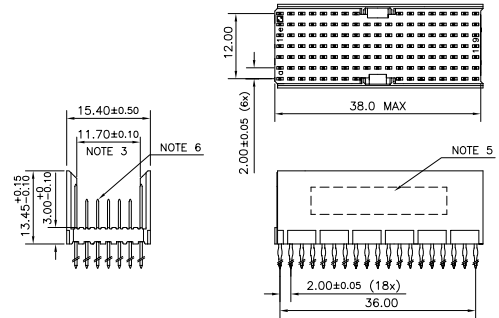

**CONTACT OVERVIEW**

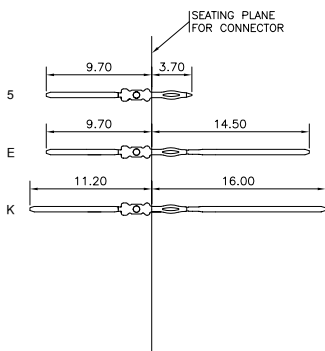

**LAY-OUT P.C.B.-HOLE**

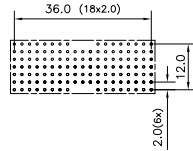

**HM2P67PMA3T4** LF55  
 LEAD FREE INDICATOR : LF = LEAD FREE (DIGIT 15 & 16)  
 PLATING CODE (DIGIT 13 AND 14) (REF DRW NO. BS.C , 201844 , 003)

**NOTES**

- THIS PRODUCT IS CSA APPROVED.
- THIS PRODUCT IS UL RECOGNIZED.
- MEASURED AT THE BOTTOM.
- MATERIAL CONTACT: PHOSPHORBRONZE  
HOUSING: CREAM WHITE GLASS FILLED POLYESTER UL-94V0
- CONNECTOR PRINTED WITH P/N AND DATE CODE.
- FOR ACTUAL CONTACT LOADINGS, SEE LOADING PATTERN MATING SIDE.
- SHAPE OF CONNECTOR HOUSING CAN ALTER DEPENDING ON PRODUCTION LOCATION
- THE PRODUCT (LF) MEETS EUROPEAN UNION DIRECTIVES AND OTHER COUNTRY REGULATIONS AS DESCRIBED IN GS-22-008
- FOR RECOMMENDED PTH DIMENSIONS REFER DRAWING : BS, A , 201572 , 001
- CATALOG NO: HM2P67PMA3T4----

mat'l. code	SEE NOTE 4	surface	ISO 1302	tolerance	ISO 406 ISO 1101	projection	product family	MILLIPACS	
ltr	ecn no	dr	date	tolerances unless otherwise specified		MM	title		
A	104-0019	MNI	2004/03/15	angles	0±0.2	FCI	MPACS 5+2R STR HDR PF CONN TYPE AB 19 POS.		
B	105-0187	MNI	2005/10/13	linear	00±0.1		dwg no		
C	106-0090	MNI	2006/06/26	dr	0°±1"		sheet 1 of 1		
		enr		dr	MINI K VANDANATH	2004/03/15	BS, C , 203028, 118		
		chr		enr	BIJU K PAUL	2004/03/15	A3		
		appd		chr	BIJU K PAUL	2006/06/26	type Product Customer Drawing		
sheet index	revision sheet	C	1						