

Excellent Integrated System Limited

Stocking Distributor

Click to view price, real time Inventory, Delivery & Lifecycle Information:

[FCI](#)
[HM2PN2PNF3U5GF](#)

For any questions, you can email us directly:
sales@integrated-circuit.com

LOADING PATTERN MATING SIDE

f	K	K	K	K	K	K	K	K	K	K	K	K	K	K	K	K	K	K	K	K
e	K	E	E	E	E	E	E	K	E	E	E	E	E	E	E	K	E	E	E	E
d	K	E	E	E	E	E	E	K	E	E	E	E	E	E	E	K	E	E	E	E
c	K	E	E	E	E	E	E	K	E	E	E	E	E	E	E	K	E	E	E	E
b	K	E	E	E	E	E	E	K	E	E	E	E	E	E	E	K	E	E	E	E
a	K	E	E	E	E	E	E	K	E	E	E	E	E	E	E	K	E	E	E	E
z	0	0	0	0	0	0	0	0	0	0	0	0	0	0	0	0	0	0	0	0
P	0	0	1	1	2	2														
O	1	5	0	5	0	5														
S																				

LOADED CONNECTOR ASSEMBLY (FOR EXAMPLE)

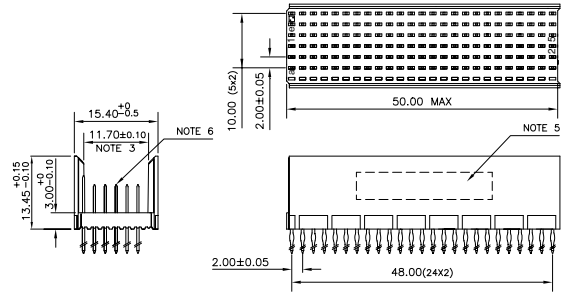

CONTACT OVERVIEW

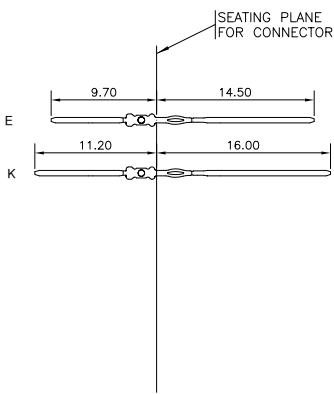

LAY-OUT P.C.B.-HOLE

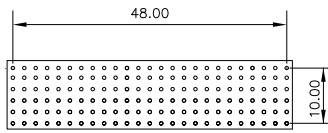

LEAD FREE INDICATOR : LF = LEAD FREE (DIGIT 15 & 16)

HM2PN2PNF3U5GF

PLATING CODE (DIGIT 13 AND 14)
(REF DRW NO. BS, C , 201844 , 003)

NOTES

1. THIS PRODUCT IS CSA APPROVED.
 2. THIS PRODUCT IS UL RECOGNIZED.
 3. MEASURED AT THE BOTTOM.
 4. MATERIAL CONTACT: PHOSPHORBRONZE
HOUSING: CREAM WHITE GLASS FILLED POLYESTER UL-94V0
 5. CONNECTOR PRINTED WITH P/N AND DATE CODE.
 6. FOR ACTUAL CONTACT LOADINGS, SEE LOADING PATTERN MATING SIDE.
 7. SHAPE OF CONNECTOR HOUSING CAN ALTER DEPENDING ON PRODUCTION LOCATION
 8. THIS PRODUCT (LF) MEETS EUROPEAN UNION DIRECTIVES AND OTHER COUNTRY REGULATIONS AS DESCRIBED IN GS-22-008
 9. FOR RECOMMENDED PTH DIMENSIONS REFER DRAWING : BS, A , 201572 , 001
- PART NO: HM2PN2PNF3U5-----

mat'l. code	SEE NOTE 4		surface	ISO 1302	tolerance	ISO 406 ISO 1101	projection	product family			MILLIPACS	
ltr	ecn no	dr	date	tolerances unless otherwise specified					title			
A	05-0139	MNI	2005/08/10	angles	linear	0.02	MM		MPACS 5*2R STR HDR PF CONN TYPE B			
B	06-0099	MNI	2006/07/07	0°±1°		00:01			(WIDTH = 15.4 MAX)			
				dr	MNI K. VANDANATH	2005/03/08	scale		dwg no		sheet 1 of 1	
				enr	BUJU K. PAUL	2005/03/08	FCI		203028,227		A3	
				chr	BUJU K. PAUL	2006/07/07			type		Product Customer Drawing	
				appd	BUJU K. PAUL	2006/07/07						
sheet index	revision sheet		B									
	1											