



Distributor of ASSMANN WSW Components: Excellent Integrated System Limited
Datasheet of A-DVI-1006-1-01-R - Connector Receptacle DVI-D, Dual Link 24 Position
Through Hole, Right Angle, Horizontal

Contact us: sales@integrated-circuit.com Website: www.integrated-circuit.com

Excellent Integrated System Limited

Stocking Distributor

Click to view price, real time Inventory, Delivery & Lifecycle Information:

[ASSMANN WSW Components](#)
[A-DVI-1006-1-01-R](#)

For any questions, you can email us directly:
sales@integrated-circuit.com

Contact us: sales@integrated-circuit.com Website: www.integrated-circuit.com

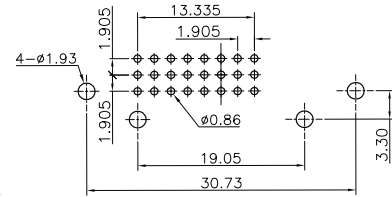
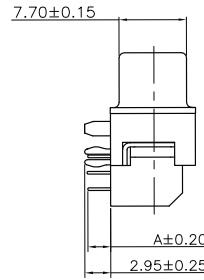
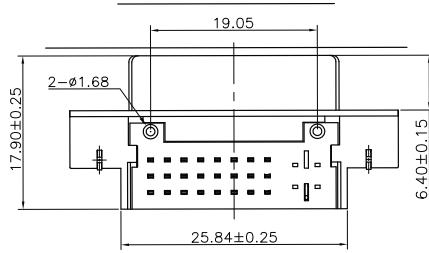
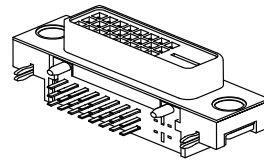
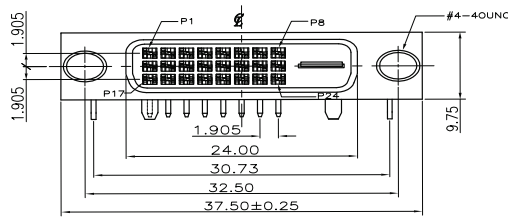

Recommended PCB Layout

Specifications	
Material:	Contacts: Brass Shell: Zinc Alloy Ground Contact: Brass Leg: Brass Rivet: Brass
Electrical:	Current rating [amps]: 1.5A Voltage-max [volts]: 40V Withstanding Voltage: 500V AC Contact Resistance [ohms]: 30MΩ Max. Insulation Resistance [ohms]: 1,000MΩ Min.
Plating:	Contacts: Gold plating over nickel
Environmental	Temperature Range: -20°C to +80°C

MODIFICATIONS	DATE	NAME	Dimension = MM			Item NO.		
			TOLERANCE	ANGLE		DATE	DESCRIPTION	
			X.X	±0.15	DRAWN BY Miller	6-6-12	DVI Connector Right Angle - 24+1 DIP 90°, Female, White Insulator, No Nut	
			X.XX		APPROVED BY Warner		DRAWING NO.	REV
			X.XXX					

1 2 3 4 5 6 7