

Excellent Integrated System Limited

Stocking Distributor

Click to view price, real time Inventory, Delivery & Lifecycle Information:

[Harting](#)

[09022646841](tel:09022646841)

For any questions, you can email us directly:

sales@integrated-circuit.com

Alle Rechte vorbehalten. All rights reserved.

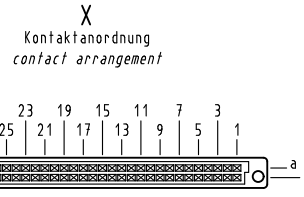
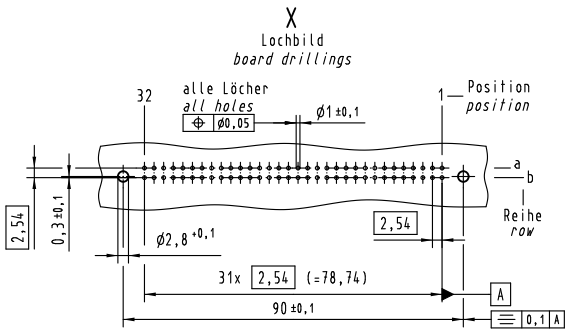

64 Einlötl Kontakte
64 solder contacts

- ☒ = Kontaktposition belegt
= position with contact
- ☐ = Kontaktposition nicht belegt
= position without contact

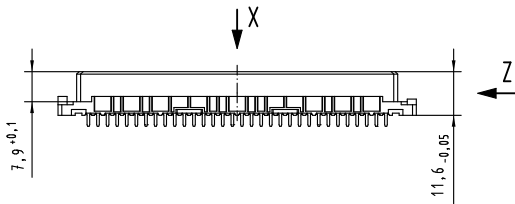

Z (2:1)

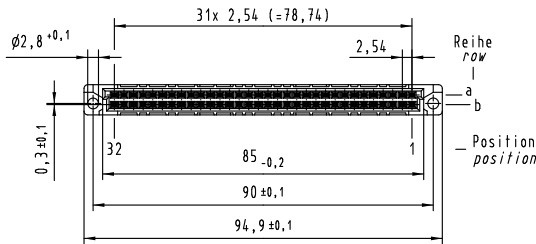
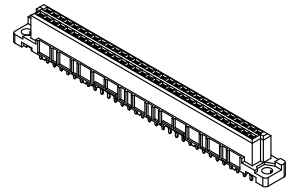
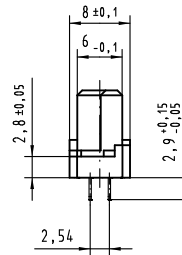

① weitere Informationen siehe: DS 09 03 213 02 01
further information see: DS 09 03 213 02 01

All Dimensions in mm Original Size DIN A 3		Techn. Character.		Nicht tolerierte Maß/Free size tolerances IEC 60603-2	
		Bel.	Name	Maßstab/Scale	
		Detail.	28.08.09 Bus.	1:1	
		Insp.	28.08.09 TD		
36468	06.01.12	Hage.	Stand.		
36412	13.07.11	Hage.			
35568					
Mod.	Dat.	Name	HARTING Electronics GmbH & Co. KG D-32339 ESPELKAMP		
				Bauform / type B Federleiste Einlötl 2,9 16-polig, SMC female connector solder 2.9 64-pole, SMC	
				TB 09 02 264 x841 Blatt/page Sub.	

09 02 264 6841	2
Bestell-Nr. part-no.	Anforderungsstufe performance level ①