

## Excellent Integrated System Limited

Stocking Distributor

Click to view price, real time Inventory, Delivery & Lifecycle Information:

[Harting](#)  
[09060009541](#)

For any questions, you can email us directly:  
[sales@integrated-circuit.com](mailto:sales@integrated-circuit.com)

Alle Rechte vorbehalten. All rights reserved.

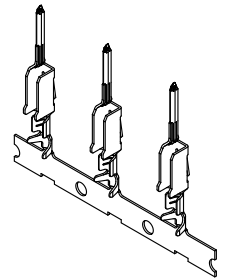
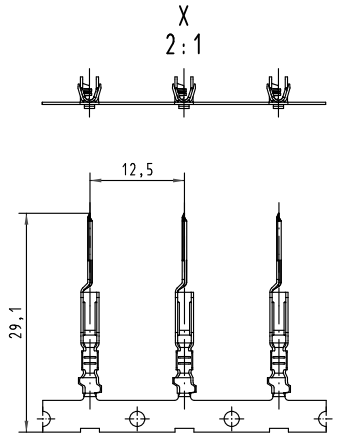
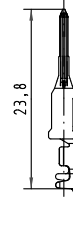
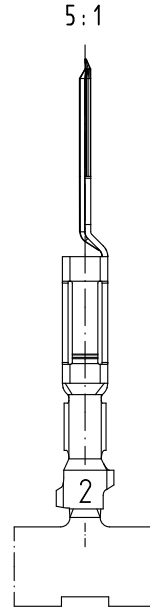
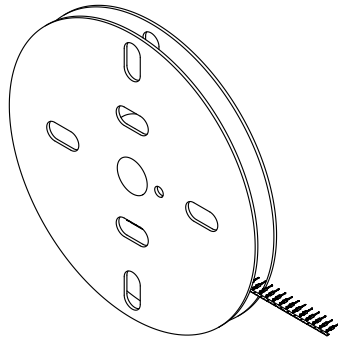
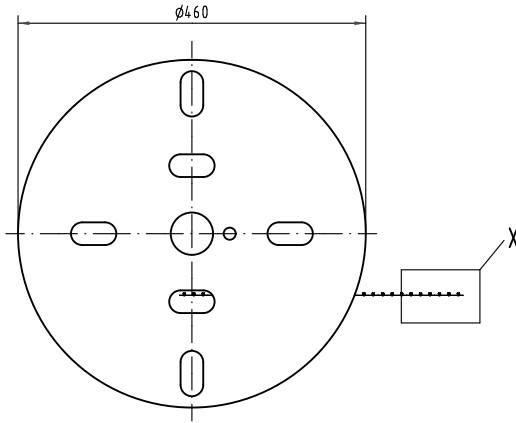
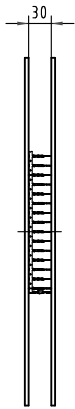

		Techn. Character.		Nicht tolerierte Maß/Free size tolerances complementary IEC 60603-2	
		Del.	Name	Maßstab/Scale	Bauformtype <b>F-C crimp</b> Messerkontakt Crimpkontakt 2 für 0,14 - 0,56mm <sup>2</sup> 2500 Kontakte auf Haspel 41s. 1 male contact crimp contour 2 for 0,14 - 0,56mm <sup>2</sup> 2500 contacts on reel pl. 1
		Detail: 16.01.06	Leh.	1:5	
		Insp. 16.01.06	kFoe	2:1; 5:1	
		Stand.			
35449	21.11.08	Hage.	HARTING Electronics GmbH & Co. KG		TB 09 06 000 9541
33227			D-32339 ESPELKAMP		
Mod.	Dat.	Name			
					Blatt/page Sub.