



**Distributor of Harting: Excellent Integrated System Limited**

Datasheet of 09642247210 - D-Sub Connector Plug, Male Pins 15 Position Through Hole, Right Angle Solder

Contact us: [sales@integrated-circuit.com](mailto:sales@integrated-circuit.com) Website: [www.integrated-circuit.com](http://www.integrated-circuit.com)

---

## **Excellent Integrated System Limited**

Stocking Distributor

Click to view price, real time Inventory, Delivery & Lifecycle Information:

[Harting](#)

[09642247210](#)

For any questions, you can email us directly:

[sales@integrated-circuit.com](mailto:sales@integrated-circuit.com)

Contact us: [sales@integrated-circuit.com](mailto:sales@integrated-circuit.com) Website: [www.integrated-circuit.com](http://www.integrated-circuit.com)

**SPECIFICATION**

Mating Cycles	500
Filter type	C
Capacitance	47pF±20%
Working Voltage	100v
Current Rating	7,5A
Insulation Resistance	>1GΩ

FREQUENCY (MHz)	ATTENUATION dB
5	-
10	-
50	-
100	-
500	30dB
1000	35dB

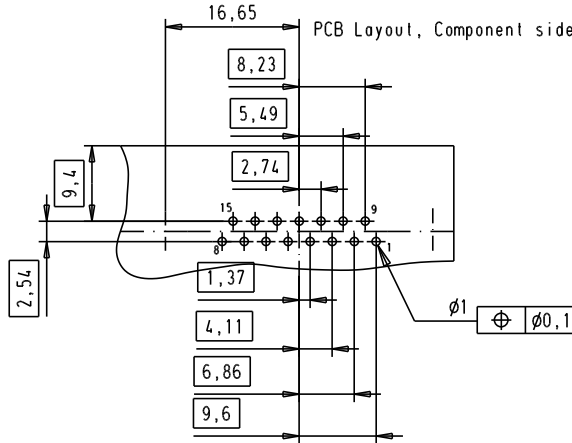
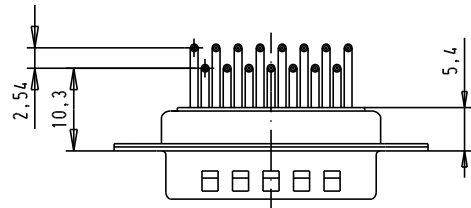
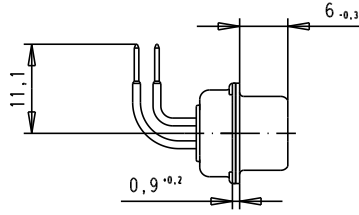
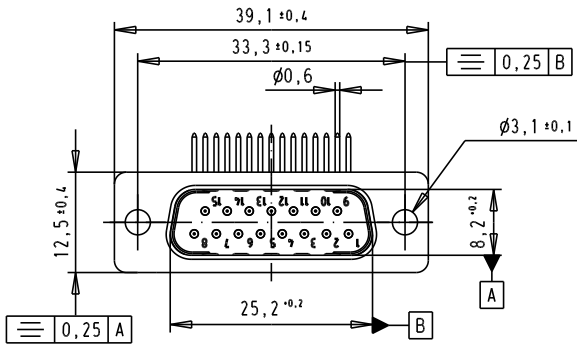

				Det.	Name	 All Dim. in mm Orig. Size DIN A 4	D-Sub, male, angled, 15 Poles, turned solder pins, tin plated shell with dimples and holes	Mo?/Lab/ Scale 1.5:1
				8- JUL -02	CV			
33269	22/11/05	JMDR				 Sub.	<b>TB 09642247210</b>	Blatt/ Page 1 / 1
31058	8- JUL -02	CV						
Mod.	Det.	Name						

HARTING EURL  
F-95972 Paris