



Distributor of Harting: Excellent Integrated System Limited

Datasheet of 09642247240 - D-Sub Connector Plug, Male Pins 15 Position Through Hole, Right Angle Solder

Contact us: sales@integrated-circuit.com Website: www.integrated-circuit.com

Excellent Integrated System Limited

Stocking Distributor

Click to view price, real time Inventory, Delivery & Lifecycle Information:

[Harting](#)

[09642247240](#)

For any questions, you can email us directly:

sales@integrated-circuit.com

Contact us: sales@integrated-circuit.com Website: www.integrated-circuit.com

D
C
B
A

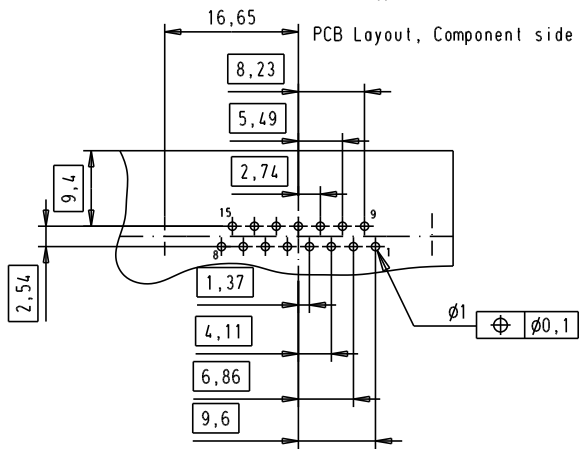
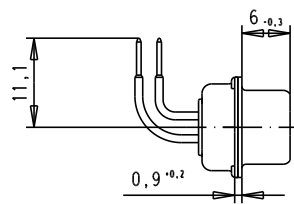
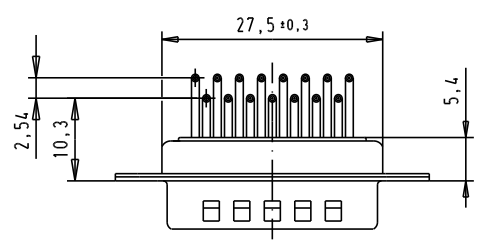
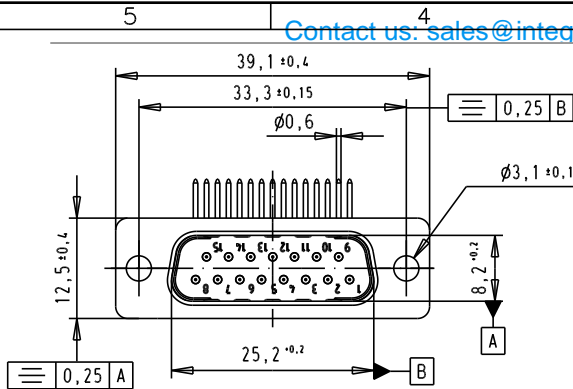

SPECIFICATION

Mating Cycles	500
Filter type	C
Capacitance	3900pf±20%
Working Voltage	100v
Current Rating	7.5A
Insulation Resistance	>1GΩ

FREQUENCY (MHz)	ATTENUATION dB
5	6dB
10	11dB
50	25dB
100	35dB
500	35dB
1000	32dB

				Detail.	8-JUL-02	CV	 All Dim. in mm Orig. Size DIN A 4	D-Sub, male, angled, 15 Poles, turned solder pins, tin plated shell with dimples and holes	Mod./Tab/ Scale 1.5:1
			Insp.						
			Stand.						
33271	24/11/05	JMDR	HARTING EURL			 F-95972 Paris	TB 09642247240	Blatt/ Page 1 / 1	
31058	8-JUL-02	CV	Mod.	Detl.	Name				Sub.