



Distributor of Harting: Excellent Integrated System Limited

Datasheet of 09661576613 - D-Sub Connector Receptacle, Female Sockets 9 Position
Through Hole, Right Angle Solder

Contact us: sales@integrated-circuit.com Website: www.integrated-circuit.com

Excellent Integrated System Limited

Stocking Distributor

Click to view price, real time Inventory, Delivery & Lifecycle Information:

[Harting](#)

[09661576613](#)

For any questions, you can email us directly:

sales@integrated-circuit.com

Mating face according to : MIL-C-24308 / DIN 41652 / CECC 75301-802

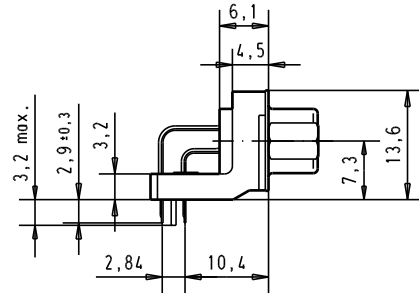
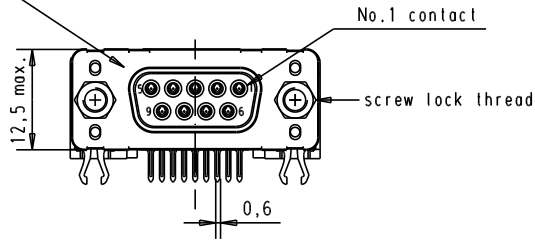

Printed board layout component side

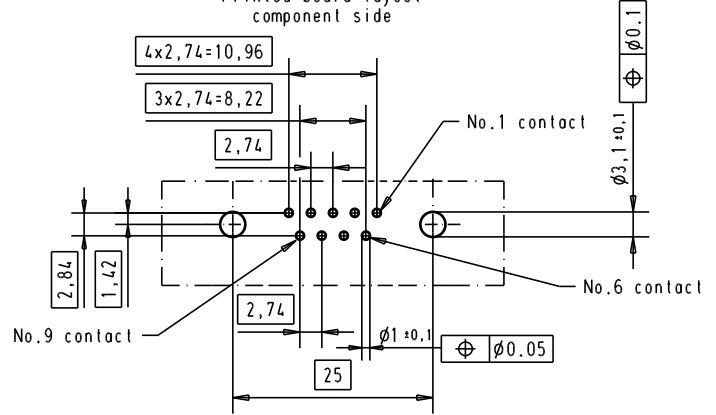
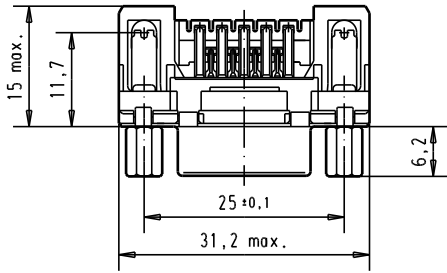

Connector retention and insertion forces on the PCB = 25 / 80 newtons

09 66 157 3633	M3	1				Det.	Name	 All Dim. in mm Orig. Size DIN A 4	D-Sub, high temperature, female, standard, 9 poles, with solder pins 2,9 mm, screw lock and grounding board lock.	Maßstab/ Scale 1.5:1
09 66 157 6633	M3	2			Detail.	04/09/02	YT			
09 66 157 7633	M3	3			Insp.				TB 0966157x6x3	Blatt/ Page 1 /
09 66 157 3613	4-40 UNC	1			Stand.					
09 66 157 6613	4-40 UNC	2	31892	05/05/04	JH	HARTING EURL		Sub.	F-95972 Paris	1 /
09 66 157 7613	4-40 UNC	3	31084	04/09/02	YT					
Part number	Screw lock thread	Performance level	Mod.	Det.	Name					