

Excellent Integrated System Limited

Stocking Distributor

Click to view price, real time Inventory, Delivery & Lifecycle Information:

[Molex Connector Corporation](#)
[0365020001](#)

For any questions, you can email us directly:

sales@integrated-circuit.com

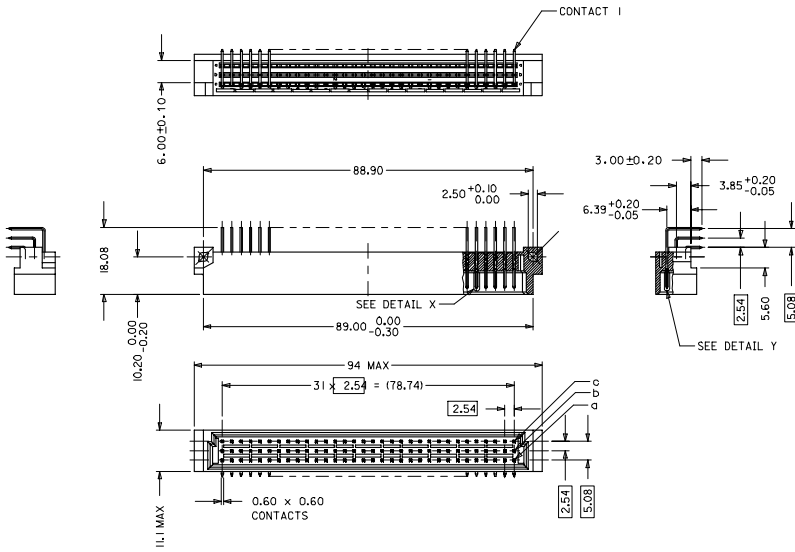

RECOMMENDED PCB LAYOUT
COMPONENT SIDE

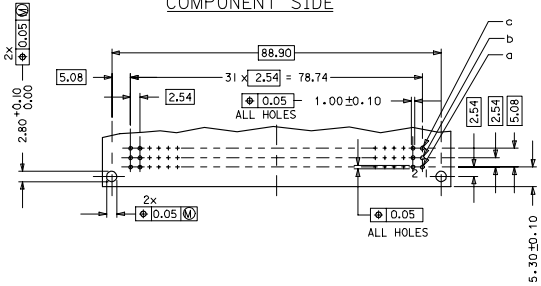

WITH MOUNTING CLIPS

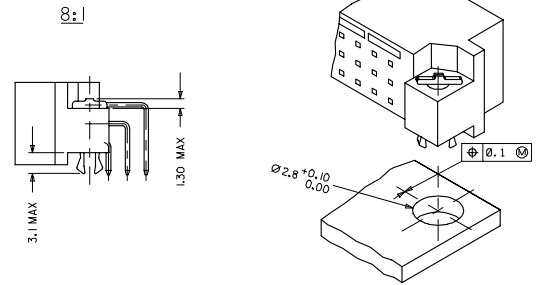

- NOTES:
- MATERIALS: THERMOPLASTIC POLYESTER, GLASS FILLED, UL94V-0, COLOUR: PEBBLE GREY RAL 7032
TERMINAL - BRASS
MOUNTING CLIP: STEEL
 - FINISH: TERMINAL:-
CONTACT AREA
1. PERFORMANCE LEVEL 1: SELECTIVE GOLD (Au), THICKNESS = 1.1 MICROMETER OVER NICKEL, THICKNESS = 1.25 MICROMETER
2. PERFORMANCE LEVEL 2: SELECTIVE GOLD (Au), THICKNESS = 0.6 MICROMETER OVER NICKEL, THICKNESS = 1.25 MICROMETER
3. PERFORMANCE LEVEL 3: SELECTIVE GOLD (Au), THICKNESS = 0.3 MICROMETER OVER NICKEL, THICKNESS = 1.25 MICROMETER
TERMINATION AREA:
SELECTIVE TIN, THICKNESS = 2.5 MICROMETER
OVER NICKEL, THICKNESS = 1.25 MICROMETER OVERALL
 - MOUNTING CLIP:-
TIN (Sn), THICKNESS = 5-10 MICROMETER,
OVER NICKEL (Ni), THICKNESS = 2.5 MICROMETER
 - FOR NON MOUNTING CLIP OPTION, CONNECTOR TO BE SECURED WITH RIVETS: 2 TUBULAR RIVETS 2.5 x 0.3 ... DIN 7340
SCREWS: 2 CHEESEHEAD SCREWS M2.5 x ... DIN 84 AND 2 HEXAGONAL NUTS M2.5 DIN 934
 - MATERIAL NUMBER, BATCH CODE, UL AND CSA MARKING TO BE PRINTED ON THE CONNECTOR
 - CUT FACE OF TIP WITHOUT PLATING PERMITTED
 - PRODUCT SPECIFICATION : PS-36502-001

RoHS COMPLIANT

EC NO: 02007-0044 2006/10/10 DRWSATT/INRAD C1 APPROVED FOR DATE: 2008/10/08	QUALITY SYMBOLS	GENERAL TOLERANCES (UNLESS SPECIFIED)	DIMENSION STYLE MM ONLY DATE: 1999/10/01	SCALE 2:1 DESIGN UNITS METRIC THIRD ANGLE PROJECTION	ASSEMBLY, DIN 41612 C MALE 96 POS MOLEX INCORPORATED MATERIAL NO: SEE CHART DOCUMENT NO: SD-36502-001 SHEET NO: 1 OF 2
	▽=0	4 PLACES ± --- ± ---	DRAWN BY: SS DATE: 1999/10/01 CHECKED BY: GJL/DWE DATE: 1999/10/01	MOLEX INCORPORATED	
	▽=0	3 PLACES ±0.05 ± ---	APPROVED BY: GJL/DWE		
	▽=0	2 PLACES ±0.1 ± ---	DATE: 1999/10/01		
	▽=0	1 PLACE ±0.15 ± ---	ANGULAR ± 2 °		
	DRAFT WHERE APPLICABLE MUST REMAIN WITHIN DIMENSIONS	SEE CHART			

MATERIAL No	MOLEX ENG No	PERF LEVEL	PLATING	CONTACT SEQUENCE/ROW	PREMATING CONTACT POS.	MOUNTING CLIP
36502-0001	MM-B1400-C960	1	Au+Ni	1,2,3....32 a+b+c	NO	NO
36502-0002	MM-B1500-C960	2	Au+Ni	1,2,3....32 a+b+c	NO	NO
36502-0003	MM-B1600-C960	3	Au+Ni	1,2,3....32 a+b+c	NO	NO
36502-0007	MM-B1400-C910	1	Au+Ni	1,2,3....32 a+b+c	NO	YES
36502-0008	MM-B1500-C910	2	Au+Ni	1,2,3....32 a+b+c	NO	YES
36502-0009	MM-B1600-C910	3	Au+Ni	1,2,3....32 a+b+c	NO	YES
36502-0013	MM-B1400-C930	1	Au+Ni	1,2,3....32 a+b+c	1,32a 1,32b 1,32c	NO
36502-0014	MM-B1500-C930	2	Au+Ni	1,2,3....32 a+b+c	1,32a 1,32b 1,32c	NO
36502-0015	MM-B1600-C930	3	Au+Ni	1,2,3....32 a+b+c	1,32a 1,32b 1,32c	NO
36502-0019	MM-B1400-C950	1	Au+Ni	1,2,3....32 a+b+c	1,32a 1,32b 1,32c	YES
36502-0020	MM-B1500-C950	2	Au+Ni	1,2,3....32 a+b+c	1,32a 1,32b 1,32c	YES
36502-0021	MM-B1600-C950	3	Au+Ni	1,2,3....32 a+b+c	1,32a 1,32b 1,32c	YES

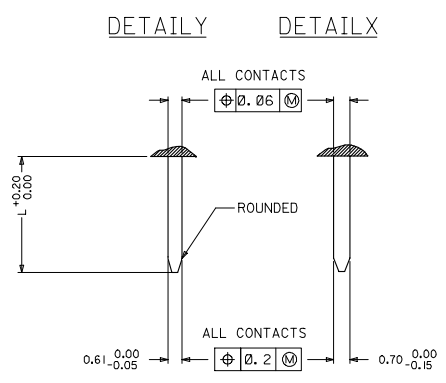

PRE MATING CONTACTS	5.4
NORMAL CONTACTS	4.8
	L

RoHS COMPLIANT

EC NO: 02007-0044 2006/10/16 2006/10/16 2006/10/16 APPROVED BY: [Signature] DATE: 2006/10/16	QUALITY SYMBOLS	GENERAL TOLERANCES (UNLESS SPECIFIED)	DIMENSION STYLE: MM ONLY SCALE: 2:1 DESIGN UNITS: METRIC THIRD ANGLE PROJECTION																		
	$\nabla=0$ $\nabla=0.1$	<table border="1"> <tr> <th></th> <th>mm</th> <th>INCH</th> </tr> <tr> <td>4 PLACES</td> <td>±0.05</td> <td>±0.002</td> </tr> <tr> <td>3 PLACES</td> <td>±0.05</td> <td>±0.002</td> </tr> <tr> <td>2 PLACES</td> <td>±0.1</td> <td>±0.004</td> </tr> <tr> <td>1 PLACE</td> <td>±0.15</td> <td>±0.006</td> </tr> <tr> <td colspan="3">ANGULAR ± 2°</td> </tr> </table>		mm	INCH	4 PLACES	±0.05	±0.002	3 PLACES	±0.05	±0.002	2 PLACES	±0.1	±0.004	1 PLACE	±0.15	±0.006	ANGULAR ± 2°			DRAWN BY: SS DATE: 1999/09/01 CHECKED BY: GJLJWE DATE: 1999/09/01 APPROVED BY: GJLJWE DATE: 1999/09/01
		mm	INCH																		
	4 PLACES	±0.05	±0.002																		
3 PLACES	±0.05	±0.002																			
2 PLACES	±0.1	±0.004																			
1 PLACE	±0.15	±0.006																			
ANGULAR ± 2°																					
DRAFT WHERE APPLICABLE MUST REMAIN WITHIN DIMENSIONS	SEE CHART	MATERIAL NO: SD-36502-001 DOCUMENT NO: MOLEX INCORPORATED																			
		THIS DRAWING CONTAINS INFORMATION THAT IS PROPRIETARY TO MOLEX INCORPORATED AND SHOULD NOT BE USED WITHOUT WRITTEN PERMISSION																			