

## Excellent Integrated System Limited

Stocking Distributor

Click to view price, real time Inventory, Delivery & Lifecycle Information:

[Bel Fuse Inc.](#)  
[135-3433-001](#)

For any questions, you can email us directly:  
[sales@integrated-circuit.com](mailto:sales@integrated-circuit.com)

PART NUMBER	ITEM ①	ITEM ②	ITEM ③	ITEM ④	ITEM ⑤
135-3433-001	BRASS GOLD PL .00001 MIN OVER NICKEL PL .00005 MIN OVER COPPER PL .00005 MIN	CONTACT BERYLLIUM COPPER GOLD PL .00003 MIN OVER NICKEL PL .00005 MIN OVER COPPER PL .00005 MIN	INTERFACE SPRING BERYLLIUM COPPER GOLD PL .00003 MIN OVER NICKEL PL .00005 MIN OVER COPPER PL .00005 MIN	INSULATOR TEFLON	CRIMP SLEEVE COPPER GOLD PL .00001 MIN OVER NICKEL PL .00005 MIN OVER COPPER PL .00005 MIN

DRAWING NO. C - 135-3433-001/010	
0 REVISIONS	
ENGINEERING RELEASE	
1	B-31-97 R H B A 9-4-97 ECN 44854
VERSION UPDATE	
2	11-6-97 R H B A ECN 45071
VERSION UPDATE	
* REVISION NUMBER FOLLOWED BY AN ALPHA *	
* CHARACTER INDICATED DRAWING CHANGE *	
* CAUTION OR PART NUMBER ADDITION ONLY. *	
2d	1-21-00 R H B A ECN 46B3B

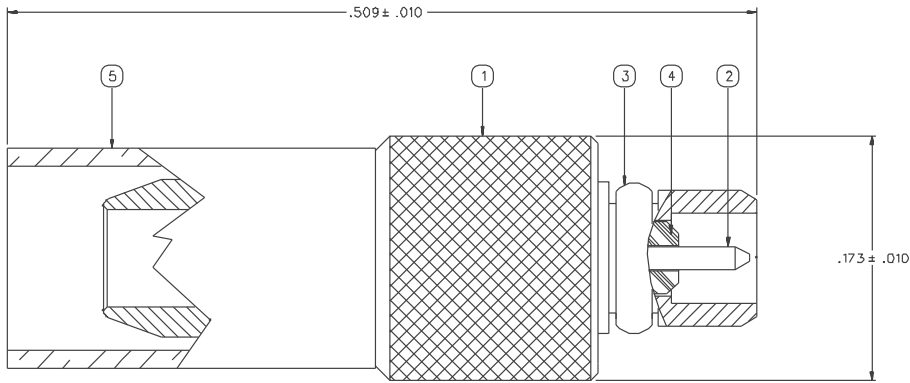

NOTES:

1. SPECIFICATIONS:

IMPEDANCE: 50 OHMS  
 FREQUENCY RANGE: 0-6 GHz  
 VSWR: NOT APPLICABLE  
 WORKING VOLTAGE: 170 VRMS MAX AT SEA LEVEL  
 DIELECTRIC WITHSTANDING VOLTAGE: 500 VRMS MIN AT SEA LEVEL  
 INSULATION RESISTANCE: 1000 MEGOHM MIN  
 CONTACT RESISTANCE:  
 CENTER CONTACT - INITIAL 5.0 MILLIOHM MAX, AFTER ENVIRONMENTAL 8.0 MILLIOHM MAX  
 OUTER CONDUCTOR - INITIAL 1 MILLIOHM MAX, AFTER ENVIRONMENTAL 15 MILLIOHM MAX  
 BODY TO BRAID - INITIAL 15 MILLIOHM MAX, AFTER ENVIRONMENTAL NOT APPLICABLE  
 CORONA LEVEL: 190 VOLTS MINIMUM AT 70,000 FEET  
 INSERTION LOSS: NOT APPLICABLE  
 RF LEAKAGE: NOT APPLICABLE  
 RF HIGH POTENTIAL WITHSTANDING VOLTAGE: 400 VRMS AT 4 AND 7 MHZ

MECHANICAL:

ENGAGE/DISENGAGE FORCE: 8.0 LBS MAX ENGAGEMENT  
 1.4 LBS MIN DISENGAGEMENT  
 CONTACT RETENTION FORCE: 2.0 LBS MIN AXIAL FORCE  
 CONTACT RETENTION TORQUE: NOT APPLICABLE  
 COUPLING MECHANISM RETENTION: NOT APPLICABLE  
 CABLE ACCEPTABILITY: RG 179/U, RG 187/U  
 CABLE HEX CRIMP SIZE: .128 HEX  
 CABLE RETENTION: 20 LBS  
 DURABILITY: 500 CYCLES MIN

ENVIRONMENTAL:

(MEETS OR EXCEEDS THE APPLICABLE PARAGRAPH OF MIL-C-39012)  
 THERMAL SHOCK: MIL-STD-202, METHOD 107, CONDITION C, EXCEPT -55 DEG C TO 155 DEG C  
 OPERATING TEMPERATURE: -55 DEG C TO 155 DEG C  
 CORROSION: MIL-STD-202, METHOD 101, CONDITION B  
 SHOCK: MIL-STD-202, METHOD 213, CONDITION B  
 VIBRATION: MIL-STD-202, METHOD 204, CONDITION D  
 MOISTURE: MIL-STD-202, METHOD 106

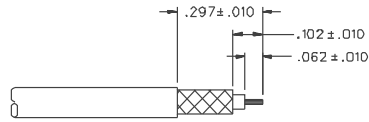

CABLE STRIP DIMENSIONS  
4:1

CUSTOMER DRAWING  
 THIS DRAWING TO BE INTERPRETED PER ANSI Y 14.5M - 1982  
 "μSTATION"  
 COMPANY CONFIDENTIAL

<table border="1"> <tr> <th>DEONALS</th> <th>mm</th> </tr> <tr> <td>.XX</td> <td></td> </tr> <tr> <td>.XXX</td> <td>.003</td> </tr> </table>	DEONALS	mm	.XX		.XXX	.003	<table border="1"> <tr> <th>APPROVED BY</th> <th>DATE</th> </tr> <tr> <td>TAK</td> <td>5-21-97</td> </tr> <tr> <td>TAK</td> <td>9-2-97</td> </tr> <tr> <td>RJB</td> <td>9-3-97</td> </tr> </table>	APPROVED BY	DATE	TAK	5-21-97	TAK	9-2-97	RJB	9-3-97	<table border="1"> <tr> <th>DATE</th> <th>TITLE</th> </tr> <tr> <td>5-21-97</td> <td>PLUG ASSEMBLY STRAIGHT, RG 179 MMCX</td> </tr> <tr> <td>9-2-97</td> <td></td> </tr> <tr> <td>9-3-97</td> <td></td> </tr> </table>	DATE	TITLE	5-21-97	PLUG ASSEMBLY STRAIGHT, RG 179 MMCX	9-2-97		9-3-97		<table border="1"> <tr> <td colspan="2">JOHNSON C03 Connectivity Solutions 299 Johnson Ave. Ste. 100 Waukegan, IL 60087 1-800-347-8352</td> </tr> <tr> <td>CODE NO.</td> <td>DRAWING NO.</td> </tr> <tr> <td>C - 135-3433-001/010</td> <td>C - 135-3433-001/010</td> </tr> </table>	JOHNSON C03 Connectivity Solutions 299 Johnson Ave. Ste. 100 Waukegan, IL 60087 1-800-347-8352		CODE NO.	DRAWING NO.	C - 135-3433-001/010	C - 135-3433-001/010
DEONALS	mm																														
.XX																															
.XXX	.003																														
APPROVED BY	DATE																														
TAK	5-21-97																														
TAK	9-2-97																														
RJB	9-3-97																														
DATE	TITLE																														
5-21-97	PLUG ASSEMBLY STRAIGHT, RG 179 MMCX																														
9-2-97																															
9-3-97																															
JOHNSON C03 Connectivity Solutions 299 Johnson Ave. Ste. 100 Waukegan, IL 60087 1-800-347-8352																															
CODE NO.	DRAWING NO.																														
C - 135-3433-001/010	C - 135-3433-001/010																														
<table border="1"> <tr> <th>RELEASE DATE</th> <td>9-4-97</td> </tr> </table>	RELEASE DATE	9-4-97	<table border="1"> <tr> <td>SCALE 2D:1</td> <td>U/M INCH</td> <td>SHEET 2 OF 2</td> </tr> </table>	SCALE 2D:1	U/M INCH	SHEET 2 OF 2																									
RELEASE DATE	9-4-97																														
SCALE 2D:1	U/M INCH	SHEET 2 OF 2																													