

## Excellent Integrated System Limited

Stocking Distributor

Click to view price, real time Inventory, Delivery & Lifecycle Information:

[Bel Fuse Inc.](#)  
[131-3404-016](#)

For any questions, you can email us directly:  
[sales@integrated-circuit.com](mailto:sales@integrated-circuit.com)

ITEM - ①	ITEM - ②	ITEM - ③	ITEM - ④	ITEM - ⑤
PART NUMBER	BODY	CONTACT	INTERFACE	INSULATOR
131-3404-001	BRASS GOLD PL .00001 MIN OVER NICKEL PL .00005 MIN OVER COPPER PL .00005 MIN	BRASS GOLD PL .00003 MIN OVER NICKEL PL .00005 MIN OVER COPPER PL .00005 MIN	BERYLLIUM COPPER GOLD PL .00003 MIN OVER NICKEL PL .00005 MIN OVER COPPER PL .00005 MIN	TEFLON
131-3404-006	BRASS NICKEL PL .0001 MIN OVER COPPER PL .00005 MIN	BRASS GOLD PL .00003 MIN OVER NICKEL PL .00005 MIN OVER COPPER PL .00005 MIN	BERYLLIUM COPPER GOLD PL .00003 MIN OVER NICKEL PL .00005 MIN OVER COPPER PL .00005 MIN	TEFLON
131-3404-016	BRASS NICKEL PL .0001 MIN OVER COPPER PL .00005 MIN	BRASS GOLD PL .00003 MIN OVER NICKEL PL .00005 MIN OVER COPPER PL .00005 MIN	BERYLLIUM COPPER NICKEL PL .0001 MIN OVER COPPER PL .00005 MIN	TEFLON

DRAWING NO.	
C - 131-3404-001/020	
REVISIONS	
0	
ENGINEERING RELEASE	
1	6-4-92 R H I T A H 6-18-92 E C C O 41066
ADDED: P/N 131-3404-016	
2	11-20-92 R H I T A H 12-3-92 E C C O 41284
ADDED: (50 OHM CABLE ONLY) TO VSWR INSERTION LOSS AND RF LEAK SPECS AFTER ENVIRONMENTAL BRAID TO BODY, RC 179 DS AND RC 187 DS TO CABLE ACCEPTABILITY	
3	3-30-93 R H I T A H 4-14-93 E C C O 41754
UPDATED GRAPHICS	
4	11-3-94 R H I T A H 11-10-94 E C N 42768
ADDED: CONTACT CRIMP TOOL NOTE TO SPECS	
5	9-27-97 R H I T A H E C N 44967
VERSION UPDATE	
* REVISION NUMBER FOLLOWED BY AN ALPHA *	
* CHARACTER INDICATED DRAWING CLAMP *	
* CATION OR PART NUMBER ADDITION ONLY *	
5a	2-12-98 R H I T A H E C N 45218

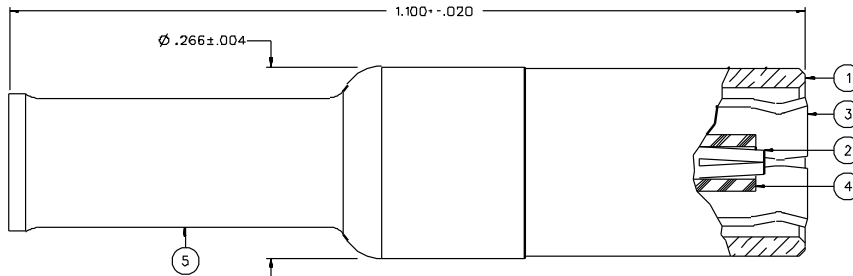

**NOTES:**

**1. SPECIFICATIONS:**

IMPEDANCE: 50 OHMS  
 FREQUENCY RANGE: 0-4 GHZ  
 VSWR: 1.25-.04 F (F IN GHZ) (50 OHM CABLE ONLY)  
 WORKING VOLTAGE: 335 VRMS MAX AT SEA LEVEL  
 DIELECTRIC WITHSTANDING VOLTAGE: 1000 VRMS MIN AT SEA LEVEL  
 INSULATION RESISTANCE: 1000 MEGOHM MIN  
 CONTACT RESISTANCE:  
 CENTER CONTACT - INITIAL 6 MILLIOHM MAX, AFTER ENVIRONMENTAL 8 MILLIOHM MAX  
 OUTER CONDUCTOR - GOLD PLATED INITIAL 1 MILLIOHM MAX, AFTER ENVIRONMENTAL 1.5 MILLIOHM MAX  
 NICKEL PLATED INITIAL 2.5 MILLIOHM MAX, AFTER ENVIRONMENTAL 3.5 MILLIOHM MAX  
 BRAID TO BODY - 1 MILLIOHM MAX (GOLD PLATED), AFTER ENVIRONMENTAL NOT APPLICABLE  
 2.5 MILLIOHM MAX (NICKEL PLATED), AFTER ENVIRONMENTAL NOT APPLICABLE  
 CORONA LEVEL: 250 VOLTS MIN AT 70,000 FEET  
 INSERTION LOSS: .30 DB MAX AT 1.5 GHZ (50 OHM CABLE ONLY)  
 RF LEAKAGE: -65 DB MIN AT 2.5 GHZ (50 OHM CABLE ONLY)  
 RF HIGH POTENTIAL WITHSTANDING VOLTAGE: 700 VRMS MIN AT 4 AND 7 MHZ  
 MECHANICAL:  
 ENGAGE/DISENGAGE FORCE: INITIAL 14 LBS MAX, AFTER DURABILITY 14 LBS MAX  
 ENGAGEMENT/2 LBS MIN DISENGAGEMENT  
 MATING TORQUE: NOT APPLICABLE  
 COUPLING PROOF TORQUE: NOT APPLICABLE  
 COUPLING NUT RETENTION: NOT APPLICABLE  
 CONTACT RETENTION: 4 LBS MIN AXIAL FORCE  
 CABLE ACCEPTABILITY: RC 316/U DOUBLE SHIELDED, RC 179 DOUBLE SHIELDED  
 RC 188/U DOUBLE SHIELDED, RC 187 DOUBLE SHIELDED  
 CABLE HEX CRIMP SIZE: .151  
 CONTACT CRIMP TOOL: JCI P/N 141-0000-911  
 CABLE RETENTION: 20 LBS MIN OR CABLE BREAKING STRENGTH  
 DURABILITY: 500 CYCLES MIN  
 ENVIRONMENTAL:  
 (MEETS OR EXCEEDS THE APPLICABLE PARAGRAPH OF MIL-C-39012)  
 THERMAL SHOCK: MIL-STD-202, METHOD 107, CONDITION B  
 OPERATING TEMPERATURE: -65 DEG C TO 165 DEG C  
 CORROSION: MIL-STD-202, METHOD 101, CONDITION B  
 SHOCK: MIL-STD-202, METHOD 213, CONDITION B  
 VIBRATION: MIL-STD-202, METHOD 204, CONDITION B

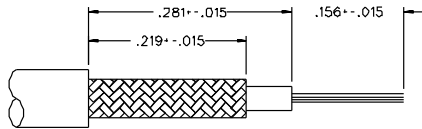

**CABLE STRIP DIMENSIONS**

**CUSTOMER DRAWING**  
 THIS DRAWING TO BE INTERPRETED  
 PER ANS Y 14.5M - 1982  
 "µSTATION"  
 COMPANY CONFIDENTIAL

TOLERANCE UNLESS OTHERWISE SPECIFIED	DRAWN BY	DATE	JOHNSON	
.XX	VET	4-8-92	Crush Connectivity Solutions 299 Johnson Ave. Ste. 100 Waukegan, IL 60087 1.800.247.8216	
.XXX	CHECKED BY	DATE	TITLE	
NATL	VET	6-15-92	PLUG ASSEMBLY STRAIGHT CABLED SMB, 50 OHM, RC 316 DS	
FINSH	APPROVED BY	DATE	CODE NO.	DRAWING NO.
	TAK/RJB	6-15-92		C - 131-3404-001/020
	RELEASE DATE	6-18-92	SCALE 10:1	U/M INCH SHEET 2 OF 2