

Excellent Integrated System Limited

Stocking Distributor

Click to view price, real time Inventory, Delivery & Lifecycle Information:

[Panduit](#)
[RAF5EI-E](#)

For any questions, you can email us directly:
sales@integrated-circuit.com



THIS COPY IS PROVIDED ON A RESTRICTED BASIS AND IS NOT TO BE USED IN ANY WAY DETRIMENTAL TO THE INTERESTS OF PANDUIT CORP.

△
B
△
C

PANDUIT P/N	WEIGHT
RAF5	1.20 LB/100 PCS. (540g/100 PCS.)

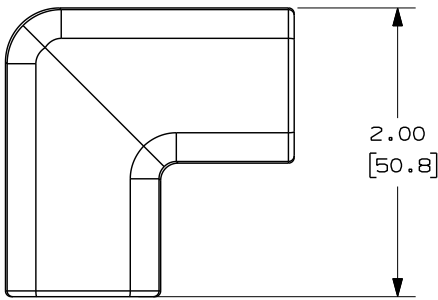

△
D

- NOTES:
- SEE CURRENT CATALOG FOR ADDITIONAL PART NUMBER SUFFIXES TO INDICATE COLOR AND OR PACKAGE QUANTITY.
 - DIMENSIONS IN PARENTHESIS ARE IN METRIC.

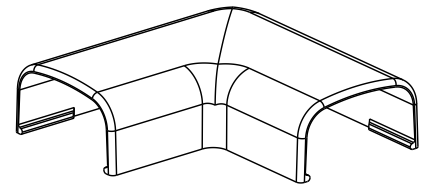
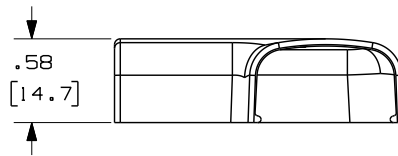
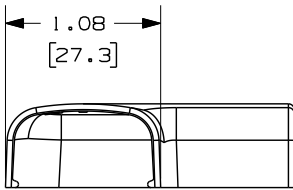

△
E

--	-----	--	--	RELEASED TO PRODUCTION	-----	--	--	CAD FILENAME/LAYERS	D34474BA_DC_RAF5/05A.prt						
7	5-30-08	BDK	RMHI	G. REVISED TO CURRENT CAD STANDARDS DRAWING # WAS SS-16865	34474-02	RTF1	RTF1	PANDUIT	CORP. TINLEY PARK, ILLINOIS						
6	7-8-02	JHNU	RMHI	F. REVISED MATERIAL IN DRAWING TITLE BLOCK.	16865	RGRO	RGRO			RIGHT ANGLE FITTING (RAF5) CUSTOMER DRAWING					
5	8-28-00	MSOH	HIW	E. REVISED AND REDRAWN ON CAD.	16865	HIW	HIW	UNLESS OTHERWISE SPECIFIED, DIMENSIONAL TOLERANCES ARE: (.X) ± (.XXX) ± (.XX) ± (.031.8) ANGLES ±							
4	10-3-91	DW	CF	D. REVISED NOTE AND REMOVED COLOR FROM DRAWING.	16865		CF	UNLESS OTHERWISE SPECIFIED, ALL DIMENSIONS ARE GIVEN IN INCHES, THIRD ANGLE PROJECTION.							
3	2-28-91	DW	CF	C. REVISED COLORS: OMIT BG, LI, LG. ADDED INT. WHITE AND INT. GRAY.	16865		WJB	DRAWN BY	KJS						
2	12-2-87	LDB	WJB	B. ADDED PART NUMBERS RAF5EI AND RAF5LI.	16865		WJB	DATE	9-9-81						
1	5-14-82	KJS	JK	A. POLYSTYRENE WAS ABS.			JAK	CHK'D	JK						
R	9-14-81	KJS	HP	DRAWING RELEASED			HP	MAT'L:	ABS △ △ △						
REV	DATE	BY	CHK	DESCRIPTION	ECN	-	R	CUST	SUP	SCALE	FULL	DRAWING NO.	34474-11	DWG SIZE	A