

Excellent Integrated System Limited

Stocking Distributor

Click to view price, real time Inventory, Delivery & Lifecycle Information:

[Molex Connector Corporation](#)
[1040921000](#)

For any questions, you can email us directly:

sales@integrated-circuit.com

10 9 8 7 6 5 4 3 2 1

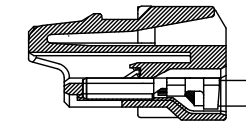
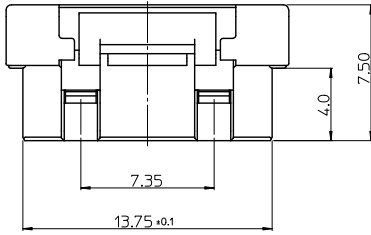

TERMINAL ASSEMBLY DRAWING
[REFERENCE]

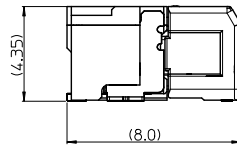
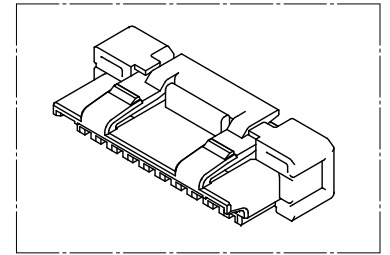

MATED WITH HEADER ASSEMBLY
[REFERENCE]

NOTES.

- MATED WITH : 104091-1020
- MATERIAL : LCP, VECTRA E471i
GLASS FILLED, UL 94V-0
HALOGEN FREE, NATURAL COLOR
- APPLICABLE TERMINAL : 104521-6001
- PRODUCT SPECIFICATION : PS-104091-001

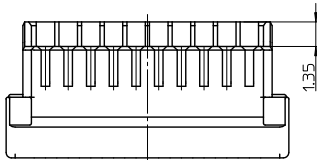
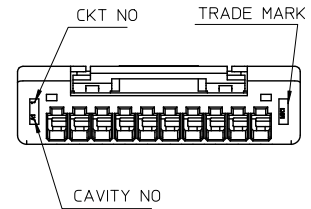
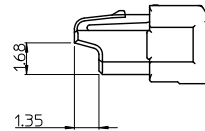
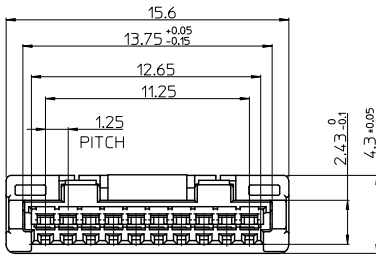

ORDER NO 104092-1000

RELEASED EC NO: KOR2012-0022 DRWN: JHPARK01 2011/09/22 CHKD: APPR: YUNSIKKIM 2011/09/30 REV: A	QUALITY SYMBOLS	GENERAL TOLERANCES (UNLESS SPECIFIED)	DIMENSION STYLE	SCALE	DESIGN UNITS	THIRD ANGLE PROJECTION	
	▽=0 ▽=0	4 PLACES ± --- ± --- 3 PLACES ± --- ± --- 2 PLACES ± 0.15 ± --- 1 PLACE ± 0.2 ± --- ANGULAR ± 1 °	MM ONLY	5:1	METRIC		
			DRAWN BY DATE JHPARK01 2011/09/22 CHECKED BY DATE SHCHU 2011/09/22 APPROVED BY DATE YUNSIKKIM 2011/09/30	TITLE	1.25 W-T-B CONN. PLUG HOUSING-10P		
		DRAFT WHERE APPLICABLE MUST REMAIN WITHIN DIMENSIONS	MATERIAL NO. 1040921000	MOLEX INCORPORATED DOCUMENT NO. SD-104092-002	SHEET NO. 1 OF 01		

9 8 7 6 5 4 3 2 1