

Excellent Integrated System Limited

Stocking Distributor

Click to view price, real time Inventory, Delivery & Lifecycle Information:

[Panduit](#)

[LCCX4-38DH-L](#)

For any questions, you can email us directly:

sales@integrated-circuit.com

THIS COPY IS PROVIDED ON A RESTRICTED BASIS AND IS NOT TO BE USED IN ANY WAY DETRIMENTAL TO THE INTERESTS OF PANDUIT CORP.

| | |
|--|--|
| Material | High Conductivity Seamless Copper Tube |
| Plating | Electro-Tin |
| Wire Size | 4 STR/FLEX |
| Wire Type | Stranded Copper: Class B & C, Compact, Class G, H, I, K, M, Sizes 3, 4 & 5 Locomotive |
| Wire Strip Length | 1-1/8 in. |
| Stud Size | 3/8 in. |
| UL Listed Wire Connector | Yes, for applications up to 35kv. Consult cable manufacturer for voltage stress relief instructions with applications greater than 2000 volts. |
| UL Temperature Rating | 90 ° C |
| C.S.A Certified Wire Connector | Yes |
| Panduit Color Code on Barrel | GRAY |
| Panduit Die Index No. on Barrel | P29 |
| Alternate Industry Die Index No. () on Barrel | (8) |

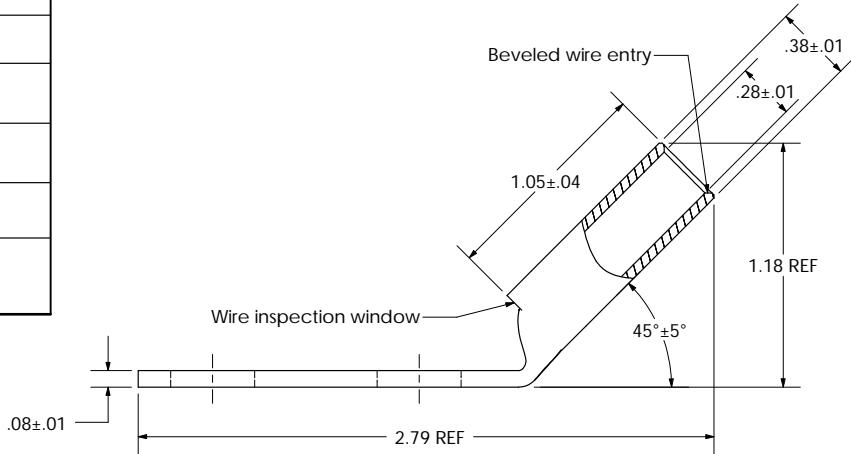
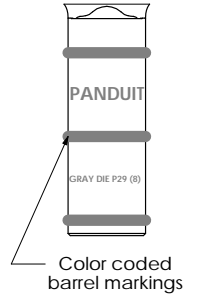
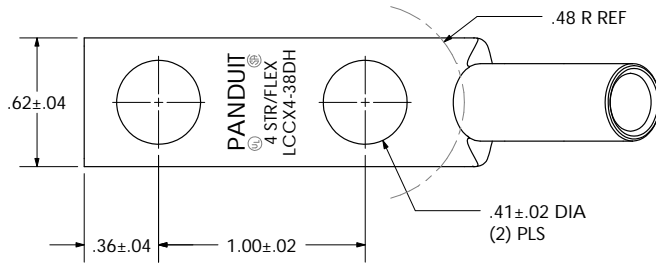

| | | | | | | |
|-----|------|------|------|---|---|---|
| | | | | | PANDUIT CORP. TINLEY PARK, ILLINOIS | |
| | | | | | LCCX4-38DH-L Copper Lug - Two-Hole, Long Flex Barrel with Window, 45° Angle Tongue | |
| 03 | 1/05 | JHNU | TLCO | PANDUIT REPLACED WIRE RANGE ON BARREL MARKING | 12412 | |
| REV | DATE | BY | CHK | DESCRIPTION | ECN | SCALE N/A DRAWING NO / CAD FILE LCCX4-38DH-CUST |