

Excellent Integrated System Limited

Stocking Distributor

Click to view price, real time Inventory, Delivery & Lifecycle Information:

[Panduit](#)
[MRS1.5H-L6](#)

For any questions, you can email us directly:
sales@integrated-circuit.com



Distributor of Panduit: Excellent Integrated System Limited
 Datasheet of MRS1.5H-L6 - CABLE TIE RADIAL SEAL HEAVY

THIS COPY IS PROVIDED ON A RESTRICTED BASIS AND IS NOT TO BE USED IN ANY WAY DETRIMENTAL TO THE INTERESTS OF PANDUIT CORP.

PANDUIT PART NO.	PACKAGE QTY	MAX BUNDLE DIAMETER	LENGTH "L" +/- .3" [7]
MRS1.5H-L6	50	1.5" [38]	10.6" (269)
MRS2H-L6	50	2.0" [51]	12.2" (310)
MRS4H-L6	50	4.0" [102]	18.5" (470)
MRS6H-L6	50	6.0" [152]	24.8" (630)

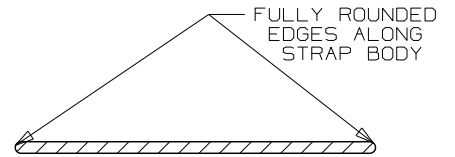
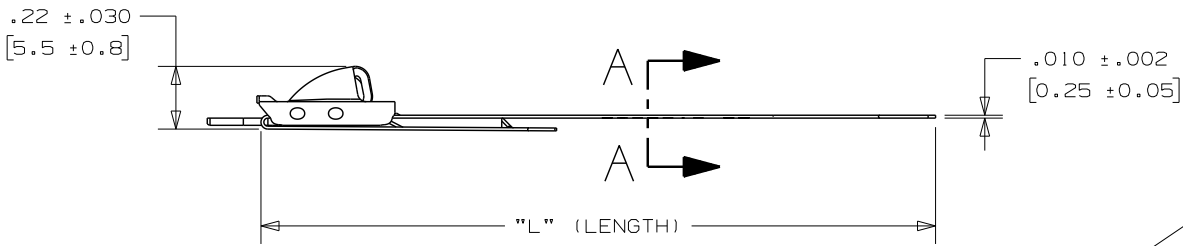
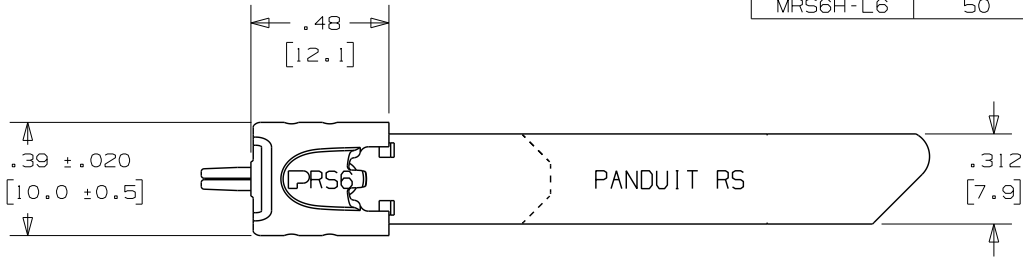

SECTION A - A
SCALE 8:1

NOTES:

1. APPLICATION TOOLS - MTRTH & PTRT
2. MINIMUM LOOP TENSILE STRENGTH - 400 LBS. (1780 NEWTONS) WHEN TESTED ON A 1.5" MANDREL
3. [] DENOTES DIMENSION IN MILLIMETERS
4. TOLERANCES:
 .XXX = ±.010 [.25] .XX = ±.02 [.5]
 .X = ±.03 [.8] ANGLES = ±2°
5. MATERIAL: 316 STAINLESS STEEL

				 TINLEY PARK, ILLINOIS					
				METAL TIE - HEAVY SERIES RETAINED TENSION - 360° RADIAL SEAL 316 STAINLESS STEEL - CUSTOMER DRAWING					
04A	10/09	MIM	SKB	REVISED PART LENGTHS FOR IMPROVED APPLICATION TOOL PERFORMANCE					
REV	DATE	BY	CHK	DESCRIPTION		DRAWN BY	CHK'D	SCALE	DRAWING NO.
						JAMB	EJD	2:1	N41228BS_DC