

Excellent Integrated System Limited

Stocking Distributor

Click to view price, real time Inventory, Delivery & Lifecycle Information:

[Panduit](#)
[FRDDSHC6BL](#)

For any questions, you can email us directly:
sales@integrated-circuit.com

THIS COPY IS PROVIDED ON A RESTRICTED BASIS AND IS NOT TO BE USED IN ANY WAY DETRIMENTAL TO THE INTERESTS OF PANDUIT CORP.

PANDUIT PART NUMBER	WEIGHT
FRDDSHC6	0.92 LB/EACH (416g/EACH)

NOTES:

- SEE CURRENT CATALOG FOR ADDITIONAL PART SUFFIXES TO INDICATE COLOR AND/OR PACKAGE QUANTITY.
- THE FIBERRUNNER 6x4 DUAL DOWNSPOUT WITH 4x4 EXITS HINGED COVER INCLUDES:
ONE (1) HINGED COVER,
THREE (3) HINGED INSERTS
- DIMENSIONS IN PARENTHESES ARE IN METRIC.

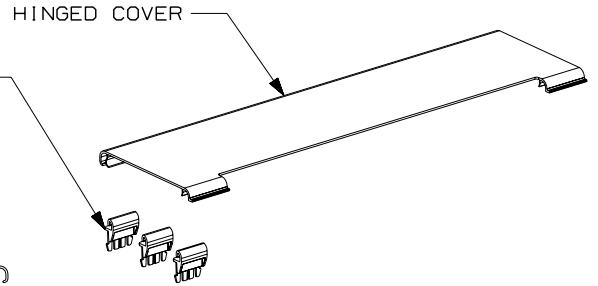
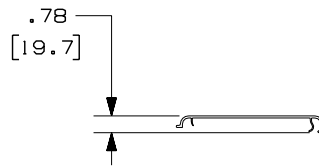
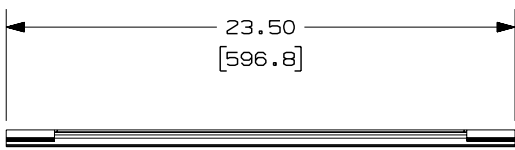
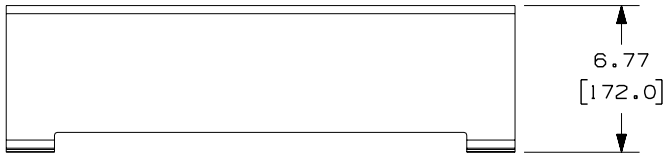

ENG. REF.: D38394B1_DC_FRDDSHC6_01.prt

CAD FILENAME/LAYERS		FRDDSHC6.pdf	
PANDUIT CORP TINLEY PARK, ILLINOIS			
FIBERRUNNER 6x4 DUAL DOWNSPOUT WITH 4x4 EXITS HINGED COVER (FRDDSHC6) CUSTOMER DRAWING			
UNLESS OTHERWISE SPECIFIED, DIMENSIONAL TOLERANCES ARE: (.X) ± (XXX) ± (.XX) ±.03 (.8) ANGLES ±		UNLESS OTHERWISE SPECIFIED, ALL DIMENSIONS ARE GIVEN IN INCHES, THIRD ANGLE PROJECTION.	
DRWN BY: MSO	MAT'L: PVC & ABS	SCALE: NONE	DWG SIZE: A
DATE: 12-4-02	CHK'D: DJWA	DRAWING NO.: 38394-06	

REV	DATE	BY	CHK	DESCRIPTION	ECN	R	CUST	SUP	GMBH
-	-----	---	---	E. REVISED PART WEIGHT	-----	--	--		
-	-----	---	---	D. REVISED GENERAL NOTES C. REVISED CAD FILENAME	-----	--	--		
1	7-6-06	DTP	RN	B. REVISED DRAWING TITLE A. REVISED AND REDRAWN	38394-06	RN	RN		