

Excellent Integrated System Limited

Stocking Distributor

Click to view price, real time Inventory, Delivery & Lifecycle Information:

[Panduit](#)

[FRH456X4BL](#)

For any questions, you can email us directly:

sales@integrated-circuit.com

THIS COPY IS PROVIDED ON A RESTRICTED BASIS AND IS NOT TO BE USED IN ANY WAY DETRIMENTAL TO THE INTERESTS OF PANDUIT CORP.

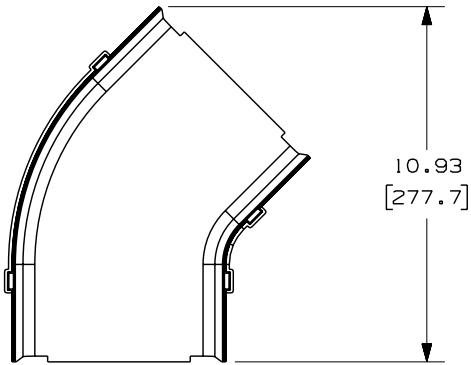

PANDUIT PART NUMBER	WEIGHT
FRH456X4	0.69 LB/EACH (314g/EACH)

NOTES:

1. SEE CURRENT CATALOG FOR ADDITIONAL PART SUFFIXES TO INDICATE COLOR AND/OR PACKAGE QUANTITY.
2. THE FIBERRUNNER 6x4 HORIZONTAL 45° ANGLE FITTING IS DESIGNED WITH A MINIMUM 2" (50.8) BEND RADIUS TO PROTECT FIBER OPTIC CABLES.
3. DIMENSIONS IN PARENTHESES ARE IN METRIC.

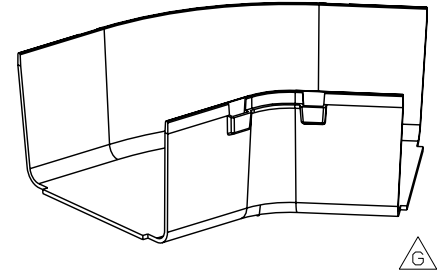
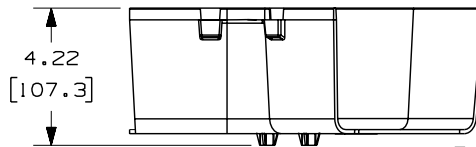
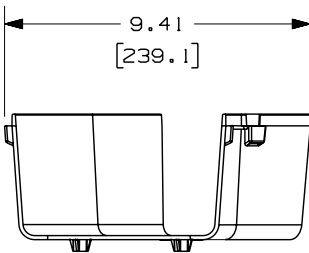

ENG. REF.: D37686BF_DC_FRH456X4_02.prt

CAD FILENAME/LAYERS		FRH456X4.pdf	
PANDUIT CORP TINLEY PARK, ILLINOIS			
FIBERRUNNER 6x4 HORIZONTAL 45° ANGLE FITTING (FRH456X4) CUSTOMER DRAWING			
UNLESS OTHERWISE SPECIFIED, DIMENSIONAL TOLERANCES ARE:		UNLESS OTHERWISE SPECIFIED, ALL DIMENSIONS ARE GIVEN IN INCHES, THIRD ANGLE PROJECTION.	
(.X) ±	(.XXX) ±		
(.XX) ± .03 (.8)	ANGLES ±		
DRAWN BY: JHNU	MAT'L: ABS	SCALE: NONE	
DATE: 8-18-00		DRAWING NO.: 37686-05	DWG SIZE: A
CHK'D: HIW			

REV	DATE	BY	CHK	DESCRIPTION	ECN	R	CUST	SUP	GMBH
-	-	-	-	K. REVISED GENERAL NOTES	-	-	-		
-	-	-	-	J. REVISED PART WEIGHT I. REVISED CAD FILENAME	-	-	-		
3	6-29-06	DTP	RN	H. REVISED DRAWING TITLE G. REVISED AND REDRAWN	37686-05	RN	RN		