

## Excellent Integrated System Limited

Stocking Distributor

Click to view price, real time Inventory, Delivery & Lifecycle Information:

[Hammond Manufacturing](#)  
[1590WDDFL](#)

For any questions, you can email us directly:

[sales@integrated-circuit.com](mailto:sales@integrated-circuit.com)

**Top View of Assembly**

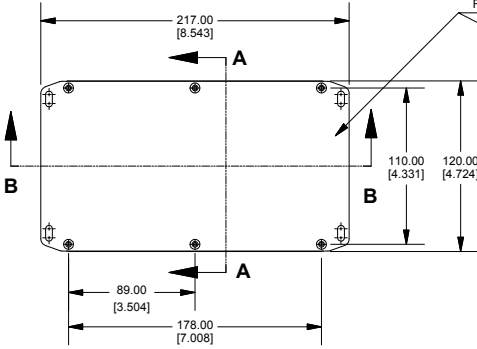

**SECTION A-A  
End View of Assembly**

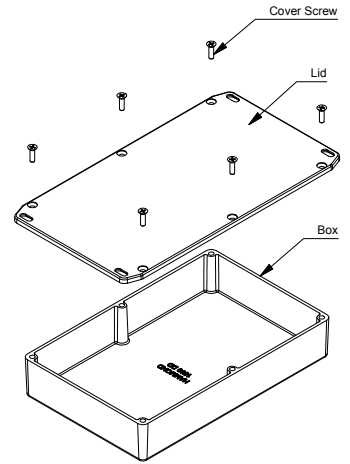
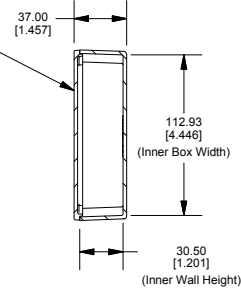

**SECTION B-B  
Side View of Assembly**

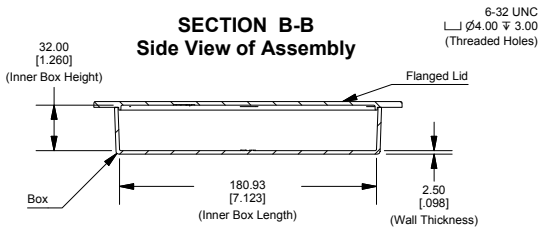

**Top View Looking Inside Box**

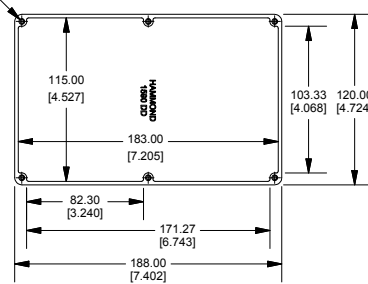

Enclosures can be Factory Modified ( Milling, Drilling, Printing etc.)  
Contact Factory [mjm@hammondmfg.com](mailto:mjm@hammondmfg.com) for quotes  
Solid models of this enclosure available in STEP or IGES.

**NOTE**  
Purchased assembly includes box, lid and 6 cover screws.  
Box and lid are made from Diecast Aluminum Alloy.  
Silicone Gasket supplied with liquid resistant enclosure.

PART NUMBERS	
1590DDFL Enclosure	
Natural Finish Enclosure	1590DDFL
Black Textured Enclosure	1590DDFLBK
1590DDFL Liquid Resistant Enclosure (Silicone Gasket)	
Natural Finish Enclosure	1590WDDFL
Black Textured Enclosure	1590WDDFLBK

ACCESSORIES	
Recommended Torque: 75 ozf.in / 55 cN.m	
Liquid Resistant Cover Screws	
Stainless Steel Cover Screws (Pkg 100)	1590WS100
[6-32 x 1/2" With O-Ring]	
Black Stainless Steel Cover Screws (Pkg 100)	1590WS100BK
[6-32 x 1/2" With O-Ring]	
Standard Cover Screws	
Plated Cover Screws (Pkg 100)	1590MS100
[6-32 x 1/2"]	
Black Cover Screws (Pkg 100)	1590MS100BK
[6-32 x 1/2"]	

**Flanged Lid**

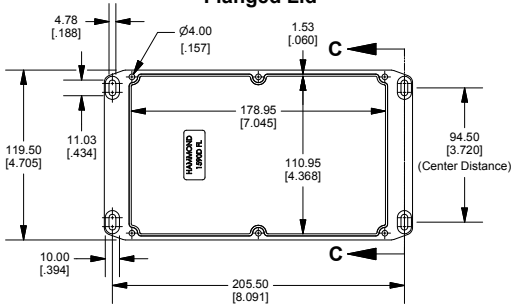

**SECTION C-C  
Side View of Slot**

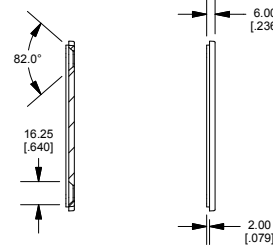

Dimensions:  
mm  
[inches]

**HAMMOND  
MANUFACTURING™**

**1590DDFL**

[www.hammondmfg.com](http://www.hammondmfg.com)