



Excellent Integrated System Limited

Stocking Distributor

Click to view price, real time Inventory, Delivery & Lifecycle Information:

[Amphenol Pcd](#)
[TJE120911](#)

For any questions, you can email us directly:

sales@integrated-circuit.com

| REV | ECN | APP'D |
|-----|------|-------|
| - | 4377 | |

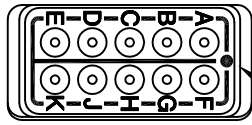

INDEXING INDICATOR

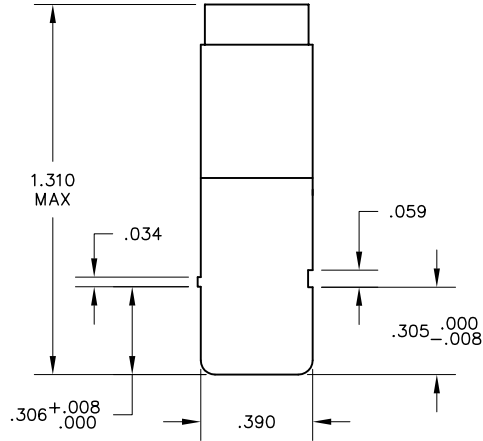
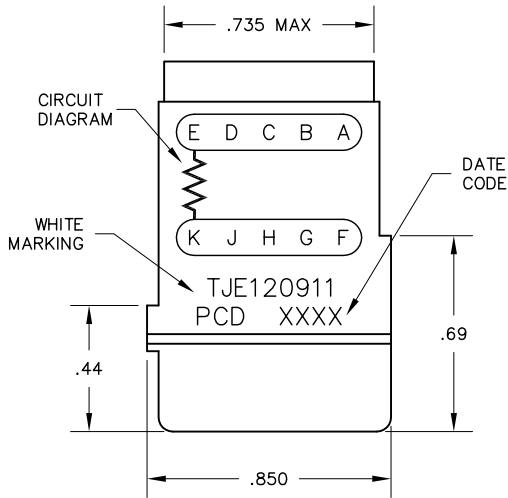

NOTES:

- MATERIALS:
HOUSING - POLYETHERIMIDE, COLOR: BLACK.
GROMMET - SILICONE ELASTOMER, COLOR: BLUE
RESISTOR - 5.1KΩ±2%, 1/2W, RLR20C5101GS.
- MODULE SUPPLIED WITH 11 PIN CONTACTS, M39029/1-101; AND 2 SEALING PLUGS, MS24788-20.

| | | | | | | | | |
|---|---|----------------|------------------------------|------|-------------|--|----------------------|--------------|
| DIMENSIONS ANSI Y14.5M UNITS: INCHES ACAD FILE | TOLERANCES .XX ±.01 .XXX ±.005 ANGLES ±2° | PROJECTION | SPECIFICATION DRAWING | | | <i>TITLE</i> ELECTRONIC MODULE RESISTOR, 5.1KΩ, 1/2W RLR20C5101GS | | |
| | | | ENGR J. TON 3-15-01 | | | SIZE A | DWG NO. TJE120911 | REV - |
| ORIGINAL | THIS DOCUMENT CONTAINS PROPRIETARY INFORMATION WHICH IS THE CONFIDENTIAL PROPERTY OF PCD, INC. PEABODY, MA, USA | | | CHKD | CODE: 58982 | | SCALE: 2X | SHEET 1 OF 1 |
| | | | | APPD | | | | |