

## Excellent Integrated System Limited

Stocking Distributor

Click to view price, real time Inventory, Delivery & Lifecycle Information:

[Amphenol Pcd](#)  
[TJE120917](#)

For any questions, you can email us directly:

[sales@integrated-circuit.com](mailto:sales@integrated-circuit.com)

REV	ECN	APP'D
A	5790	JT 1/27/06

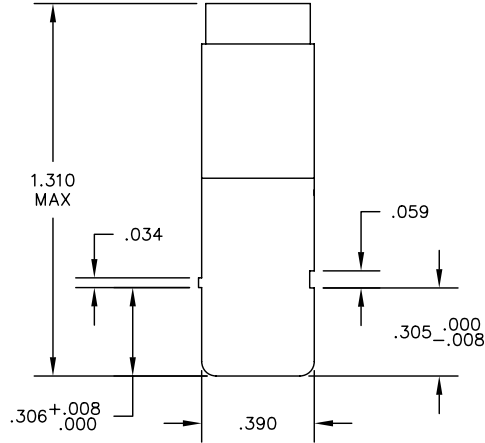
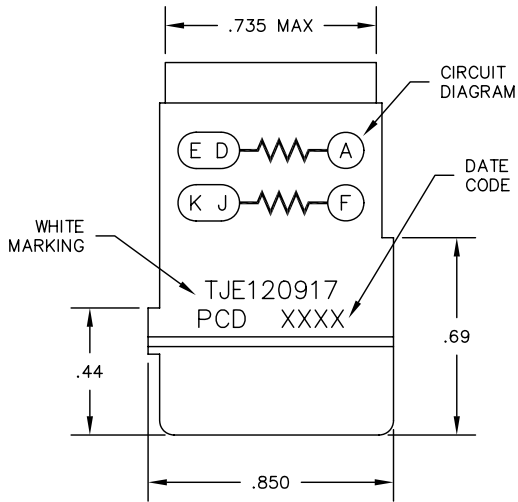
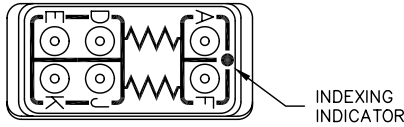

NOTES:

- MATERIALS:  
HOUSING - POLYETHERIMIDE, COLOR: BLACK.  
GROMMET - SILICONE ELASTOMER, COLOR: BLUE  
RESISTOR A - 10KΩ±1%, 1/2 W, RLR20C1002FS  
RESISTOR F - 240KΩ±2%, 1/2 W, RLR20C2403GS
- MODULE SUPPLIED WITH 7 PIN CONTACTS, M39029/1-101 AND 2 SEALING PLUGS, MS24788-20.

DIMENSIONS ANSI Y14.5M UNITS: INCHES ACAD FILE	TOLERANCES .XX ±.01 .XXX ±.005 ANGLES ±2°	PROJECTION 	<i>SPECIFICATION DRAWING</i>			<i>TITLE</i> ELECTRONIC MODULE RESISTOR, 10KΩ + 240KΩ 1/2W	
			ENGR D. LANG 03/29/05			SIZE A	DWG NO. TJE120917
ORIGINAL	THIS DOCUMENT CONTAINS PROPRIETARY INFORMATION WHICH IS THE CONFIDENTIAL PROPERTY OF PCD, INC. PEABODY, MA, USA			CHKD	CODE: 58982	SCALE: 2X	SHEET 1 OF 1
			APPD				