

Excellent Integrated System Limited

Stocking Distributor

Click to view price, real time Inventory, Delivery & Lifecycle Information:

[Amphenol Pcd](#)
[TJE122904](#)

For any questions, you can email us directly:

sales@integrated-circuit.com

REV	ECN	APP'D
-	3936	

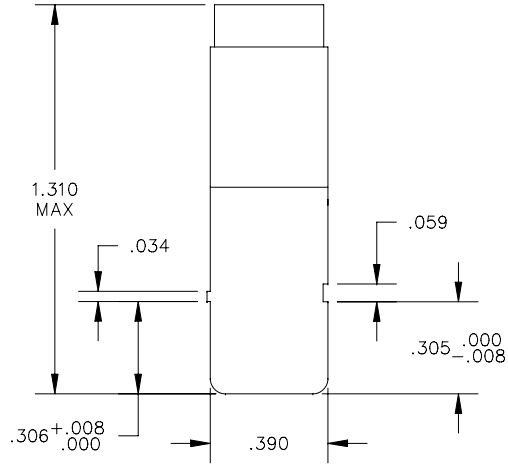
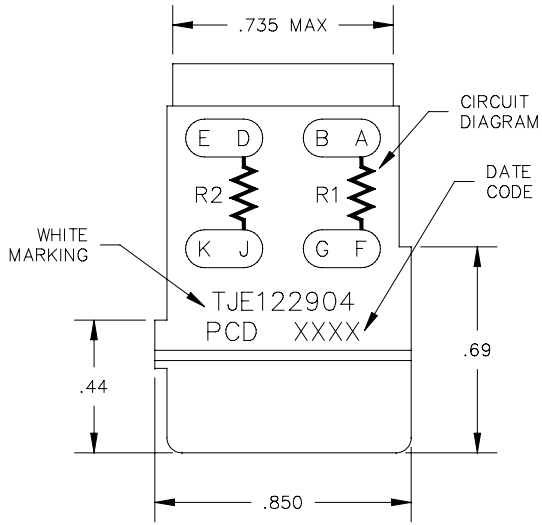
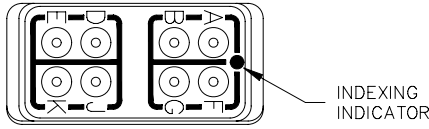

- NOTES:
- MATERIALS:
 HOUSING - POLYETHERIMIDE, COLOR: BLACK.
 GROMMET - SILICONE ELASTOMER, COLOR: BLUE
 RESISTOR - $1K \pm 0.1\%$, 1/8 W, RN60E1001B.
 - MODULE SUPPLIED WITH 9 PIN CONTACTS, M39029/1-100;
 AND 2 SEALING PLUGS, MS24788-20.

DIMENSIONS ANSI Y14.5M UNITS: INCHES ACAD FILE	TOLERANCES .XX ±.01 .XXX ±.005 ANGLES ±2°	PROJECTION 	<i>SPECIFICATION DRAWING</i>			<i>TITLE</i> ELECTRONIC MODULE RESISTOR, 1K, 1/8W RN60E1001B	
			ENGR A. PATRIE 2/23/00	CHKD		SIZE A	DWG NO. TJE122904
ORIGINAL	THIS DOCUMENT CONTAINS PROPRIETARY INFORMATION WHICH IS THE CONFIDENTIAL PROPERTY OF PCD, INC. PEABODY, MA, USA		APPD	CODE: 58982	SCALE: 2X	SHEET 1 OF 1	