

Excellent Integrated System Limited

Stocking Distributor

Click to view price, real time Inventory, Delivery & Lifecycle Information:

[Molex Connector Corporation](#)
[0622025210](#)

For any questions, you can email us directly:

sales@integrated-circuit.com

**2-by-1
zQSFP+
Extraction Tool**

molex

**Application Tooling
Specification Sheet**

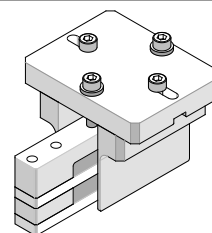

Order No. 62202-5210

FEATURES

- Used for removal of a zQSFP+ assembly from a PCB
- Removes connector from the PCB without damage to the board
- Use tool 62202-5250 to insert 170879-10** series assemblies
- Use tool 62202-5320 to insert 170879-30** series assemblies

SCOPE

Products: zQuad Small Form-factor Pluggable Plus (zQSFP+) Cage Assembly, with Elastomeric Gasket or Metal EMI Gasket, 2 by 1 Enhanced EMI Cage Construction.

Connector Series No.	Connector Order No.						
170879	170879-1001	170879-1002	170879-1003	170879-1010	170879-3001	170879-3002	170879-3003

Notes:

1. See the following pages for tooling operation instructions.
2. These tools require a "Keep Out Zone" around the connector free of components. The right and left sides should be .138" (3.5mm). See Figure 1.

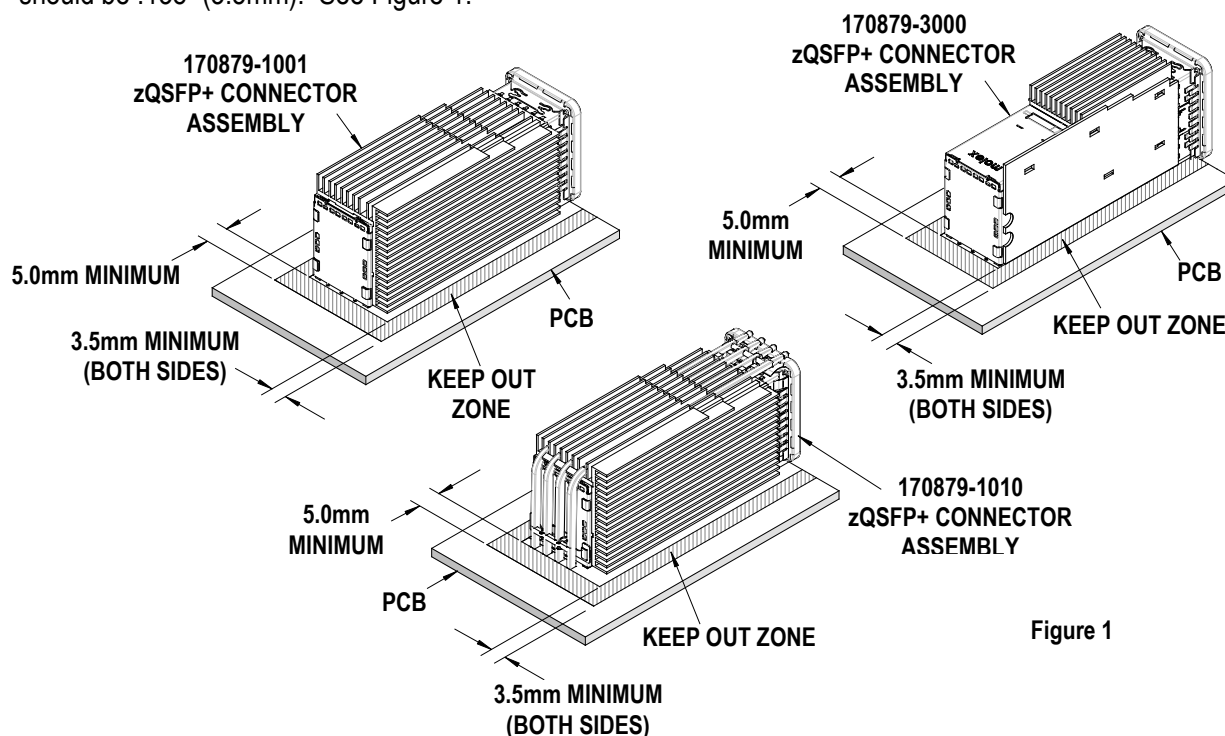

zQSFP+ Multi-Port Connector Tooling

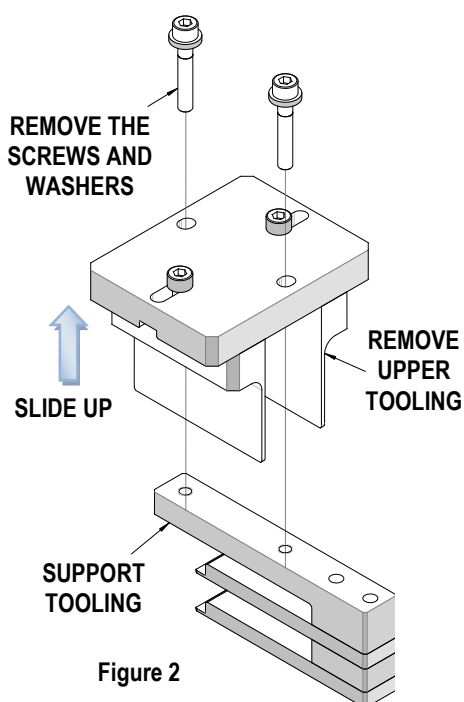

Figure 2

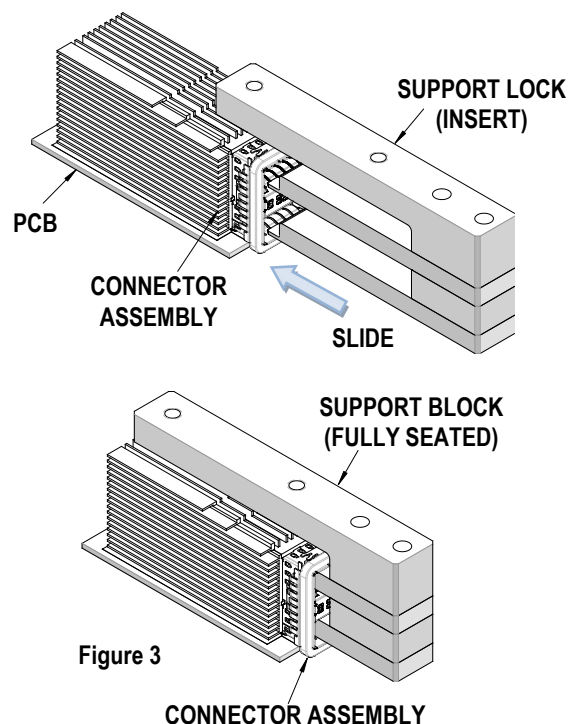

Figure 3

Description

The following Instructions are used for removing a 2-by-1 connector from a PCB.

Operation

1. Disassemble the (2) halves by unscrewing the screws on the top of the "upper tooling". See Figure 2.
2. Remove the upper tooling from the support tooling.
3. Insert the support tooling into the cage ports until it is fully seated. See Figure 3.
4. Place the top removal assembly over the support tooling and the cage assembly, aligning the screw holes of the top removal assembly with the threaded holes in the support blocks. See Figure 4.
5. If the top removal assembly does not fit over the cage, the side supports of the top assembly can be adjusted farther from the cage sides.
6. Place the washers and M5 screws into the holes in the top removal assembly; turn the screws clockwise until they are started in the support blocks.

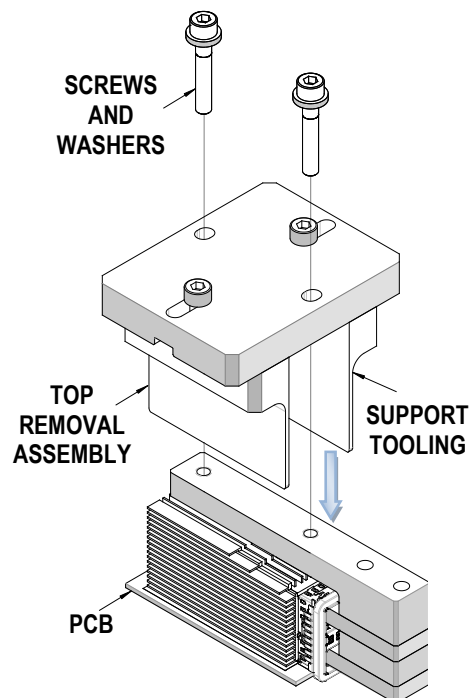

Figure 4

zQSFP+ Multi-Port Connector Tooling

7. Using a 4mm hex wrench, tighten each screw, one turn in an alternating pattern until the cage assembly is removed from the PCB. See Figure 5.

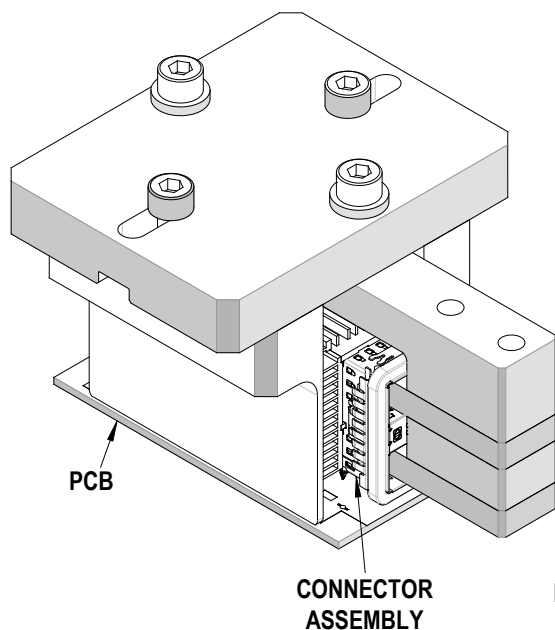
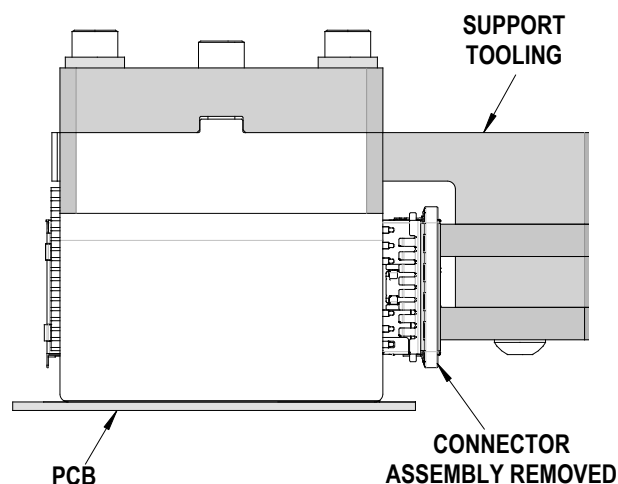

Figure 5



CAUTION: Molex application tooling specifications are valid only when used with Molex connectors and tooling.

Contact Information

For more information on Molex application tooling please contact Molex at 1-800-786-6539.

Visit our Web site at <http://www.molex.com>