

Excellent Integrated System Limited

Stocking Distributor

Click to view price, real time Inventory, Delivery & Lifecycle Information:

[Cinch Connectivity Solutions](#)

[UAD228](#)

For any questions, you can email us directly:

sales@integrated-circuit.com

MODEL NUMBER	Ω
AD228	50
UAD228	75

DATA CONTAINED IN THIS DOCUMENT IS PROPRIETARY TO EMERSON CONNECTIVITY SOLUTIONS AND SHALL NOT BE DISCLOSED, COPIED OR USED FOR PROMOTION OR MANUFACTURE WITHOUT EXPRESS WRITTEN PERMISSION

REVISIONS			
REV	DESCRIPTIONS	DATE	APPROVED
C	REVISED PER ECO 16820	9/16/09	LM

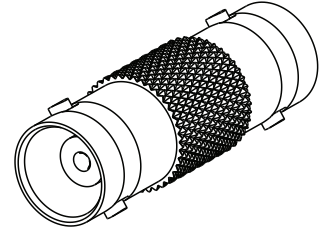

SCALE 2/1

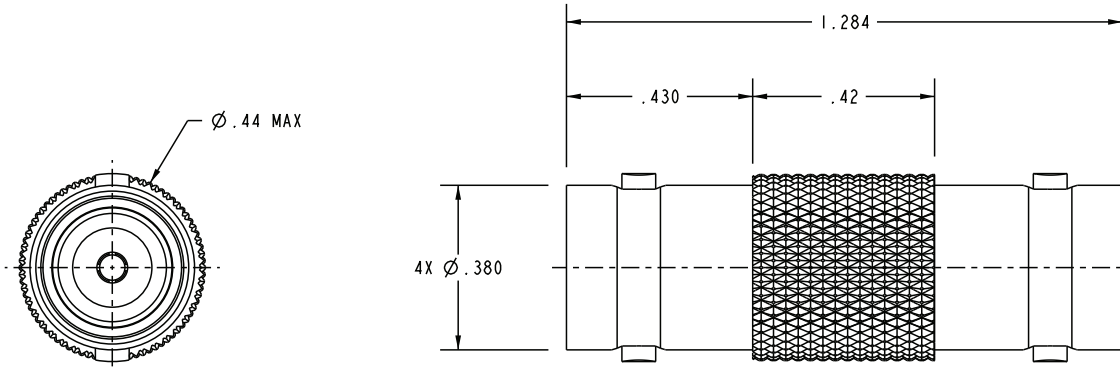

2. WITHIN SERIES FEMALE BNC FEEDTHRU ADAPTER, 50Ω AND 75Ω VERSIONS
1. FINISH: TFS-1A (NICKEL)

NOTES: UNLESS OTHERWISE SPECIFIED.

INTERPRET DRAWING PER MIL-STD-100. DIMENSIONS ARE IN INCHES AND INCLUDE FINISH THICKNESS UNLESS OTHERWISE SPECIFIED.

TOL: UNLESS SPECIFIED.
.XX ± .02
.XXX ± .010
ANGLE ± 1°



Cinch Connectivity Solutions
299 Johnson Ave. Ste. 100
Waseca, MN 56093
1-800-247-8256

DESIGNED BY W. JOHNSON	DATE 12/8/08	MATERIAL:	TITLE: U/AD228
CHECKED BY LM	DATE 9/15/09	FINISH:	SIZE A
QUALITY			CAGE CODE 14949
MANUFACTURED			DRAWING NO. 1-0623
APPROVED			REV. C
SURFACE AREA	PROJ. FILE NO. 1-0623	DO NOT SCALE DWG	SCALE 3/1
			DATE 4/11/02
			SHEET 1 OF 2