

## Excellent Integrated System Limited

Stocking Distributor

Click to view price, real time Inventory, Delivery & Lifecycle Information:

[Cinch Connectivity Solutions](#)

[UCJ20-5](#)

For any questions, you can email us directly:

[sales@integrated-circuit.com](mailto:sales@integrated-circuit.com)

RED INDICATES ORIGINAL

| DASH NO | FIG | CABLES ACCOMMODATED             | A DIM | B FLATS | C HEX | D DIA MAX | ASSEMBLY REQ. |
|---------|-----|---------------------------------|-------|---------|-------|-----------|---------------|
| -1      |     | RG-58                           |       |         |       |           |               |
| -U1     |     | ESSEX 621-715                   |       |         |       |           |               |
| -2      |     | RG-59                           |       |         |       |           |               |
| -U2     |     |                                 |       |         |       |           |               |
| -2A     |     | BELDEN 6297                     |       |         |       |           |               |
| -U2A    |     |                                 |       |         |       |           |               |
| -2B     |     | W. E. CO. 730A                  |       |         |       |           |               |
| -U2B    |     |                                 |       |         |       |           |               |
| -3      |     |                                 |       |         |       |           |               |
| -U3     | 1.3 | RG-223                          | .997  | .500    | .437  | .600      |               |
| -3A     |     |                                 |       |         |       |           |               |
| -U3A    |     | RG-55                           |       |         |       |           |               |
| -4      |     | RG-122                          |       |         |       |           |               |
| -U4     |     | BELDEN 6218                     |       |         |       |           |               |
| -5      |     | RG-174                          |       |         |       |           |               |
| -U5     |     | RG-187                          |       |         |       |           |               |
| -5A     |     | RG-199                          |       |         |       |           |               |
| -U5A    |     |                                 |       |         |       |           |               |
| -5B     |     | HEWLETT-PACKARD 8120-1107       |       |         |       |           |               |
| -U5B    |     |                                 |       |         |       |           |               |
| -6      |     |                                 |       |         |       |           |               |
| -U6     | 1   | BELDEN 9231                     | 1.030 | .562    | .500  | .655      | TAI-101       |
| -6E     |     | RG-5                            |       |         |       |           |               |
| -U6E    |     | RG-6                            |       |         |       |           |               |
| -21     |     |                                 |       |         |       |           |               |
| -U21    |     | RG-303                          |       |         |       |           |               |
| -22     |     | RG-180                          |       |         |       |           |               |
| -U22    |     | GRIMMAN RC8756P1                |       |         |       |           |               |
| -31     |     | RG-187 DBL SHLD                 |       |         |       |           |               |
| -U31    |     | BELDEN 8228                     |       |         |       |           |               |
| -34     |     |                                 |       |         |       |           |               |
| -U34    | 1.3 | 275-9801 MICRODOT 616-568 AMPEX | .997  | .500    | .437  | .600      |               |
| -37     |     | 810 RAYCHEM                     |       |         |       |           |               |
| -U37    |     |                                 |       |         |       |           |               |
| -41     |     | RG-304 BELDEN 9248, 9284, 9383  |       |         |       |           |               |
| -U41    |     | BRAND-REX B749 GORE COBCC32     |       |         |       |           |               |
| -44     |     |                                 |       |         |       |           |               |
| -U44    |     |                                 |       |         |       |           |               |
| -51     |     |                                 |       |         |       |           |               |
| -U51    | 1   | 89281 BELDEN                    | 1.030 | .562    | .500  | .655      |               |
| -52     |     | 89120 BELDEN                    |       |         |       |           |               |
| -U52    |     |                                 |       |         |       |           |               |
| -53     |     | 89555 BELDEN                    |       |         |       |           |               |
| -U53    | 1.3 |                                 |       |         |       |           |               |
| -63     |     | 734A, AT&T                      | .997  | .500    | .437  | .600      |               |
| -U63    |     |                                 |       |         |       |           |               |
| -68     |     |                                 |       |         |       |           |               |
| -U68    |     | RG-405                          |       |         |       |           |               |
| -141    | 2   | RG-402                          |       |         |       |           | TAI-130       |
| -U141   |     |                                 |       |         |       |           |               |

FIG 1  
- 1 SHOWN

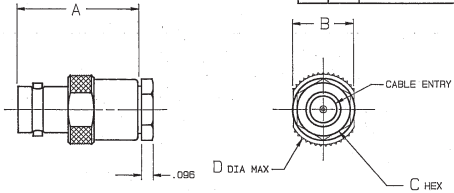

FIG 2  
- .085 SHOWN

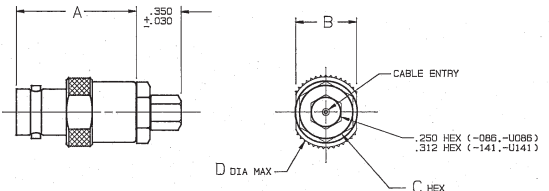
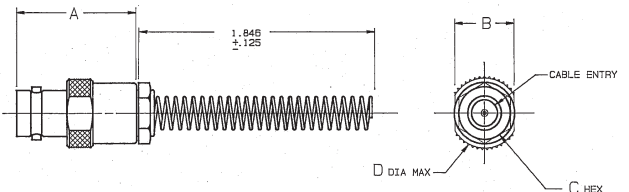

FIG 3  
- 1 SHOWN



| INCH  | MM    |
|-------|-------|
| .005  | 0.13  |
| .030  | 0.76  |
| .096  | 2.44  |
| .125  | 3.18  |
| .250  | 6.35  |
| .312  | 7.92  |
| .350  | 8.89  |
| .437  | 11.10 |
| .500  | 12.70 |
| .562  | 14.27 |
| .600  | 15.24 |
| .655  | 16.64 |
| .897  | 22.82 |
| 1.030 | 26.16 |
| 1.845 | 46.88 |

IF BEND RELIEF SPRING REQUIRED ADD SUFFIX "BR" TO MODEL NO. (SEE FIG 3) (NOT AVAILABLE WITH CABLE GROUPS -B, -U6, -6E, -51, -U51, -52, -U52, -63, -U63, -085, -U085, -141 & -U141)

- DASH NO DENOTES CABLE GROUP EXCEPT "U" PREFIX DENOTES 75 OHM VERSION
- FEMALE TYPE BNC COAXIAL CABLE PLUS BOTH 50 & 75 OHM VERSIONS
- FINISH: 75-1A (NICKEL)
- ALL DIM ARE IN INCHES

| DISK # | DESCRIPTION   | REV | ED   | DESCRIPTION   | DWN | APPROVED | DATE   |
|--------|---|-----|------|---|-----|----------|--------|
| C 4    | DATA CONTAINED IN THIS DOCUMENT IS PROPRIETARY TO TROMPETER ELECTRONICS INC. AND SHALL NOT BE DISCLOSED, COPIED OR USED FOR REPRODUCTION OR MANUFACTURE WITHOUT EXPRESS WRITTEN PERMISSION. | W   | 8594 | ADDED -63 CABLE GROUP: DIM .500 & .655 WERE .570 AND .640; DWS NO WAS 1000-0134 AND REDRAWN | DJK | DJK      | 1/3/87 |

| TOL UNLESS SPECIFIED | DESCRIPTION | PART NUMBER | ITEM         |
|----------------------|-------------|-------------|--------------|
| 105-0717             | 105-0449    | XX ± .005   |              |
| 110-0002             | 1-0220      | XXXX        |              |
| 205-0001             | 1-0218      | DWN         | DJK 8/15/88  |
| 105-1010             | 1-0204      | CHK         | DJK 10/21/88 |
| 105-1004             | 1-0212      | ENGR        | DJK 10/21/88 |
| 105-0156             | NEXT ASSY   | APPR        | DJK 1/3/87   |

|                                     |              |                |      |
|-------------------------------------|--------------|----------------|------|
|                                     |              | C320/UCJ20     | ITEM |
| MATERIAL CODE IDENT<br><b>14949</b> |              | C3209R/UCJ209R |      |
| DRAWING NO.                         | REV          |                |      |
| <b>1-0134</b>                       | <b>W</b>     |                |      |
| SCALE 2/1                           | DATE 1/17/86 | SHEET 1 OF 2   |      |