

Excellent Integrated System Limited

Stocking Distributor

Click to view price, real time Inventory, Delivery & Lifecycle Information:

[Weidmüller](#)
[1799150000](#)

For any questions, you can email us directly:

sales@integrated-circuit.com

Product catalogue | PCB connection systems | PCB plug-in connectors | Pitch 3.81 mm (0.150 inch) | Socket connectors, screw clamp connection, pitch 3.81 | BCZ 3.81/90/270 | BCZ 3.81/270F

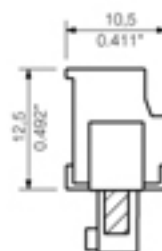
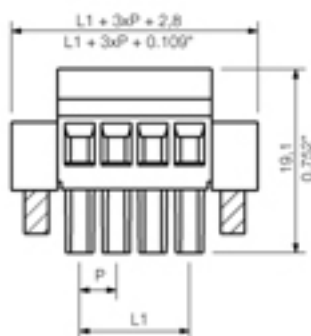

General ordering data

Order No.	1799150000
Part designation	BCZ 3.81/12/270F SN SW
Version	PCB plug-in connector, Female connectors, Clamping yoke connection, Clamping range, max.: 1.5 mm ² , Pitch: 3.81 mm, No. of poles: 12, 270°, Box
EAN	4032248244041
Qty.	50 pc(s).

System parameters

Conductor connection system	Clamping yoke connection
Outgoing direction of conductor	270°
Pitch	3.81 mm
Pitch in inch	0.15 inch
No. of poles	12
No. of rows	1
Screwdriver blade	0.4 x 2.5
Screwdriver blade standard	DIN 5264
Tightening torque, min.	0.2
Tightening torque, max.	0.25 Nm
Clamping screw	M 2
Stripping length	7 mm
L1 in mm	41.91 mm
L1 in inch	1.65 inch
Electric shock protection to DIN VDE 0470	IP 20
Electric shock protection to DIN VDE 0470	Safe from finger touch

Material data

Insulating material	PA GF
Colour	black
colour chart	Similar to RAL 9011
Insulating material group	II
Flammability class UL 94	V-0
CTI	>= 475

Product catalogue | PCB connection systems | PCB plug-in connectors | Pitch 3.81 mm (0.150 inch) | Socket connectors, screw clamp connection, pitch 3.81 | BCZ 3.81/90/270 | BCZ 3.81/270F

Material data

Contact base material	Copper alloy
Contact surface	tinned

Connectable conductors

Clamping range, min.	0.08 mm ²
Clamping range, max.	1.5 mm ²
AWG, min.	28
AWG, max.	16
Solid, min. H05(07) V-U	0.2 mm ²
Solid, max. H05(07) V-U	1.5 mm ²
Flexible, min. H05(07) V-K	0.2 mm ²
Flexible, max. H05(07) V-K	1.5 mm ²
With wire end ferrule, acc. to DIN 46 228/1, min.	0.2 mm ²
With wire end ferrule, acc. to DIN 46 228/1, max.	1.5 mm ²
w. plastic collar ferrule, DIN 46228 pt 4, min.	0.2 mm ²
w. plastic collar ferrule, DIN 46228 pt 4, max.	1.5 mm ²
Gauge to EN 60999 a x b; ø	2.4 mm x 1.5 mm ; 2.4 mm

DIN IEC rating data

Rated current, min. No. pins (Tu=20°C)	17.5 A
Rated current, max. No. pins (Tu=20°C)	15.9 A
Rated current, min. No. pins (Tu=40°C)	17.5 A
Rated current, max. No. pins (Tu=40°C)	14.1 A
Rated voltage for overvoltage class/pollution severity II/2	320 V
Rated voltage for overvoltage class/pollution severity III/2	160 V
Rated voltage for overvoltage class/pollution severity III/3	160 V
Rated impulse withstand voltage for overvoltage class/pollution severity II/2	2.5 kV
Rated impulse withstand voltage for overvoltage class/pollution severity III/2	2.5 kV
Rated impulse withstand voltage for overvoltage class/pollution severity III/3	2.5 kV
Short-time withstand current resistance	3 x 1s with 76 A

CSA rating data

Rated voltage (Use group D)	300 V
Rated current (Use group D)	10 A
AWG conductor (field wiring), min.	28
AWG conductor (field wiring), max.	16

UL 1059 rating data

Rated voltage (Use group D)	300 V
Rated current (Use group D)	10 A
AWG conductor, min.	28
AWG conductor, max.	16

Product catalogue | PCB connection systems | PCB plug-in connectors | Pitch 3.81 mm (0.150 inch) | Socket connectors, screw clamp connection, pitch 3.81 | BCZ 3.81/90/270 | BCZ 3.81/270F

Approvals

Approvals institutes



Classifications

ETIM 2.0	NK
ETIM 3.0	EC001284
eClass 4.1	27-26-07-01
eClass 5.0	27-26-07-01
eClass 5.1	27-26-07-04

Similar products

Order No.	Part designation	Version
1940460000	BCZ 3.81/2/270F SN OR	PCB plug-in connector, Female connectors, Clamping yoke connection, Clamping range, max.: 1.5 mm ² , Pitch: 3.81 mm, No. of poles: 2, 270°, Box
1799100000	BCZ 3.81/2/270F SN SW	PCB plug-in connector, Female connectors, Clamping yoke connection, Clamping range, max.: 1.5 mm ² , Pitch: 3.81 mm, No. of poles: 2, 270°, Box
1799170000	BCZ 3.81/2/270F SN GN	PCB plug-in connector, Female connectors, Clamping yoke connection, Clamping range, max.: 1.5 mm ² , Pitch: 3.81 mm, No. of poles: 2, 270°, Box
1940470000	BCZ 3.81/3/270F SN OR	PCB plug-in connector, Female connectors, Clamping yoke connection, Clamping range, max.: 1.5 mm ² , Pitch: 3.81 mm, No. of poles: 3, 270°, Box
1798180000	BCZ 3.81/3/270F SN SW	PCB plug-in connector, Female connectors, Clamping yoke connection, Clamping range, max.: 1.5 mm ² , Pitch: 3.81 mm, No. of poles: 3, 270°, Box
1799180000	BCZ 3.81/3/270F SN GN	PCB plug-in connector, Female connectors, Clamping yoke connection, Clamping range, max.: 1.5 mm ² , Pitch: 3.81 mm, No. of poles: 3, 270°, Box
1940480000	BCZ 3.81/4/270F SN OR	PCB plug-in connector, Female connectors, Clamping yoke connection, Clamping range, max.: 1.5 mm ² , Pitch: 3.81 mm, No. of poles: 4, 270°, Box
1799110000	BCZ 3.81/4/270F SN SW	PCB plug-in connector, Female connectors, Clamping yoke connection, Clamping range, max.: 1.5 mm ² , Pitch: 3.81 mm, No. of poles: 4, 270°, Box
1799190000	BCZ 3.81/4/270F SN GN	PCB plug-in connector, Female connectors, Clamping yoke connection, Clamping range, max.: 1.5 mm ² , Pitch: 3.81 mm, No. of poles: 4, 270°, Box
1940490000	BCZ 3.81/5/270F SN OR	PCB plug-in connector, Female connectors, Clamping yoke connection, Clamping range, max.: 1.5 mm ² , Pitch: 3.81 mm, No. of poles: 5, 270°, Box
1799120000	BCZ 3.81/5/270F SN SW	PCB plug-in connector, Female connectors, Clamping yoke connection, Clamping range, max.: 1.5 mm ² , Pitch: 3.81 mm, No. of poles: 5, 270°, Box

Product catalogue | PCB connection systems | PCB plug-in connectors | Pitch 3.81 mm (0.150 inch) | Socket connectors, screw clamp connection, pitch 3.81 | BCZ 3.81/90/270 | BCZ 3.81/270F

1799200000	BCZ 3.81/5/270F SN GN	PCB plug-in connector, Female connectors, Clamping yoke connection, Clamping range, max.: 1.5 mm ² , Pitch: 3.81 mm, No. of poles: 5, 270°, Box
1940500000	BCZ 3.81/6/270F SN OR	PCB plug-in connector, Female connectors, Clamping yoke connection, Clamping range, max.: 1.5 mm ² , Pitch: 3.81 mm, No. of poles: 6, 270°, Box
1799130000	BCZ 3.81/6/270F SN SW	PCB plug-in connector, Female connectors, Clamping yoke connection, Clamping range, max.: 1.5 mm ² , Pitch: 3.81 mm, No. of poles: 6, 270°, Box
1799210000	BCZ 3.81/6/270F SN GN	PCB plug-in connector, Female connectors, Clamping yoke connection, Clamping range, max.: 1.5 mm ² , Pitch: 3.81 mm, No. of poles: 6, 270°, Box
1940510000	BCZ 3.81/7/270F SN OR	PCB plug-in connector, Female connectors, Clamping yoke connection, Clamping range, max.: 1.5 mm ² , Pitch: 3.81 mm, No. of poles: 7, 270°, Box
1940670000	BCZ 3.81/7/270F SN SW	PCB plug-in connector, Female connectors, Clamping yoke connection, Clamping range, max.: 1.5 mm ² , Pitch: 3.81 mm, No. of poles: 7, 270°, Box
1940610000	BCZ 3.81/7/270F SN GN	PCB plug-in connector, Female connectors, Clamping yoke connection, Clamping range, max.: 1.5 mm ² , Pitch: 3.81 mm, No. of poles: 7, 270°, Box
1940520000	BCZ 3.81/8/270F SN OR	PCB plug-in connector, Female connectors, Clamping yoke connection, Clamping range, max.: 1.5 mm ² , Pitch: 3.81 mm, No. of poles: 8, 270°, Box
1798190000	BCZ 3.81/8/270F SN SW	PCB plug-in connector, Female connectors, Clamping yoke connection, Clamping range, max.: 1.5 mm ² , Pitch: 3.81 mm, No. of poles: 8, 270°, Box
1799220000	BCZ 3.81/8/270F SN GN	PCB plug-in connector, Female connectors, Clamping yoke connection, Clamping range, max.: 1.5 mm ² , Pitch: 3.81 mm, No. of poles: 8, 270°, Box
1940530000	BCZ 3.81/9/270F SN OR	PCB plug-in connector, Female connectors, Clamping yoke connection, Clamping range, max.: 1.5 mm ² , Pitch: 3.81 mm, No. of poles: 9, 270°, Box
1940680000	BCZ 3.81/9/270F SN SW	PCB plug-in connector, Female connectors, Clamping yoke connection, Clamping range, max.: 1.5 mm ² , Pitch: 3.81 mm, No. of poles: 9, 270°, Box
1940620000	BCZ 3.81/9/270F SN GN	PCB plug-in connector, Female connectors, Clamping yoke connection, Clamping range, max.: 1.5 mm ² , Pitch: 3.81 mm, No. of poles: 9, 270°, Box
1940540000	BCZ 3.81/10/270F SN OR	PCB plug-in connector, Female connectors, Clamping yoke connection, Clamping range, max.: 1.5 mm ² , Pitch: 3.81 mm, No. of poles: 10, 270°, Box
1799140000	BCZ 3.81/10/270F SN SW	PCB plug-in connector, Female connectors, Clamping yoke connection, Clamping range, max.: 1.5 mm ² , Pitch: 3.81 mm, No. of poles: 10, 270°, Box
1799230000	BCZ 3.81/10/270F SN GN	PCB plug-in connector, Female connectors, Clamping yoke connection, Clamping range, max.: 1.5 mm ² , Pitch: 3.81 mm, No. of poles: 10, 270°, Box
1940550000	BCZ 3.81/11/270F SN OR	PCB plug-in connector, Female connectors, Clamping yoke connection, Clamping range, max.: 1.5 mm ² , Pitch: 3.81 mm, No. of poles: 11, 270°, Box

Product catalogue | PCB connection systems | PCB plug-in connectors | Pitch 3.81 mm (0.150 inch) | Socket connectors, screw clamp connection, pitch 3.81 | BCZ 3.81/90/270 | BCZ 3.81/270F

1940690000	BCZ 3.81/11/270F SN SW	PCB plug-in connector, Female connectors, Clamping yoke connection, Clamping range, max.: 1.5 mm ² , Pitch: 3.81 mm, No. of poles: 11, 270°, Box
1940630000	BCZ 3.81/11/270F SN GN	PCB plug-in connector, Female connectors, Clamping yoke connection, Clamping range, max.: 1.5 mm ² , Pitch: 3.81 mm, No. of poles: 11, 270°, Box
1940560000	BCZ 3.81/12/270F SN OR	PCB plug-in connector, Female connectors, Clamping yoke connection, Clamping range, max.: 1.5 mm ² , Pitch: 3.81 mm, No. of poles: 12, 270°, Box
1799240000	BCZ 3.81/12/270F SN GN	PCB plug-in connector, Female connectors, Clamping yoke connection, Clamping range, max.: 1.5 mm ² , Pitch: 3.81 mm, No. of poles: 12, 270°, Box
1940570000	BCZ 3.81/13/270F SN OR	PCB plug-in connector, Female connectors, Clamping yoke connection, Clamping range, max.: 1.5 mm ² , Pitch: 3.81 mm, No. of poles: 13, 270°, Box
1940700000	BCZ 3.81/13/270F SN SW	PCB plug-in connector, Female connectors, Clamping yoke connection, Clamping range, max.: 1.5 mm ² , Pitch: 3.81 mm, No. of poles: 13, 270°, Box
1940640000	BCZ 3.81/13/270F SN GN	PCB plug-in connector, Female connectors, Clamping yoke connection, Clamping range, max.: 1.5 mm ² , Pitch: 3.81 mm, No. of poles: 13, 270°, Box
1940580000	BCZ 3.81/14/270F SN OR	PCB plug-in connector, Female connectors, Clamping yoke connection, Clamping range, max.: 1.5 mm ² , Pitch: 3.81 mm, No. of poles: 14, 270°, Box
1940710000	BCZ 3.81/14/270F SN SW	PCB plug-in connector, Female connectors, Clamping yoke connection, Clamping range, max.: 1.5 mm ² , Pitch: 3.81 mm, No. of poles: 14, 270°, Box
1940650000	BCZ 3.81/14/270F SN GN	PCB plug-in connector, Female connectors, Clamping yoke connection, Clamping range, max.: 1.5 mm ² , Pitch: 3.81 mm, No. of poles: 14, 270°, Box
1940590000	BCZ 3.81/15/270F SN OR	PCB plug-in connector, Female connectors, Clamping yoke connection, Clamping range, max.: 1.5 mm ² , Pitch: 3.81 mm, No. of poles: 15, 270°, Box
1940720000	BCZ 3.81/15/270F SN SW	PCB plug-in connector, Female connectors, Clamping yoke connection, Clamping range, max.: 1.5 mm ² , Pitch: 3.81 mm, No. of poles: 15, 270°, Box
1940660000	BCZ 3.81/15/270F SN GN	PCB plug-in connector, Female connectors, Clamping yoke connection, Clamping range, max.: 1.5 mm ² , Pitch: 3.81 mm, No. of poles: 15, 270°, Box
1940600000	BCZ 3.81/16/270F SN OR	PCB plug-in connector, Female connectors, Clamping yoke connection, Clamping range, max.: 1.5 mm ² , Pitch: 3.81 mm, No. of poles: 16, 270°, Box
1799160000	BCZ 3.81/16/270F SN SW	PCB plug-in connector, Female connectors, Clamping yoke connection, Clamping range, max.: 1.5 mm ² , Pitch: 3.81 mm, No. of poles: 16, 270°, Box
1799250000	BCZ 3.81/16/270F SN GN	PCB plug-in connector, Female connectors, Clamping yoke connection, Clamping range, max.: 1.5 mm ² , Pitch: 3.81 mm, No. of poles: 16, 270°, Box