

## Excellent Integrated System Limited

Stocking Distributor

Click to view price, real time Inventory, Delivery & Lifecycle Information:

[Amphenol Commercial Products](#)

[L17159006](#)

For any questions, you can email us directly:

[sales@integrated-circuit.com](mailto:sales@integrated-circuit.com)

This document is the property of Amphenol Corporation and is delivered on the express condition that it is not to be disclosed, reproduced or used, in whole or in part, by manufacturer or user for anyone other than Amphenol Corporation without its prior consent, & that no right is granted to disclose or to use any information in this document.

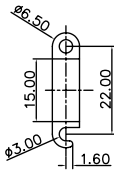
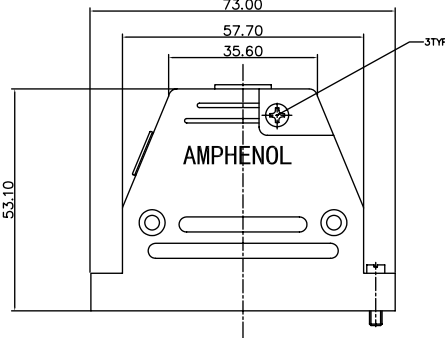
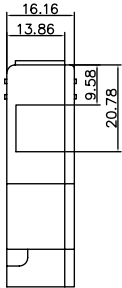
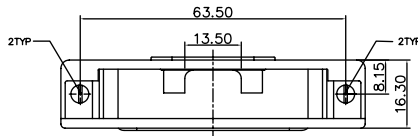

1 Pcs

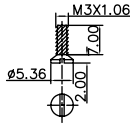

2 Pcs

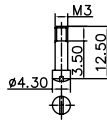

2 Pcs

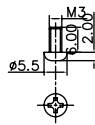

2 Pcs

# Customer Drawing

REVISIONS				
SYM	ECN	DESCRIPTION	DATE	APPROVED
1			12/15/08	

## D-SUB TECHNICAL DATA

Hood, plastic, For 37 positions D-SUB connectors  
 MATERIAL : Plastic  
 CLIMATIC : Temperature range -30 °C up to 90°C  
 MARKING : Amphenol...(Series No.)  
 Commercial reference  
 Manufacturing date

### PRODUCT CODE



UNLESS OTHERWISE SPECIFIED		APPROVAL	DATE
TOLERANCES		DRAWN	12/15/08
U.S.	METRIC	CHECKED	12/15/08
X +/-	0.50		
XX +/-	0.30		
XXX +/-	0.20		
FRACTIONS			
ANGLES	2°		
FOR MATERIALS AND FINISHES		DRAWING FILE :	
SEE NOTES		REMOVE SHARP EDGES	
DIMENSIONS		ANGLE OF PROJECTION	
U.S.	INCHES		
METRIC	MM		

Amphenol®	
hood	
SIZE	DRAWING NO.
A4	C L17159006
SCALE	NONE
SHEET	1 OF 1