

Excellent Integrated System Limited

Stocking Distributor

Click to view price, real time Inventory, Delivery & Lifecycle Information:

[FCI](#)
[EU03108100J0G](#)

For any questions, you can email us directly:
sales@integrated-circuit.com

PRODUCT NUMBER	PITCH
EU0310x100JOG	3.50 mm

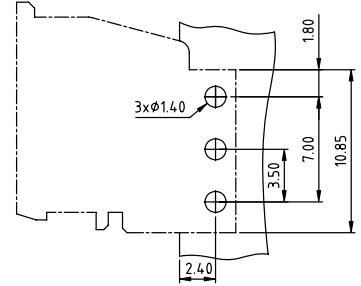
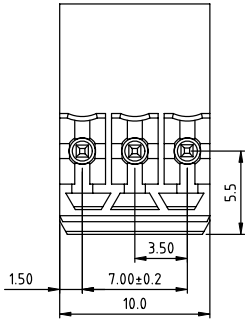

RECOMMENDED P.C.B LAYOUT
TOP VIEW

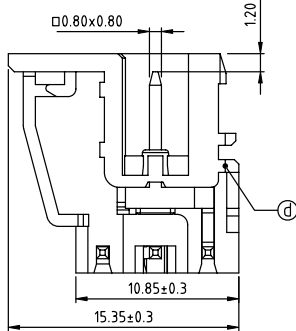
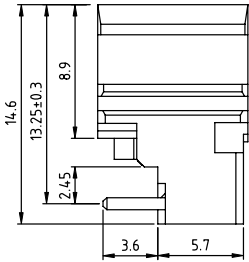

PART NO.: EU 03 10 x 1 00J0 G

- Color RoHS compliant
 (lead<4%)
 In copper Alloy
- 0 Black (RAL9005)
 - 2 Red (RAL3001/D)
 - 3 Orange(RAL2011/P)
 - 4 Yellow(RAL1018/A)
 - 5 Green(RAL6018/T)
 - 6 Blue (RAL5015/A)
 - 8 Grey(RAL7035/D)
 - 9 White(RAL1102)
 - C Green(RAL6018/U)

- Material:
- Item@Pin-01: Copper, Tin plated
 - Item@Pin-02: Copper, Tin plated
 - Item@Pin-03: Copper, Tin plated
 - Item@Terminal(housing): Thermoplastic (UL94V-0)
- Electrical:
- cULus
 - Voltage rating: 300V
 - Current rating: 10A
 - Withstanding Voltage: 1.6 KV
 - Operating temperature: -40°C to +115°C
 - Soldering temperature: 260°C±5°C/5 Sec
 - Safety Approval:

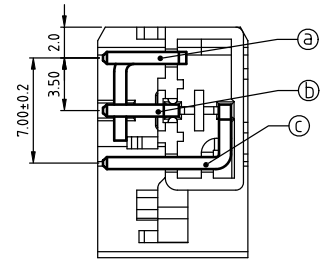

mat'l. code	surface ASME Y14.5	tolerance ASME Y14.5	projection	product family	TERMINAL BLOCK
ltr	ecn	no	dr	date	title
					TERMINAL BLOCK
					PLUGGABLE SOCKET, LEFT TYPE
					dwg no
					EU0310x100JOG
					sheet 1 of 1
					size
					A4
					type
					CUSTOMER Drawing
sheet index	revision sheet	A	1		