

## Excellent Integrated System Limited

Stocking Distributor

Click to view price, real time Inventory, Delivery & Lifecycle Information:

[FCI](#)  
[HM02508100J0G](#)

For any questions, you can email us directly:  
[sales@integrated-circuit.com](mailto:sales@integrated-circuit.com)

PRODUCT NUMBER	PITCH
HMxx50x100J0G	5.08mm

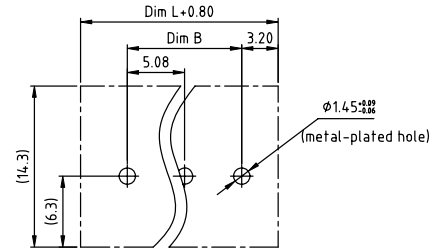
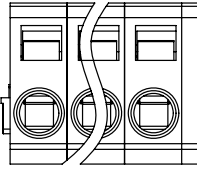

RECOMMENDED P.C.B LAYOUT  
TOP VIEW

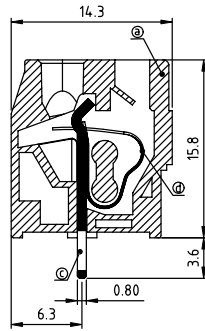
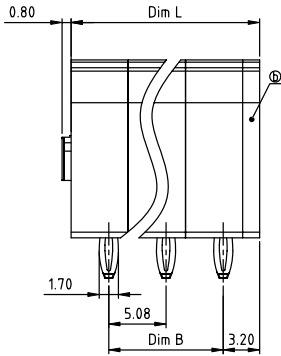

Material:

- Item ① Insulator body: Thermoplastic (UL94V-0)
  - Item ② Insulating cover: Thermoplastic (UL94V-0)
  - Item ③ Solder pin: Brass Tin plated
  - Item ④ Wire guard: Stainless steel
- Electrical: cULus
- Voltage rating: 250V
  - Current rating: 8A
  - Wire range:
  - Solid wire(AWG): 12-28
  - Stranded wire(AWG): 12-28
  - Wire strip length: 8-9mm
  - Withstanding Voltage: 1.5KV
  - Operating temperature: -40°C to +115°C
  - Safety Approval:

N=Number of poles  
Dim L=N×5.08+1.5  
Dim B=(N-1)×5.08

Poles	Dim L	Dim B
1p	±0.15	
2-6p	±0.20	±0.15
7-12p	±0.30	±0.25
13-18p	±0.40	±0.35
19-24p	±0.45	±0.40

PART NO.: HM xx 50 x 100J0 G

No. of poles	Color	RoHS compliant (lead<4%) In copper Alloy
0	Black (RAL9005)	
End Stackable	2 Red (RAL3001/D)	
01 1 poles	3 Orange(RAL2011/P)	
02 2 poles	4 Yellow(RAL1018/A)	
...	5 Green(RAL6018/T)	
24 24 poles	6 Blue (RAL5015/A)	
	8 Grey(RAL7004/P)	
	9 White(RAL1102)	
	C Multiple colors	

mat'l. code				surface	tolerance	projection	product family
itr	ecn	no	dr	ASME Y14.5	ASME Y14.5	ASME Y14.5	TERMINAL BLOCK
				tolerances unless otherwise specified		MM	title
				angles	X.±0.5	MM	TERMINAL BLOCK
				line	X.X±0.3		SPRING CLAMP,90D WIRE INLET,PRESS FIT
				X'±1'	X.XX±0.1	scale	dwg no
				dr	EVIN ZHONG 052914		sheet 1 of 1
				enrg	EVIN ZHONG 052914		size
				chr	HANKE FENG 052914		A4
				appd	SHI JUN 052914		type
				sheet	revision	A	CUSTOMER Drawing
				index	sheet	1	