

## Excellent Integrated System Limited

Stocking Distributor

Click to view price, real time Inventory, Delivery & Lifecycle Information:

[FCI](#)  
[KZ02105100J0G](#)

For any questions, you can email us directly:  
[sales@integrated-circuit.com](mailto:sales@integrated-circuit.com)

PRODUCT NUMBER	PITCH
KZxx10x100J0G	3.50 mm

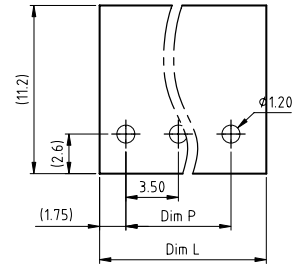
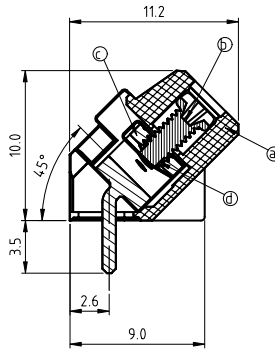
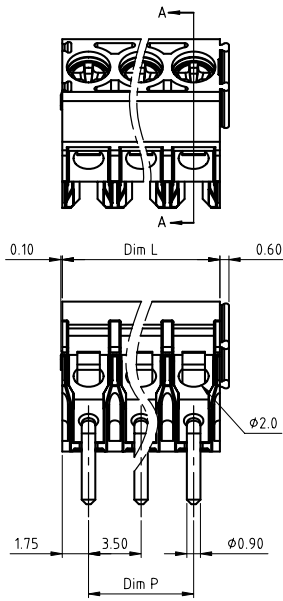

RECOMMENDED P.C.B LAYOUT  
TOP VIEW

Materials  
Item ① Terminal housing : Thermoplastic (UL94V-0)  
Item ② Terminal screw: Steel Zinc plating "+/-" slot type  
Item ③ Wire guard : Stainless steel  
Item ④ Terminal body: Brass(CuZn) ,Tin Plated

- Electrical cULus
- Voltage rating: 300VAC
  - Current rating: 15A
  - Wire rating:
  - Solid wire(AWG): 12-26
  - Stranded wire(AWG): 12-26
  - Torque(Lb-In): 3.5
  - Screw: M2.6
  - Wire strip length: 5-6mm
  - Withstanding Voltage: 1.6KV
  - Operating temperature: -40°C to +115°C
  - Soldering temperature: 260°C±5°C/5 Sec
  - Safety Approval: cULus

N = Number of poles  
Dim L=Nx3.5  
Dim P=(N-1)x3.5

Poles	Dim L	Dim P
2-6p	±0.15	±0.10
7-12p	±0.20	±0.15
13-18p	±0.25	±0.20
19-24p	±0.30	±0.25

PART NO.: KZ xx 1 0 x 1 00J0 G

- |               |                     |                 |
|---------------|---------------------|-----------------|
| End stackable | Body Color          | RoHS compliant  |
| No. of poles  | 0 Black (RAL9005)   | (lead-4%)       |
| 02 2 poles    | 2 Red (RAL3001/D)   | In copper Alloy |
| 03 3 poles    | 3 Orange(RAL2011/P) |                 |
| ...           | 4 Yellow(RAL1018/A) |                 |
| 24 24 poles   | 5 Green(RAL6018/T)  |                 |
|               | 6 Blue (RAL5015/A)  |                 |
|               | 8 Grey(RAL7035/D)   |                 |
|               | 9 White(RAL1102)    |                 |
|               | C Green(RAL6018/U)  |                 |

mat'l. code	surface ASME Y14.5	tolerance ASME Y14.5	projection	product family TERMINAL BLOCK
ltr	ecn	no	dr	date
tolerances unless otherwise specified				title TERMINAL BLOCK
angles	X.±0.5		WIRE PROTECTOR, ROUND HOLE, 45D WIRE INLET	
X'±1'	X.X±0.3		sheet 1 of 1 size	
	X.XX±0.1		A4	
dr	EVIN ZHONG	040314	KZxx10x100J0G	
enr	EVIN ZHONG	040314	CUSTOMER Drawing	
chr	HANKE FENG	040314		
appd	SHI JUN	040314		
sheet index	revision sheet	A 1		