

Excellent Integrated System Limited

Stocking Distributor

Click to view price, real time Inventory, Delivery & Lifecycle Information:

[FCI](#)
[OQ02155000J0G](#)

For any questions, you can email us directly:
sales@integrated-circuit.com

PRODUCT NUMBER	PITCH
OQxx15x000J0G	3.50 mm

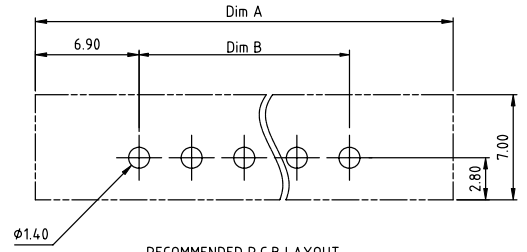
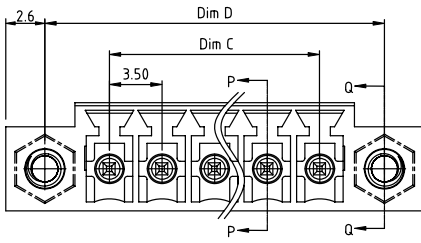

RECOMMENDED P.C.B LAYOUT
TOP VIEW

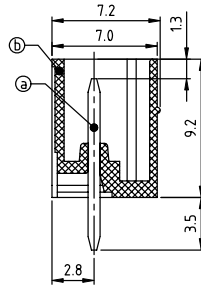
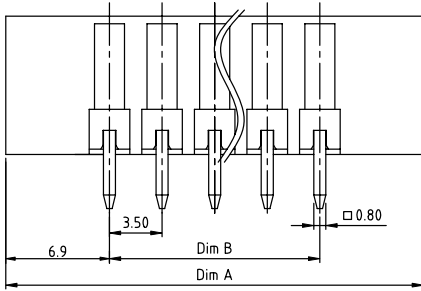

SEC P-P

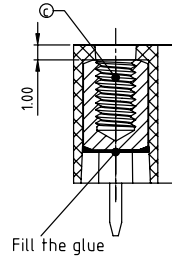

SEC Q-Q

Material:

- Item ① Male contact pin: Copper, Tin plated
- Item ② Terminal housing: Thermoplastic (UL94V-0)
- Item ③ Flange nut: Brass M2.5

Electrical:

- Voltage rating: 300V/300V
- Current rating: 10A/10.5A
- Withstanding Voltage: 1.6 KV/2.5KV
- Operating temperature: -40°C to +115°C
- Soldering temperature: 260°C±5°C/5 Sec
- Safety Approval: cULus /VDE

DIMENSION

Dim A	(N-1)×3.5+13.8
Dim B&C	(N-1)×3.5
Dim D	(N-1)×3.5+8.6

N= Number of poles

Poles	Tol
2p-6p	±0.15
7p-12p	±0.20
13p-16p	±0.25
17p-24p	±0.30

PART NO.: OQ xx 1 5 x 0 00J0 G

No. of poles	Body Color	RoHS compliant
0	Black (RAL9005)	(lead<4%) in copper Alloy
02	2 Red (RAL3001/D)	
03	3 Orange(RAL2011/P)	
...	...	
24	24 Yellow(RAL1018/A)	
	5 Green(RAL6018/T)	
	6 Blue (RAL5015/A)	
	8 Grey(RAL7035/D)	
	9 White(RAL1102)	
	C Green(RAL6018/U)	

mat'l. code	surface ASME Y14.5	tolerance ASME Y14.5	projection	product family TERMINAL BLOCK
ltr	ecn no	dr	date	title TERMINAL BLOCK
tolerances unless otherwise specified				PLUGGABLE SOCKET WITH FLANGE, VERTICAL
angles	mm	mm	mm	scale
X±1°	X.X±0.5	X.X±0.3	X.X±0.1	FCI
dr	HANKE FENG	032614		sheet 1 of 1
enqr	HANKE FENG	032614		size A4
chr	SHI JUN	032614		dwg no OQxx15x000J0G
appd	SHI JUN	032614		type CUSTOMER Drawing
sheet index	revision sheet	A 1		