

## Excellent Integrated System Limited

Stocking Distributor

Click to view price, real time Inventory, Delivery & Lifecycle Information:

[FCI](#)  
[OQ02545000J0G](#)

For any questions, you can email us directly:  
[sales@integrated-circuit.com](mailto:sales@integrated-circuit.com)

PRODUCT NUMBER	PITCH
OQxx54x000J0G	5.08 mm

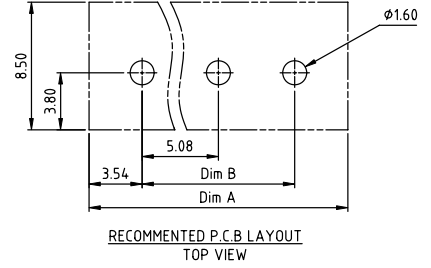
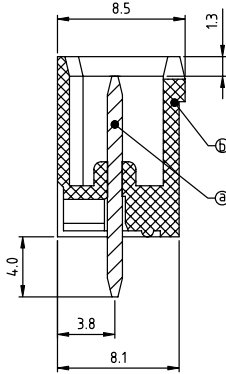
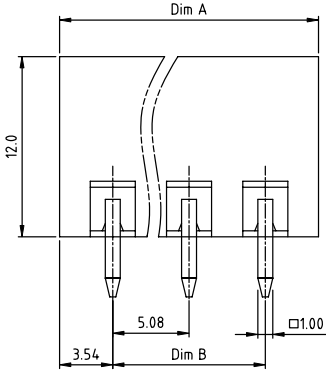
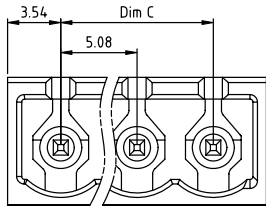

- Material:
- Item ① Male contact pin: Copper Tin plated
  - Item ② Terminal housing: Thermoplastic (UL94V-0)

- Electrical:
- Voltage rating: 300V/300V/300V
  - Current rating: 20A/20A/20A
  - Withstanding Voltage: 1.6 KV/2.5KV/2.5KV
  - Operating temperature: -40°C to +115°C
  - Soldering temperature: 260°C±5°C/5 Sec
  - Safety Approval:

**DIMENSION**

Dim A	N×5.08+2.0
Dim B&C	(N-1)×5.08

N = Number of poles

Poles	Tolerance
2-6p	±0.15
7-12p	±0.20
13-18p	±0.30
19-24p	±0.40

PART NO.: OQ xx 5 4 x 0 00J0 G

No. of poles	Body Color	RoHS compliant
02 2 poles	0 Black (RAL9005)	(lead<4%) In copper Alloy
03 3 poles	2 Red (RAL3001/D)	
...	3 Orange(RAL2011/P)	
...	4 Yellow(RAL1018/A)	
24 24 poles	5 Green(RAL6018/T)	
	6 Blue (RAL5015/A)	
	8 Grey(RAL7035/D)	
	9 White(RAL1102)	
	C Green(RAL6018/U)	

mat'l. code	surface ASME Y14.5 ✓ tolerance unless otherwise specified	tolerance ASME Y14.5 X.±0.5 X.X±0.3 X.XX±0.1	projection MM	product family TERMINAL BLOCK
ltr	ecn no	dr	date	title TERMINAL BLOCK
				PLUGGABLE SOCKET,CLOSE TYPE,VERTICAL
				scale
dr	HANKE FENG	040314		dwg no
enrg	HANKE FENG	040314		sheet 1 of 1
chr	SHI JUN	040314		size A4
appd	SHI JUN	040314		type CUSTOMER Drawing
sheet index	revision sheet	A 1		