

Excellent Integrated System Limited

Stocking Distributor

Click to view price, real time Inventory, Delivery & Lifecycle Information:

[FCI](#)
[VE02305100J0G](#)

For any questions, you can email us directly:
sales@integrated-circuit.com

PRODUCT NUMBER	PITCH
VExx30x100J0G	3.81mm

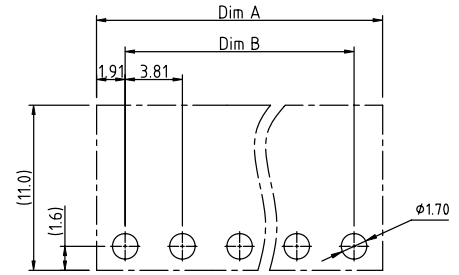
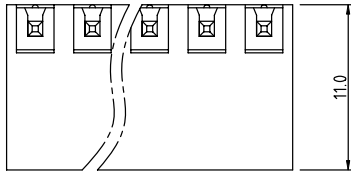

RECOMMENDED P.C.B LAYOUT
TOP VIEW

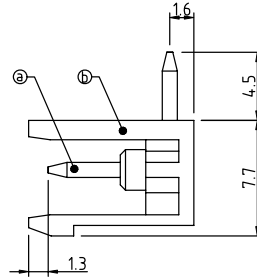
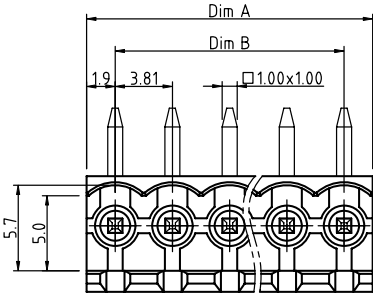

- Material:
- Item ① Contact pin: Copper, Tin plated
 - Item ② Terminal(housing): Thermoplastic (UL94V-0)
- Electrical:
- Voltage rating: 300V
 - Current rating: 8A
 - Withstanding Voltage: 1.6 KV
 - Operating temperature: -40°C to +115°C
 - Soldering temperature: 260°C±5°C/5 Sec
 - Safety Approval: us

DIMENSION

Dim A	N×3.81
Dim B	(N-1)×3.81

N= NUMBER OF POLES

Poles	Tolerance
2P-5P	±0.15
6P-10P	±0.20
11P-15P	±0.25
16P-20P	±0.30
21P-24P	±0.35

PART NO.: VE xx 30 x 1 00J0 G

- | | | | |
|--------------|---|-------------------|-----------------|
| Solid block | 0 | Color | RoHS compliant |
| No. of poles | 2 | Black (RAL9005) | (lead+4%) |
| 02 2 poles | 3 | Red (RAL3001/D) | In copper Alloy |
| 03 3 poles | 4 | Orange(RAL2011/P) | |
| ... | 5 | Yellow(RAL1018/A) | |
| 24 24 poles | 6 | Green(RAL6018/T) | |
| | 7 | Blue (RAL5015/A) | |
| | 8 | Grey(RAL7035/D) | |
| | 9 | White(RAL1102) | |
| | C | Green(RAL6018/U) | |

mat'l. code	surface ASME Y14.5	tolerance ASME Y14.5	projection	product family TERMINAL BLOCK
ltr	ecn	no	dr	date
tolerances unless otherwise specified				title TERMINAL BLOCK
angles	X.±0.5		MM	PLUGGABLE SOCKET,OPEN RIGHT-ANGLE
radius	X.X±0.3		scale	sheet 1 of 1
dr	EVIN ZHONG	042214		size A4
enrg	EVIN ZHONG	042214		dwg no VExx30x100J0G
chr	HANKE FENG	042214		type CUSTOMER Drawing
appd	SHI JUN	042214		
sheet index	revision sheet	A 1		