

Excellent Integrated System Limited

Stocking Distributor

Click to view price, real time Inventory, Delivery & Lifecycle Information:

[FCI](#)
[VF04725100J0G](#)

For any questions, you can email us directly:

sales@integrated-circuit.com

PRODUCT NUMBER	PITCH
VFxx72x100J0G	5.00 mm

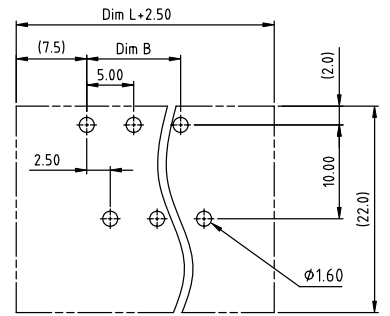
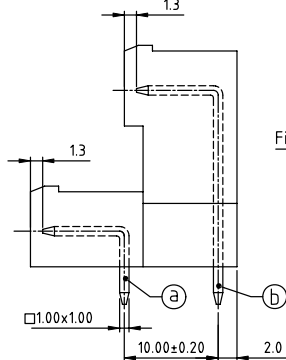
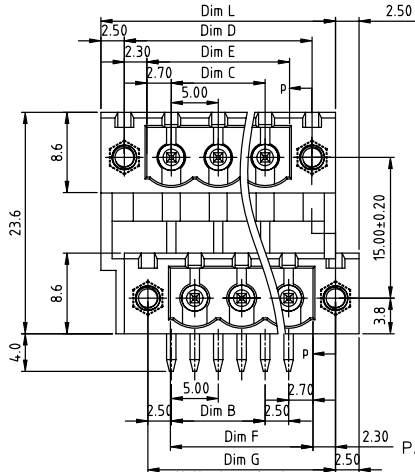
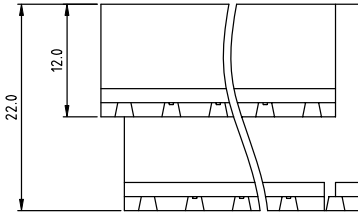

RECOMMENDED P.C.B LAYOUT
TOP VIEW

- Material:**
- Item (a) Short pin: Copper, Tin plated
 - Item (b) Long pin: Copper, Tin plated
 - Item (c) With flange nut: brass M2.5
 - Item (d) Terminal (housing): Thermoplastic (UL94V-0)
- Electrical cULus**
- Voltage rating: 300VAC
 - Current rating: 10A
 - Withstanding Voltage: 1.6KV
 - Operating temperature: -40°C to +115°C
 - Soldering temperature: 260°C±5°C/5 Sec
 - Safety Approval: cULus

PART NO.: VF xx 72 x 1 00J0 G

Dimension	N=Number of poles	Poles	Tolerance
Dim L	(N/2-2)×5.0	2×2P-2×5P	±0.15
Dim B	(N/2-1)×5.0	2×6P-2×10P	±0.20
Dim C	(N/2-1)×5.0	2×11P-2×15P	±0.25
Dim D	(N/2-1)×5.0+10.0	2×16P-2×20P	±0.30
Dim E	(N/2-1)×5.0+5.4	2×21P-2×24P	±0.40
Dim F	(N/2-1)×5.0+5.4		
Dim G	(N/2-1)×5.0+10.0		

- Solid block
No. of poles
04 2x2poles
06 2x3poles
...
48 2x24poles
- Color
0 Black (RAL9005)
2 Red (RAL3001/D)
3 Orange(RAL2011/P)
4 Yellow(RAL1018/A)
5 Green(RAL6018/T)
6 Blue (RAL5015/A)
8 Grey(RAL 7035/D)
9 White(RAL1102)
C Green(RAL6018/U)
- RoHS compliant
(lead<4%)
In copper Alloy

mat'l. code	surface ASME Y14.5	tolerance ASME Y14.5	projection	product family
ltr ecn no dr date	tolerances unless otherwise specified	X.±0.5 X.X±0.3 X.XX±0.1	MM	TERMINAL BLOCK
angles				title
X'±1'				TERMINAL BLOCK
dr EVIN ZHONG 042914				PLUGGABLE SOCKET, WITH FLANGE, RIGHT ANGLE
enrg EVIN ZHONG 042914				dwg no sheet 1 of 1 size
chr HANKE FENG 042914				VFxx72x100J0G A4
appd SHI JUN 042914				type CUSTOMER Drawing
sheet index	revision sheet	A 1		