

Excellent Integrated System Limited

Stocking Distributor

Click to view price, real time Inventory, Delivery & Lifecycle Information:

[FCI](#)
[YC04215000J0G](#)

For any questions, you can email us directly:
sales@integrated-circuit.com

PRODUCT NUMBER	PITCH
YCxx21x000J0G	5.08 mm

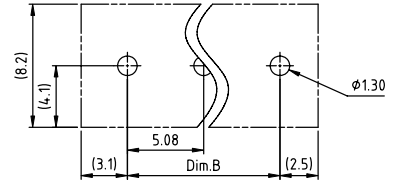
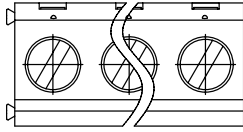

RECOMMENDED P.C.B LAYOUT
TOP VIEW

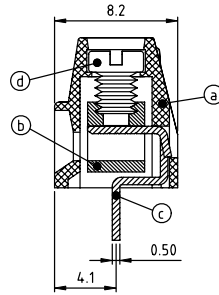
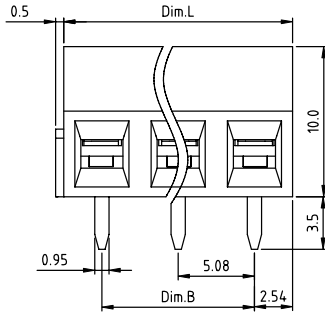

Material:

- Item (a) Terminal housing : Thermoplastic (UL 94V-0)
- Item (b) Clamp : Brass ,Ni plated
- Item (c) Solder pin : Brass ,Tin plated
- Item (d) Terminal screw: Steel Zinc plating"- "slot type

Electrical cULus

- Voltage rating: 300VAC
- Current rating: 10A
- Wire range:
- Solid wire(AWG): 16-26
- Stranded wire(AWG): 16-26
- Torque(Lb-In): 3.5
- Screw: M3.0
- Wire strip length: 6-7mm
- Withstanding Voltage: 1.6KV
- Operating temperature: -40°C to +115°C
- Soldering temperature: 260°C±5°C/5 Sec
- Safety Approval: cULus

N=Number of poles
Dim.L=Nx5.08
Dim.B=(N-1)x5.08

Poles	2-8P	9-15P	16-24P
Dim.B	±0.20	±0.25	±0.30
Dim.L	±0.20	±0.30	±0.40

PART NO.: YC xx 2 1 x 0 00J0 G

End stackable	Color	RoHS compliant (lead-4%) In copper Alloy
0	Black (RAL9005)	
2	Red (RAL3001/D)	
02	2 poles 3 Orange(RAL2011/P)	
03	3 poles 4 Yellow(RAL1018/A)	
...	...	
5	Green(RAL6018/T)	
24	24 poles 6 Blue (RAL5015/A)	
	8 Grey(RAL7035/D)	
	9 White(RAL1102)	
	C Green(RAL6018/U)	

mat'l. code	surface ASME Y14.5	tolerance ASME Y14.5	projection	product family TERMINAL BLOCK
ltr	ecn	no	dr	date
tolerances unless otherwise specified				title TERMINAL BLOCK
angles	X.±0.5		MM	RISING CLAMP,180D WIRE INLET
X'±1'	X.X±0.3		scale	
dr	EVIN ZHONG	040814	FCI	sheet 1 of 1
enr	EVIN ZHONG	040814		size A4
chr	HANKE FENG	040814		dwg no YCxx21x000J0G
appd	SHI JUN	040814		type CUSTOMER Drawing
sheet index	revision sheet	A 1		