

Excellent Integrated System Limited

Stocking Distributor

Click to view price, real time Inventory, Delivery & Lifecycle Information:

[FCI](#)
[YF03215000J0G](#)

For any questions, you can email us directly:
sales@integrated-circuit.com

PRODUCT NUMBER	PITCH
YFxx21x000J0G	5.08mm

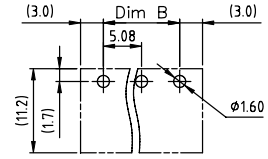
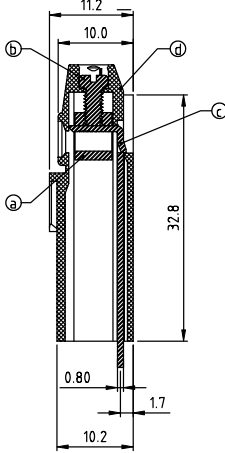
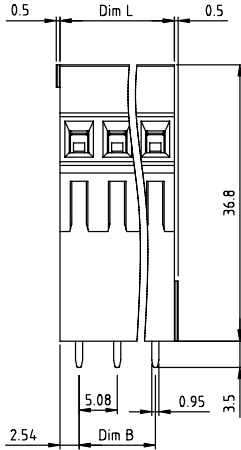
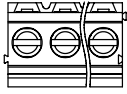

RECOMMENDED P.C.B. LAYOUT
TOP VIEW

Material

- Item ① Clamp : Brass , Ni plated
- Item ② Terminal screw: Steel , Zinc plating "-" slot type
- Item ③ Solder pin : Brass, Tin plated
- Item ④ Terminal housing : Thermoplastic (UL94V-0)

Electrical

- UL
- Voltage rating: 300VAC
- Current rating: 10A
- Wire range:
- Solid wire(AWG): 12-24
- Stranded wire(AWG): 12-24
- Torque(Lb-In): 3.5
- Screw: M2.5
- Wire strip length: 6-7mm
- Withstanding Voltage: 1.6KV
- Operating temperature: -40°C to +115°C
- Soldering temperature: 260°C±5°C/5 Sec
- Safety Approval:

DIMENSION

Dim L	Nx5.08
Dim B	(N-1)x5.08

N=Number of poles

Poles	Dim L & B Tolerance
2P-4P	±0.15
5P-8P	±0.25
9P-16P	±0.35
17P-24P	±0.40

PART NO.: YF xx 2 1 x 0 00J0 G

- | | | | | | |
|---------------|----------|-------|-------------------|-----------------|-----------|
| End stackable | 0 | Color | Black (RAL9005) | RoHS compliant | (lead<4%) |
| No. of poles | 2 | | Red (RAL3001/D) | In copper Alloy | |
| 02 | 2 poles | | Orange(RAL2011/P) | | |
| 03 | 3 poles | | Yellow(RAL1018/A) | | |
| ... | ... | | Green(RAL6018/T) | | |
| 24 | 24 poles | | Blue (RAL5015/A) | | |
| | | | Grey(RAL7035/D) | | |
| | | | White(RAL1102) | | |
| | | | Green(RAL6018/U) | | |

mat'l. code	surface ASME Y14.5	tolerance ASME Y14.5	projection 	product family TERMINAL BLOCK
ltr	ecn	no	dr	date
tolerances unless otherwise specified				title TERMINAL BLOCK
angles	X.±0.5		RISING CLAMP, 180D WIRE INLET, END STACKABLE	
flat	X.X±0.3		sheet 1 of 1	
X'±1'	X.XX±0.1		size A4	
dr	EVIN ZHONG	041014	YFxx21x000J0G	
enr	EVIN ZHONG	041014	type CUSTOMER Drawing	
chr	HANKE FENG	041014		
appd	SHI JUN	041014		
sheet index	revision sheet	A 1		