



Distributor of FCI: Excellent Integrated System Limited

Datasheet of YK22102030J0G - Connector Barrier Block Strip 2 Circuit 0.250" (6.35mm)

Contact us: sales@integrated-circuit.com Website: www.integrated-circuit.com

Excellent Integrated System Limited

Stocking Distributor

Click to view price, real time Inventory, Delivery & Lifecycle Information:

[FCI](#)

[YK22102030J0G](#)

For any questions, you can email us directly:

sales@integrated-circuit.com

Copyright FCI

FCIconnect.com

PRODUCT NUMBER	PITCH
YK221xx0x0J0G	6.35 mm

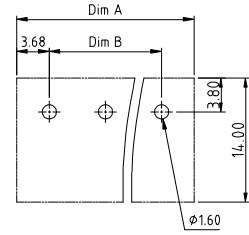
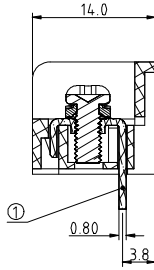
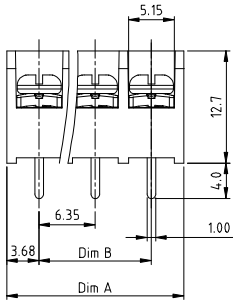
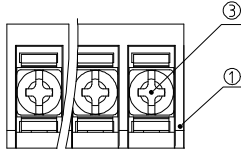

RECOMMENDED P.C.B. LAYOUT
TOP VIEW

MATERIALS & ELECTRICAL

RATED VOLTAGE & CURRENT:	cULus	CQC
WITHSTAND VOLTAGE:	250 V, 10 A /	250 V, 9 A
INSULATION RESISTANCE:	AC 2000 V/Min	
OPERATING TEMPERATURE RANG:	1000 MΩ OR MORE AT DC 500 V	
SCREW TORQUE VALUE:	-40 °C ~ +115 °C	
WIRE RANGE:	5.3 Lb-In.	
1) HOUSING:	22 - 18 AWG	
2) TERMINAL:	Thermoplastic, UL 94 V-0 BLACK	
3) TERMINAL SCREWS:	BRASS, 0.8t	STEEL, M3

APPROVAL:

DIMENSION

Dim A	N*6.35+1.0
Dim B	(N-1)*6.35

N=Number of poles

Poles	Tolerance
2p-5p	±0.20
6p-10p	±0.25
11p-16p	±0.35
17p-24p	±0.40
25p-31p	±0.50

PART NO.: YK 221xx 0 x 0 J0G

Plated		RoHS compliant (lead<4%) In copper Alloy
Code	Terminal Screw	
0	G/F G/F	
1	G/F Zinc	
2	Tin G/F	
3	Tin Zinc	

mat'l. code	surface ASME Y14.5	tolerance ASME Y14.5	projection	product family
ltr	ecn	no	dr	date
tolerances unless otherwise specified				TERMINAL BLOCK
angles	0.010	X,±0.5	MM	title
X'±1'	X,XX±0.1	X,XX±0.3	scale	TERMINAL BLOCK
dr	EVAN LU	061614	FCI	BARRIER TYPE
enqr	EVAN LU	061614		dwg no
chr	HANKE FENG	061614		YK221xx0x0J0G
appd	SHI JUN	061614		sheet 1 of 1
sheet index	revision sheet	A 1		size A4
				type CUSTOMER Drawing

form: A4mmXLC

PDS: Rev :A

STATUS:Released

Printed: Jul 16, 2014