



Distributor of FCI: Excellent Integrated System Limited

Datasheet of YK44A02030J0G - Connector Barrier Block Strip 2 Circuit 0.374" (9.50mm)

Contact us: sales@integrated-circuit.com Website: www.integrated-circuit.com

Excellent Integrated System Limited

Stocking Distributor

Click to view price, real time Inventory, Delivery & Lifecycle Information:

[FCI](#)

[YK44A02030J0G](#)

For any questions, you can email us directly:

sales@integrated-circuit.com

Copyright FCI

FCIconnect.com

PRODUCT NUMBER	PITCH
YK44Axx0x0J0G	9.50 mm

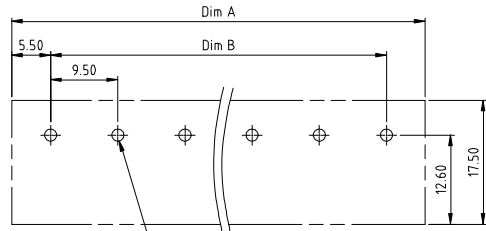
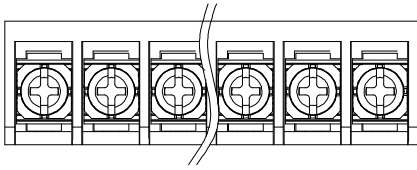

RECOMMENDED P.C.B. LAYOUT
TOP VIEW

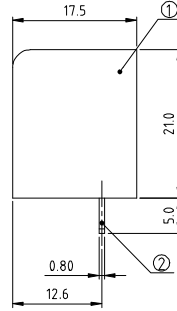
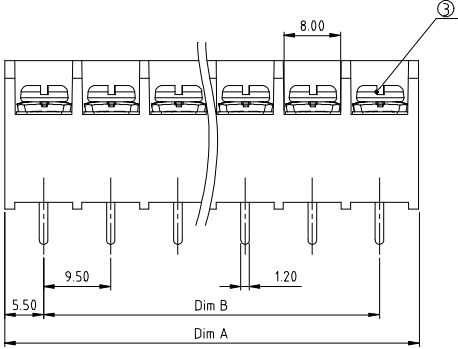

MATERIALS & ELECTRICAL
RATED VOLTAGE & CURRENT: 300V 25A
WITHSTAND VOLTAGE: AC2000V/min
INSULATION RESISTANCE: 1000 MΩ OR MORE AT DC 500 V
OPERATING TEMPERATURE RANG: -40 °C ~ +115 °C
SCREW TORQUE VALUE: 10.54 Lb-In
WIRE RANGE: 22-12 AWG
1) HOUSING: Thermoplastic, UL 94 V-0 BLACK
2) TERMINAL: BRASS, 0.8t
3) TERMINAL SCREWS: STEEL, M3.5

DIMENSION

Dim A	N×9.5±1.5
Dim B	(N-1)×9.5

N=Number of poles

Poles	Tolerance
2p-4p	±0.20
5p-8p	±0.25
9p-16p	±0.35
17p-23p	±0.40
24p-30p	±0.50

PART NO.: YK 44Axx 0 x 0 JOG

No. of poles	Plated		RoHS compliant (lead<4% In copper Alloy)
	Code	Terminal Screw	
02 2 poles	0	G/F G/F	
03 3 poles	1	G/F Zinc	
...	2	Tin G/F	
30 30 poles	3	Tin Zinc	

mat'l. code	surface ASME Y14.5 ✓	tolerance ASME Y14.5	projection	product family
ltr	ecn no	dr	date	TERMINAL BLOCK
tolerances unless otherwise specified				title
angles	X.±0.5			TERMINAL BLOCK
X'±1"	X.X±0.3			BARRIER TYPE
	X.XX±0.1			scale
dr	EVAN LU	061614		FCI
enrg	EVAN LU	061614		dwg no
chr	HANKE FENG	061614		YK44Axx0x0J0G
appd	SHI JUN	061614		sheet 1 of 1
sheet index	revision sheet	A	1	size A4
				type CUSTOMER Drawing

form: A4mmXLC

PDS: Rev :A

STATUS:Released

Printed: Jul 16, 2014