

Excellent Integrated System Limited

Stocking Distributor

Click to view price, real time Inventory, Delivery & Lifecycle Information:

[E-Switch](#)
[KO103C701](#)

For any questions, you can email us directly:

sales@integrated-circuit.com

SHEET 1 OF 1

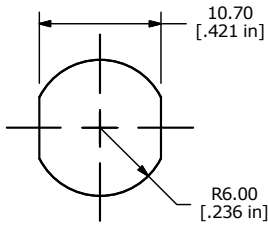

RECOMMENDED PANEL CUTOUT

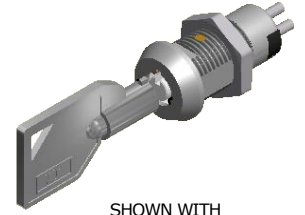
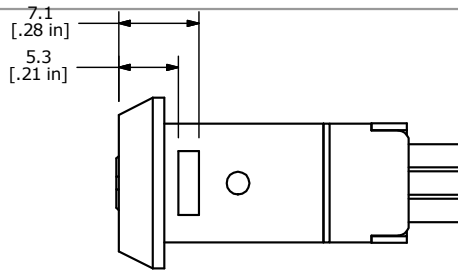

SHOWN WITH PROVIDED HEX NUT

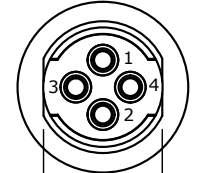
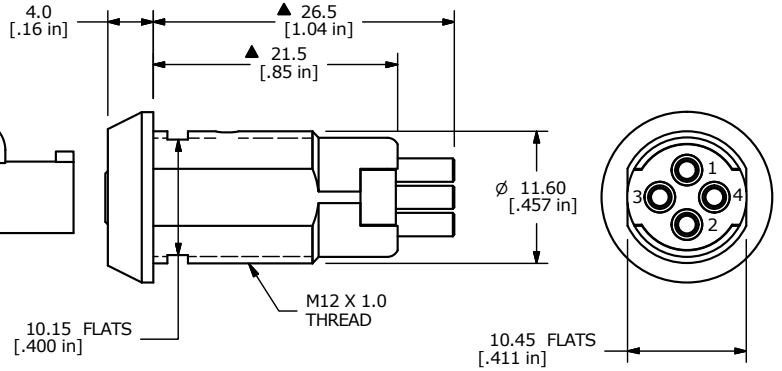
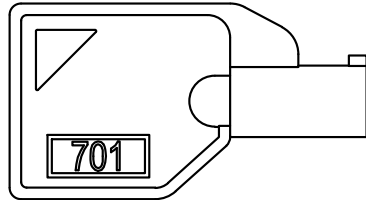
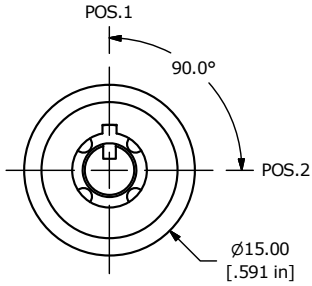

- NOTE:
1. DIMENSIONS IN MM [INCH]
 2. GENERAL TOLERANCE: X.X = ± 0.4
X.XX = ± 0.25
 3. TERMINAL NUMBERS FOR REF ONLY
 4. CONTACT RATINGS: 1A @ 125VAC, 0.5A @ 250VAC
 5. CONTACT RESISTANCE: 10mΩ MAX.
 6. INSULATION RESISTANCE: 200MΩ MIN.
 7. DIELECTRIC STRENGTH: 1,000VAC FOR 1 MINUTE
 8. ▲ DENOTES CRITICAL PARAMETER
 9. MATERIALS:
HOUSING: ZINC ALLOY CAST
CYLINDER: ZINC ALLOY W/ CHROME PLATING
TERMINAL AND CONTACTS: SILVER PLATED
KEY: TUBULAR - ZINC ALLOY WITH CHROME PLATING
 10. PANEL THICKNESS: 10MM MAX.
 - ▲ 11. KEYCODE: 701 (QTY. 2)

LEGEND

- ⊙ = KEY PULL POSSIBLE IN THESE POSITIONS
- = DETENT POSITIONS

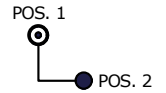

SWITCH FUNCTION	
CONNECTED TERMINAL #	
POS.1	POS.2
ON	ON
1-2	3-4

▲ CIRCUIT: SPDT (90° INDEXING) CONTACT CONFIGURATION

C	22207	UPDATED AND REDRAWN IN INVENTOR	3/16/16	MJR
B	14336	CORRECT SIDE VIEW	9/22/04	AR
A	11743	RELEASED FOR PRODUCTION	10/15/01	CJB
REV	PCR NO	DESCRIPTION	DATE	BY



TITLE KO103C-701

SCALE	2:1	DATE	10/15/2001	DR	AS	DWG	K100204	REV	C
-------	-----	------	------------	----	----	-----	---------	-----	---

THE INFORMATION CONTAINED IN THIS DOCUMENT IS PROPRIETARY TO E-SWITCH AND IS NOT TO BE COPIED OR TRANSFERRED