

Excellent Integrated System Limited

Stocking Distributor

Click to view price, real time Inventory, Delivery & Lifecycle Information:

[Molex Connector Corporation](#)
[0348033214](#)

For any questions, you can email us directly:

sales@integrated-circuit.com

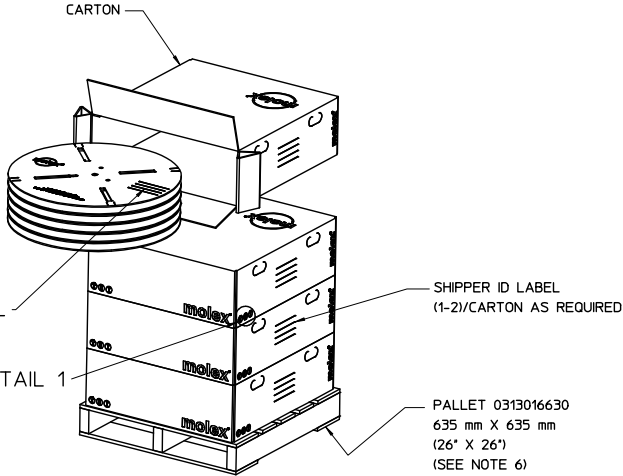

CUSTOMER COPY

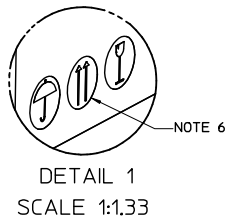

PAYOFF DIRECTION D

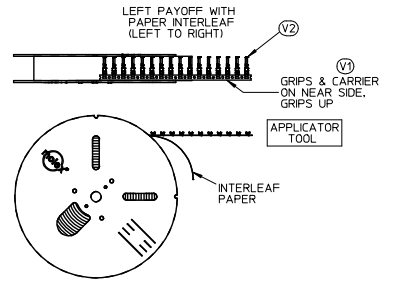

PLACE PRODUCT ID LABEL ON THIS SIDE TO INDICATE THE PREFERRED PACKAGING ORIENTATION

PAYOFF DIRECTION B

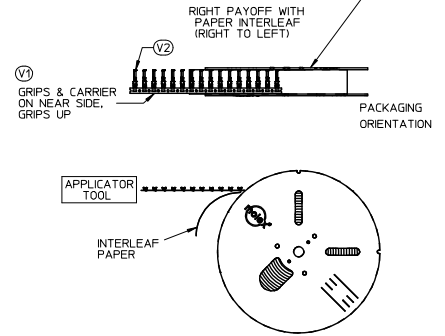

- NOTES:
1. NUMBER OF TERMINALS PER REEL: SEE TABLE (SHEET 2)
 2. STANDARD PACK QUANTITY (SPO): SEE TABLE (SHEET 2)
 3. NUMBER OF REELS PER CARTON: SEE TABLE (SHEET 2)
 4. SPLICING: NO BREAKS, MAXIMUM 1 WELD PER REEL
 5. TO MINIMIZE STRESS ON TERMINALS, REELS SHOULD ALWAYS BE SHIPPED ON PALLETS WITH THE REELS LAYING FLAT AS SHOWN.
 6. PLACE CARTONS ON PALLET WITH ARROWS POINTING UP PER DETAIL 1
 7. FOR INTERNAL COPY SEE: PK-31301-053

| SPO CORRECTION EC NO: 0402015-0955 DRAWN BY: PPHHELPS CHKD: JNORTHRO APPR: JNORTHRO REV: 4 | DESCRIPTION 2014/12/19 2015/01/26 | QUALITY SYMBOLS | GENERAL TOLERANCES (UNLESS SPECIFIED) | DIMENSION STYLE | SCALE | DESIGN UNITS | THIRD ANGLE PROJECTION | | | | | | | | | | | | | | | |
|---|---|--|---|------------------|-------|--------------|------------------------|-------|-------|----------|-------|-------|----------|-------|-------|---------|-------|-------|---------|------|--------|--|
| | | $\nabla=0$ $\sphericalangle=0$ | <table border="1"> <tr> <th></th> <th>mm</th> <th>INCH</th> </tr> <tr> <td>4 PLACES</td> <td>± ---</td> <td>± ---</td> </tr> <tr> <td>3 PLACES</td> <td>± ---</td> <td>± ---</td> </tr> <tr> <td>2 PLACES</td> <td>± ---</td> <td>± ---</td> </tr> <tr> <td>1 PLACE</td> <td>± ---</td> <td>± ---</td> </tr> </table> | | mm | INCH | 4 PLACES | ± --- | ± --- | 3 PLACES | ± --- | ± --- | 2 PLACES | ± --- | ± --- | 1 PLACE | ± --- | ± --- | MM ONLY | 1:10 | METRIC | |
| | | | mm | INCH | | | | | | | | | | | | | | | | | | |
| | | 4 PLACES | ± --- | ± --- | | | | | | | | | | | | | | | | | | |
| 3 PLACES | ± --- | ± --- | | | | | | | | | | | | | | | | | | | | |
| 2 PLACES | ± --- | ± --- | | | | | | | | | | | | | | | | | | | | |
| 1 PLACE | ± --- | ± --- | | | | | | | | | | | | | | | | | | | | |
| DRAWN BY: PPHHELPS DATE: 2012/10/24 | CHECKED BY: _____ DATE: _____ | TITLE CTX PACKAGING SPEC GEN. MRKT. PRODUCT CUSTOMER COPY | | | | | | | | | | | | | | | | | | | | |
| APPROVED BY: JNORTHRO DATE: 2012/11/26 | MATERIAL NO. _____ | MOLEX INCORPORATED | DOCUMENT NO. SD-31301-053 | SHEET NO. 1 OF 2 | | | | | | | | | | | | | | | | | | |

DRAFT WHERE APPLICABLE MUST REMAIN WITHIN DIMENSIONS

SIZE C THIS DRAWING CONTAINS INFORMATION THAT IS PROPRIETARY TO MOLEX INCORPORATED AND SHOULD NOT BE USED WITHOUT WRITTEN PERMISSION

| PACKAGING DATA | | | | | | | | | | | |
|-----------------------|--|-------|--------------------------|-------|------------|-------|-------|----------------|-------|-------|-------|
| PRODUCT DESCRIPTION | CTX 64 | | | | CTX 150 | | | CTX 280 SEALED | | | |
| PRODUCT P/N SERIES | 0348030*** 0348031*** 0348032*** | | 0348033*** 0348035*** | | 034805**** | | | 034808**** | | | |
| GRIP CODE | S | L | S | L | S | M | L | VS | S | M | L |
| PART WT (Kg/1000) | .1552 | .1642 | .126 | .126 | .3070 | .3270 | .3470 | .6596 | .6886 | .7106 | .7332 |
| STAND PACK QTY (SPQ) | 60000 | 60000 | 60000 | 60000 | 35000 | 30000 | 25000 | 10000 | 10000 | 10000 | 10000 |
| QTY/REEL | 10000 | 10000 | 10000 | 10000 | 7000 | 6000 | 5000 | 2000 | 2000 | 2000 | 2000 |
| REELS/SHIPPER CARTON | 6 | 6 | 6 | 6 | 5 | 5 | 5 | 5 | 5 | 5 | 5 |
| CARTONS/PALLET (MAX) | 5 | 5 | 5 | 5 | 5 | 5 | 5 | 5 | 5 | 5 | 5 |
| FILLED CARTON WT (Kg) | 14.83 | 15.37 | TBD | TBD | 15.64 | 14.70 | 13.57 | 11.5 | 11.8 | 12.0 | 12.2 |
| FLANGE DIAMETER (MM) | 610 | 610 | 610 | 610 | 610 | 610 | 610 | 610 | 610 | 610 | 610 |

CUSTOMER COPY

| | | | | | | |
|---|-----------------|---|---|-------|--------------|---|
| SPO CORRECTION EC NO: JAU2015-0955 DRAWN BY: PPHELPS 2014/12/19 CHKD: JNORTHRO 2015/01/26 APPR: JNORTHRO 2015/01/26 REV: 4 | QUALITY SYMBOLS | GENERAL TOLERANCES (UNLESS SPECIFIED) | DIMENSION STYLE | SCALE | DESIGN UNITS | THIRD ANGLE PROJECTION |
| | ▽=0 ▽=0 | mm INCH 4 PLACES ± --- ± --- 3 PLACES ± --- ± --- 2 PLACES ± --- ± --- 1 PLACE ± --- ± --- ANGULAR ± 1 ° | MM ONLY DRAWN BY: PPHELPS DATE: 2012/10/24 CHECKED BY: DATE: | 1:15 | METRIC | TITLE: CTX PACKAGING SPEC GEN. MRKT. PRODUCT CUSTOMER COPY |
| | | DRAFT WHERE APPLICABLE MUST REMAIN WITHIN DIMENSIONS | APPROVED BY: JNORTHRO DATE: 2012/11/26 MATERIAL NO. SEE TABLE SIZE: C THIS DRAWING CONTAINS INFORMATION THAT IS PROPRIETARY TO MOLEX INCORPORATED AND SHOULD NOT BE USED WITHOUT WRITTEN PERMISSION | | | MOLEX INCORPORATED DOCUMENT NO. SD-31301-053 SHEET NO. 2 OF 2 |
| | | | | | | |

TIN CONTACT SHAPE

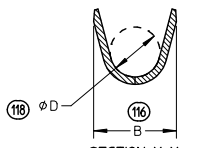

SECTION Y-Y
SCALE 10:1
INSULATION GRIP

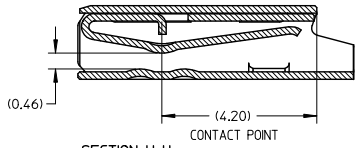

SECTION U-U
SCALE 10:1
CONTACT POINT

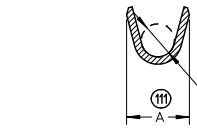

SECTION Z-Z
SCALE 10:1
CONDUCTOR GRIP

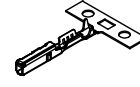
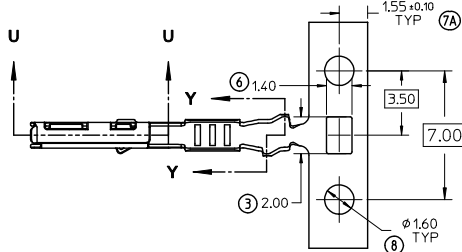

ISO VIEWS
NOT TO SCALE

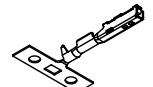

NOTES: (UNLESS OTHERWISE SPECIFIED)

1. MATERIAL: COPPER ALLOY
2. PLATING MARK: TIN (Sn) - NO MARK
SILVER (Ag) - A
3. PACKAGING PER SD-31301-053
4. CRIMPING PER AS-502306-002
5. PROBING AT ANY LOCATION ON THE
TERMINAL BEAM IS NOT PERMITTED
6. PRODUCT SPECIFICATION PER
PS-502306-001
7. ANTI-TARNISH TREATMENT FOR SILVER
PLATED AREA: SYNTHETIC HYDROCARBON
CONTACT SURFACE FINISH OR EQUIVALENT

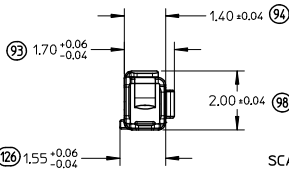
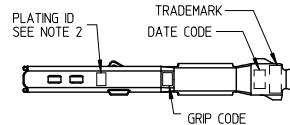

SCALE 8:1

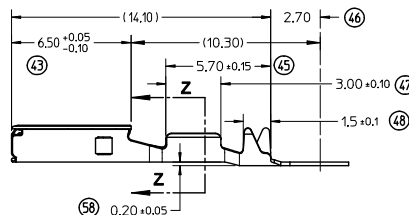

SILVER CONTACT SHAPE

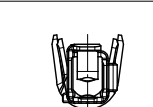

SCALE 8:1

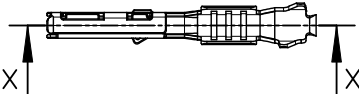
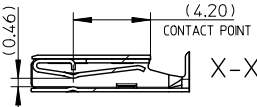

| FAMILY | GENDER | SEALING | PLATING | PART NO | PAYOFF DIRECTION | GRIP CODE | WIRE SIZES* | A | B | C | D | SPECIAL CHARACTERISTICS |
|------------|------------|----------|--------------------------|------------|------------------|-----------|--------------------------|-------------------------|------------|------------|------------|--------------------------|
| CTX64 | RECEPTACLE | MAT SEAL | Sn | 34803-3211 | LEFT (D) | S | 22AWG | ± 0.20 | ± 0.30 | ± 0.10 | ± 0.20 | STANDARD PERFORMANCE TIN |
| | | | | 34803-3213 | RIGHT (B) | S | 0.22-0.35mm ² | 1.80 | 2.40 | 0.90 | 1.36 | STANDARD PERFORMANCE TIN |
| | | | | 34803-3212 | LEFT (D) | L | 20AWG | 2.15 | 2.50 | 1.20 | 1.72 | STANDARD PERFORMANCE TIN |
| | | | | 34803-3214 | RIGHT (B) | L | 0.50-0.85mm ² | 2.15 | 2.50 | 1.20 | 1.72 | STANDARD PERFORMANCE TIN |
| | | | | 34803-5303 | LEFT (D) | S | 22AWG | 1.80 | 2.40 | 0.90 | 1.36 | HIGH PERFORMANCE SILVER |
| | | | | 34803-5307 | RIGHT (B) | S | 0.22-0.35mm ² | 1.80 | 2.40 | 0.90 | 1.36 | HIGH PERFORMANCE SILVER |
| 34803-5305 | LEFT (D) | L | 20AWG | 2.15 | 2.50 | 1.20 | 1.72 | HIGH PERFORMANCE SILVER | | | | |
| 34803-5309 | RIGHT (B) | L | 0.50-0.85mm ² | 2.15 | 2.50 | 1.20 | 1.72 | HIGH PERFORMANCE SILVER | | | | |

* SEE AS-502306-002 FOR SPECIFIC WIRE TYPES

| | | | | | | | | | | | |
|---|---|---|--------------|-----------------|------------|---------------------------|--------------|------------------------|--|--|--|
| ADD SILVER CONTACT P/N EC NO: 62016-0163 DRAWN BY: JGUS CHKD BY: BMOSE APPR: JPLESSIS 2016/06/06 2016/06/13 | QUALITY SYMBOLS $\nabla=0$ $\nabla=0$ $\nabla=0$ | GENERAL TOLERANCES (UNLESS SPECIFIED) | | DIMENSION STYLE | | SCALE | DESIGN UNITS | THIRD ANGLE PROJECTION | | | |
| | | | | MM ONLY | | 5:1 | METRIC | | | | |
| | | | | DRAWN BY | DATE | TITLE | | | | | |
| | | | | AKARANA | 2013/03/05 | CTX64 RECEPTACLE TERMINAL | | | | | |
| | | CHECKED BY | DATE | | | | | | | | |
| | | ADHIR | 2013/06/05 | | | | | | | | |
| | | APPROVED BY | DATE | | | | | | | | |
| | | BMOSE | 2013/06/27 | | | | | | | | |
| | | MATERIAL NO. | DOCUMENT NO. | | | | | | | | |
| | | SEE TABLE | SD-34803-002 | | | | | | | | |
| | | SIZE | | | | | | | | | |
| | | B | | | | | | | | | |
| | | THIS DRAWING CONTAINS INFORMATION THAT IS PROPRIETARY TO MOLEX INCORPORATED AND SHOULD NOT BE USED WITHOUT WRITTEN PERMISSION | | | | | | | | | |