

Excellent Integrated System Limited

Stocking Distributor

Click to view price, real time Inventory, Delivery & Lifecycle Information:

[Molex Connector Corporation](#)
[1726460413](#)

For any questions, you can email us directly:

sales@integrated-circuit.com

MATERIAL NUMBER	MOUNTING OPTION	COLOR	CKT. SIZE	DIM A	DIM B	DIM C	DIM D	
172646-0212	W/EARS	BLACK	2	.378 (9.60)	.165 (4.20)	.394 (10.00)	.591 (15.00)	
172646-0213	NO EARS		4	.709 (18.00)	.496 (12.60)	.724 (18.40)	.921 (23.40)	
172646-0412	W/EARS		5	.874 (22.20)	.661 (16.80)	.890 (22.60)	1.087 (27.60)	
172646-0413	NO EARS		6	1.039 (26.40)	.827 (21.00)	1.055 (26.80)	1.252 (31.80)	
172646-0512	W/EARS		NATURAL (BEIGE)	2	.378 (9.60)	.165 (4.20)	.394 (10.00)	.591 (15.00)
172646-0513	NO EARS			4	.709 (18.00)	.496 (12.60)	.724 (18.40)	.921 (23.40)
172646-0502	W/EARS	5		.874 (22.20)	.661 (16.80)	.890 (22.60)	1.087 (27.60)	
172646-0503	NO EARS	6		1.039 (26.40)	.827 (21.00)	1.055 (26.80)	1.252 (31.80)	
172646-0602	W/EARS							
172646-0603	NO EARS							

X = NOT TOOLED

LEGEND

172646-*** **
 SERIES NO
 CIRCUIT SIZE (04-05)
 MATERIAL OPTION: SEE NOTE 1
 MOUNTING AND LOCK OPTION:
 2=WITH EARS, SINGLE ROW
 3=WITHOUT EARS, SINGLE ROW

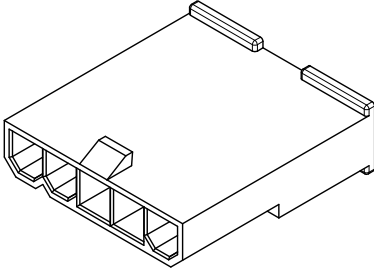
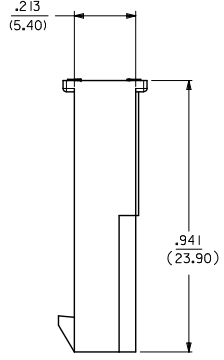
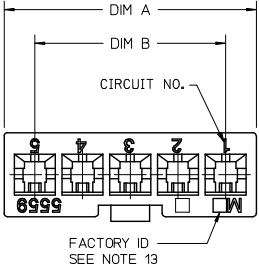

NOTES:

- MATERIAL:
 "0" = NYLON, UL94V-2, COLOR: NATURAL (BEIGE); IEC 60335-1, 5th EDITION GLOW WIRE CAPABLE.
 "1" = NYLON, UL94V-2, COLOR: BLACK; IEC 60335-1, 5th EDITION GLOW WIRE CAPABLE.
- FINISH: NOT APPLICABLE
- PRODUCT SPECIFICATION: PS-5556-001
- PACKAGING: BULK PER PK-5559-003
- PART MATES WITH MOLEX RECEPTACLE #46994.
- PART TO BE USED WITH MOLEX MALE TERMINAL #5558.
- PART IS NOT DESIGNED FOR CURRENT SHARING.
- CONNECTORS ARE NOT TO BE MATED OR UNMATED WHILE CIRCUITS ARE LIVE.
- WIRES ARE TO BE DRESSED IN SUCH A MANNER TO ALLOW THE TERMINALS TO FLOAT FREELY IN THE POCKET.
- PANEL MOUNT VERSION IS FOR USE WITH .031-.079(0.80/2.00) THICK PANELS.
- PANEL SHOULD BE PUNCHED IN THE DIRECTION OF CONNECTOR INSERTION.
- PART CONFORMS TO CLASS "B" REQUIREMENTS OF COSMETIC SPECIFICATION PS-45499-002 WITH THE EXCEPTION OF DISCOLORATION, FLASH AND SINK MEET CLASS "C" REQUIREMENTS.
- FACTORY ID MAY BE LOCATED ON EARS.

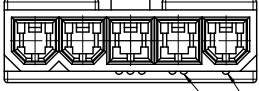

CIRCUIT #1 RIB
 CIRCUIT #2 RIBS
 5 CKT WITHOUT MOUNTING EARS SHOWN

ADD NATURAL P/NS EC NO: UCP2016-0359 DRWNG: JMBELL 2015/07/31 CHKD: JMBELL 2015/07/31 APPR: F SMITH 2015/08/14	QUALITY SYMBOLS ▽=0 ▽=0 ▽=0	GENERAL TOLERANCES (UNLESS SPECIFIED) mm INCH 4 PLACES ± .010 ± .0004 3 PLACES ± .025 ± .0010 2 PLACES ± 0.38 ± .0150 1 PLACE ± .010 ± .0004	DIMENSION STYLE IN/MM	SCALE 4:1	DESIGN UNITS METRIC	THIRD ANGLE PROJECTION	TITLE MINI-FIT JR. SERIES PLUG SINGLE ROW (GLOW WIRE)	MATERIAL NO. SEE CHART	DOCUMENT NO. SD-172646-0000	SHEET NO. 1 OF 2

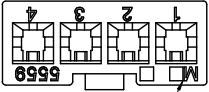

FACTORY ID
SEE NOTE 13

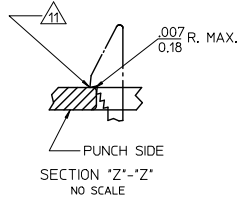
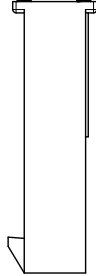
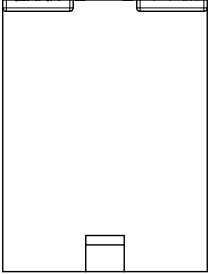

SEE NOTE 13

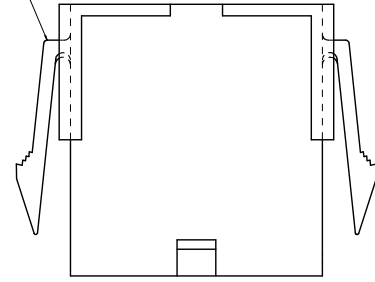

WITH MOUNTING EARS

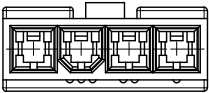

4 CKT WITHOUT
MOUNTING EARS SHOWN

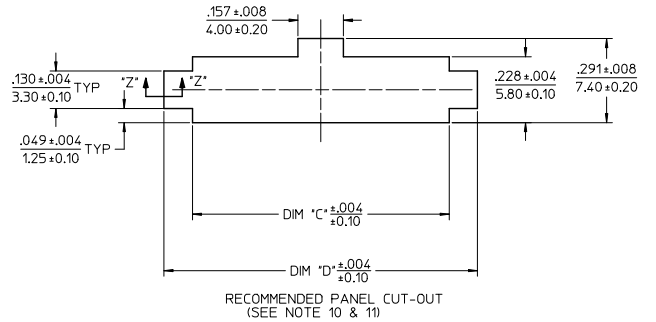

SEE SHEET 1 EC NO: UCP2016-0359 DRAWN BY: JHONTI 2015/07/31 CHECKED BY: JBELL 2015/07/31 APPROVED BY: F-SMITH 2015/08/14	QUALITY SYMBOLS ∇=0 ∇=0 ∇=0	GENERAL TOLERANCES (UNLESS SPECIFIED)		DIMENSION STYLE IN/MM		SCALE 1:1	DESIGN UNITS METRIC	THIRD ANGLE PROJECTION
		mm	INCH	DRAWN BY	DATE	TITLE	MINI-FIT JR. SERIES PLUG SINGLE ROW (GLOW WIRE)	
A3 REV	4 PLACES	± .01	± .01	NGUYEN	2013/04/11	molex SD-172646-0000 SHEET NO. 2 OF 2		
	3 PLACES	± .01	± .01	CHECKED BY	DATE			
	2 PLACES	± 0.25	± .015	JBELL	2013/04/11			
	1 PLACE	± 0.38	± .01	APPROVED BY	DATE			
	0 PLACE	±	±	F-SMITH	2014/05/16	MATERIAL NO. DOCUMENT NO.		
DRAFT WHERE APPLICABLE MUST REMAIN WITHIN DIMENSIONS		ANGULAR ± 1/2°		SEE SHEET 1		THIS DRAWING CONTAINS INFORMATION THAT IS PROPRIETARY TO MOLEX INCORPORATED AND SHOULD NOT BE USED WITHOUT WRITTEN PERMISSION		