

Excellent Integrated System Limited

Stocking Distributor

Click to view price, real time Inventory, Delivery & Lifecycle Information:

[FCI](#)

[51772-033LF](#)

For any questions, you can email us directly:

sales@integrated-circuit.com

PRODUCT NO.	ROWS	SIGNAL						POWER						
		E2	6	5	4	3	2	1	P6	P5	P4	P3	P2	P1
51772-033- NOTE 3	D C B A	H	H	H	H	H	H	PA	PA	PA	PA	PA	PA	
		G	G	G	G	G	G							
		F	F	F	F	F	F							
		E	E	E	E	E	E							

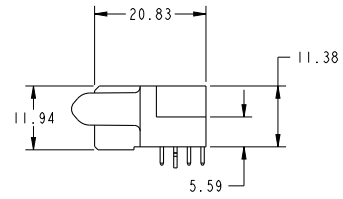
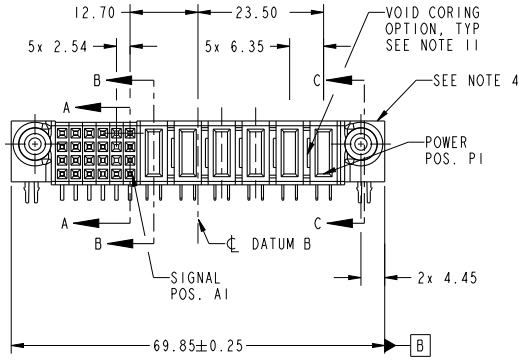

CODE	DIM "M" MATING LENGTH	CONTACT TYPE
PA	[1.07]	POWER
H	[N/A]	SIGNAL
G	[N/A]	SIGNAL
F	[N/A]	SIGNAL
E	[N/A]	SIGNAL
HA	[N/A]	HOLD-DOWN
X		OMITTED

spec ref	SEE NOTES		dr	De-Ming Lu	2014/04/29	projection	MM		size	A4	scale	1:1
tolerance std	TOLERANCES UNLESS OTHERWISE SPECIFIED		eng	De-Ming Lu	2014/05/06				ecn no	-		
SEE NOTES			chr	-	-				rel level	Released		
surface	<input checked="" type="checkbox"/> linear <input type="checkbox"/> angular	0.X	±0.50		title 6P + 24S R/A SOLDER RECEPTACLE	product family PwrBlade	dwg no 51772-033	rev A				
		0.XX	±0.25									
		0.XXX	±0.10									
		0°	±2°	www.fci.com	cat. no.	Product - Customer Drw		sheet 1 of 4				

Prod File - REC - 2009-06-09

1

2

3

PDS: Rev :A

STATUS:Released

Printed: May 06, 2014



Copyright FCI.

PRODUCT NUMBER
51772-033...
NOTE 3

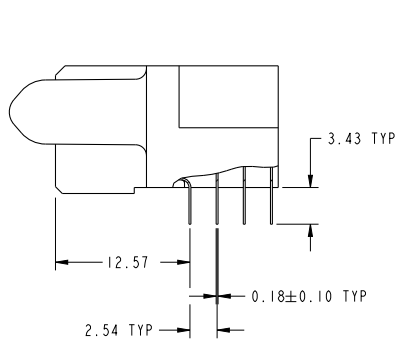

BROKEN-OUT SECTION A-A
SCALE 2:1

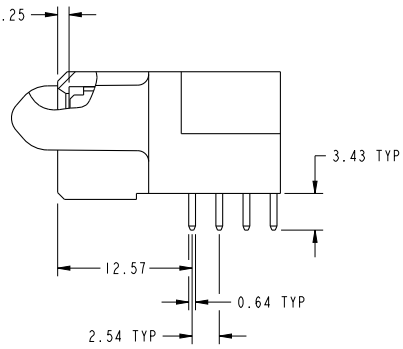

BROKEN-OUT SECTION B-B
SCALE 2:1

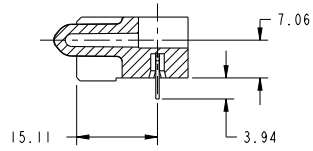

SECTION C-C

dr	De-Ming Lu	2014/04/29	projection	MM	size	A4	scale	1:1
eng	De-Ming Lu	2014/05/06			ecn no	-		
chr	-	-	product family	PwrBlade	rel level	Released		
appr	Pei-Ming Zheng	2014/05/06			cat. no.	6P + 24S R/A SOLDER RECEPTACLE		rev A
www.fci.com			Product - Customer Drw			sheet 2 of 4		

Print File : REC - 2009-06-09

PDS: Rev :A

STATUS:Released

Printed: May 06, 2014



Copyright FCI.

PRODUCT NUMBER
51772-033...
NOTE 3

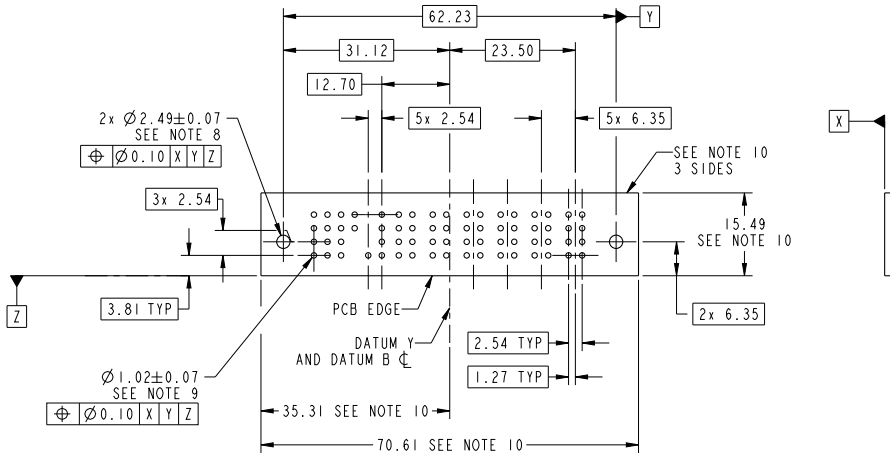

RECOMMENDED PCB LAYOUT

dr	De-Ming Lu	2014/04/29	projection	MM	size	A4	scale	1:1
eng	De-Ming Lu	2014/05/06			ecn no	-		
chr	-	-	product family	PwrBlade	rel level	Released		
appr	Pei-Ming Zheng	2014/05/06			title	6P + 24S R/A SOLDER RECEPTACLE		dwg no 51772-033 rev A
www.fci.com			cat. no.	Product - Customer Drw			sheet 3 of 4	

Prod File - REC - 2009-06-09

PRODUCT NUMBER

51772-033...
NOTE 3

NOTES:

1. DIMENSIONS AND TOLERANCES ARE IN ACCORDANCE WITH ASME Y14.5M, 1994 UNLESS OTHERWISE SPECIFIED.

CONNECTOR NOTES:

- 2. HOUSING MATERIAL: UL 94 V-0 GLASS FILLED HIGH-TEMP THERMOPLASTIC
POWER CONTACT MATERIAL: COPPER ALLOY
SIGNAL PIN MATERIAL: COPPER ALLOY
- 3. SEE ITEM 5 & 6 IN PRINT 10064183 FOR PLATING SPEC OF 51772-033 AND 51772-033LF RESPECTIVELY.

4. MANUFACTURER'S NAME, DATE CODE AND OPTIONAL P/N TO APPEAR ON THIS SURFACE. THE MARK CAN BE OMITTED IF THERE IS NOT ENOUGH SPACE ON THIS SURFACE.

5. PRODUCT SPECIFICATION GS-12-149.
APPLICATION SPECIFICATION BUS-20-067.

6. PACKAGED IN TRAYS.

PCB NOTES:

7. ALL HOLE DIAMETERS ARE FINISHED HOLE SIZE.

8. MOUNTING HOLES, WHERE APPLICABLE, ARE UNPLATED.

9. $\varnothing 1.151 \pm 0.025$ DRILLED HOLES PLATED WITH 0.008 MIN SnPb OR Sn OVER 0.03 TO 0.08 Cu PLATING TO ACHIEVE $\varnothing 1.02 \pm .07$ HOLE.

10. CONNECTOR KEEP-OUT ZONE.

11. THE VOID CORING IN BETWEEN POWER MODULES, SIGNAL MODULES AND END MODULES ARE OPTIONAL AND THE SHAPE MAY BE DIFFERENT FOR OPTIMIZE THE MOLDING PROCESS. THE VOID CORING WILL NOT EFFECT TO PRODUCT FUNCTION.

dr	De-Ming Lu	2014/04/29	projection	MM	size	A4	scale	1:1	
eng	De-Ming Lu	2014/05/06			ecn no	-	rel level	Released	
chr	-	-	product family	PwrBlade					
appr	Pei-Ming Zheng	2014/05/06	 www.fci.com		title	6P + 24S R/A SOLDER RECEPTACLE		rev	A
					cat. no.	Product - Customer Drw	dwg no	51772-033	sheet 4 of 4

Print File - REC - 2009-08-09

Copyright FCI.

