

Excellent Integrated System Limited

Stocking Distributor

Click to view price, real time Inventory, Delivery & Lifecycle Information:

[FCI](#)

[51963-061LF](#)

For any questions, you can email us directly:

sales@integrated-circuit.com

Tous droits strictement réservés. Reproduction ou communication à des tiers interdite sous quelque forme que ce soit sans autorisation écrite du propriétaire. Propriété de C.FCI. Droits de reproduction FCI.



All rights strictly reserved. Reproduction or issue to third parties in any form whatever is not permitted without written authority from the proprietor. Property of FCI. Copyright FCI.

PRODUCT NO.	ROWS	SIGNAL																			
51963-061LF NOTE ③	D C B A	E1	1	2	3	4	5	6	7	8	9	10	11	12	13	14	15	16	17	18	E2
		19	20	21	22	23	24	25	26	27	28	29	30	31	32	33	34	35	36	37	38

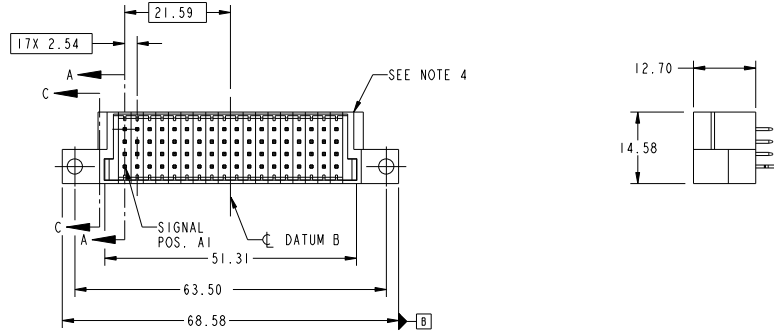

CODE	DIM "M" MATING LENGTH	CONTACT TYPE
E	[6.86]	SIGNAL
HA	[N/A]	HOLD-DOWN

mat'l code				tolerances unless otherwise specified		CUSTOMER	
ltr	ecm no.	dr	date	0.X	±0.5	COPY	www.fciconnect.com
A	DG10-0272	WL	07/23/10	0.XX	±0.25	projection	title
				0.XXX	±0.1	MM	VERTICAL SOLDER HEADER
				angles	0° ±2°	scale	product family
				dr	WL ZHANG 07/23/10	1:1	PwrBlade
				enr	WL ZHANG 07/23/10		code
				chr	PM ZHENG 07/23/10		213
				oppd	JOSEPH HSIA 07/23/10		sheet
sheet index	revision sheet	A 1	A 2	A 3	A 4		1 of 4

cage code 22526

Tous droits strictement réservés. Reproduction ou communication à des tiers interdite sous quelque forme que ce soit sans autorisation écrite du propriétaire. Propriété de FCI. Droits de reproduction FCI.

All rights strictly reserved. Reproduction or issue to third parties in any form whatever is not permitted without written authority from the proprietor. Property of FCI. Copyright FCI.



PRODUCT NUMBER
51963-061--
NOTE 3

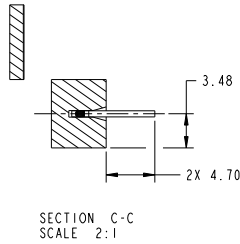
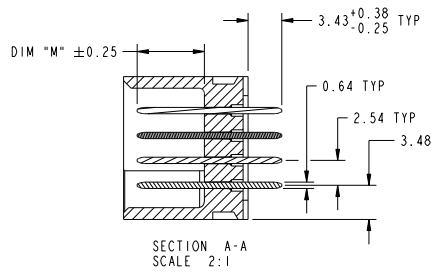

mat'l code				tolerances unless otherwise specified				CUSTOMER		FCI	
ltr	ecm no.	dr	date	linear	0.X ±0.5	projection	COPY		www.fciconnect.com		
A					0.XX ±0.25		title		72S		
				angles	0.XXX ±0.1		VERTICAL SOLDER HEADER		product family PwrBlade code		
				dr	0° ±2°	scale	size		213		
				enr	WL ZHANG 07/23/10	1:1	dwg no		sheet		
				chr	FW ZHENG 07/23/10		51963-061		2 of 4		
				oppd	JOSEPH HSIA 07/23/10		A				
sheet index	revision sheet						cage code		22526		

Pro/E

PDM: Rev:A

STATUS: Released

Printed: Dec 20, 2010

Tous droits strictement réservés. Reproduction ou communication à des tiers interdite sous quelque forme que ce soit sans autorisation écrite du propriétaire. Propriété de FCI. Droits de reproduction FCI.



All rights strictly reserved. Reproduction or issue to third parties in any form whatever is not permitted without written authority from the proprietor. Property of FCI. Copyright FCI.

PRODUCT NUMBER
51963-061...
NOTE 3

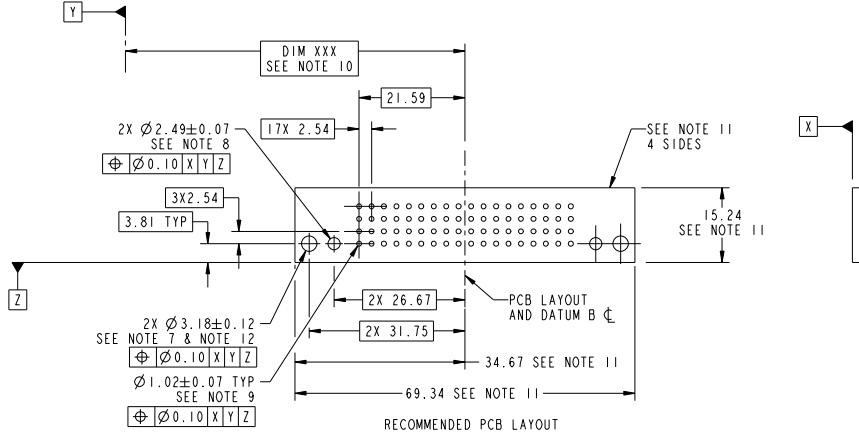

mat'l code				tolerances unless otherwise specified				CUSTOMER		FCI		www.fciconnect.com	
ltr	ecm no.	dr	date	linear	0.X ± 0.5	projection	COPY	title				72S	
A					0.XX ± 0.25		MM	VERTICAL SOLDER HEADER				213	
				angles	0° ± 2°			product family	PwrBlade		code	3 of 4	
				dr	WL ZHANG 07/23/10	scale	1:1	size	dwg no	51963-061	sheet	3 of 4	
				enrg	WL ZHANG 07/23/10								
				chr	FW ZHENG 07/23/10								
				oppd	JOSEPH HSIA 07/23/10								
sheet index	revision	sheet											

Pro/E

cage code 22526

Tous droits strictement réservés. Reproduction ou communication à des tiers interdite sous quelque forme que ce soit sans autorisation écrite du propriétaire. Propriété de FCI. Droits de reproduction FCI.

All rights strictly reserved. Reproduction or issue to third parties in any form whatever is not permitted without written authority from the proprietor. Property of FCI. Copyright FCI.

PRODUCT NUMBER
51963-061...
NOTE 3

NOTES:

1. DIMENSIONS AND TOLERANCES ARE IN ACCORDANCE WITH ASME Y14.5M, 1994 UNLESS OTHERWISE SPECIFIED.

CONNECTOR NOTES:

- 2 HOUSING MATERIAL: UL 94 V-0 GLASS FILLED HIGH-TEMP THERMOPLASTIC
POWER CONTACT MATERIAL: COPPER ALLOY
SIGNAL PIN MATERIAL: COPPER ALLOY
 - 3. SEE ITEM 1 & 2 IN PRINT 10064183 FOR PLATING SPEC OF 51963-061 AND 51963-061LF RESPECTIVELY.
 - 4 MANUFACTURER'S NAME, DATE CODE AND OPTIONAL P/N TO APPEAR ON THIS SURFACE. THE P/N CAN BE OMITTED IF THERE IS NOT ENOUGH SPACE ON THIS SURFACE.
 - 5. PRODUCT SPECIFICATION GS-12-149.
APPLICATION SPECIFICATION BUS-20-067.
 - 6. PACKAGED IN TRAYS.
- PCB NOTES:
- 7. ALL HOLE DIAMETERS ARE FINISHED HOLE SIZE.
 - 8. MOUNTING HOLES, WHERE APPLICABLE, ARE UNPLATED.
 - 9 $\varnothing 1.151 \pm 0.025$ DRILLED HOLES PLATED WITH 0.008 MIN SnPb OR Sn OVER .001 [0.03] TO 0.08 Cu PLATING TO ACHIEVE $\varnothing 1.02 \pm 0.07$ HOLE.
 - 10 "DIM XXX" TO BE DETERMINED BY THE CUSTOMER.
 - 11 CONNECTOR KEEP-OUT ZONE.
 - 12. CUSTOMER SUPPLIES (2) #4-40 UNC SCREW, HARDWARE TO MOUNT HEADER TO PC BOARD.

mat'l code				tolerances unless otherwise specified		CUSTOMER		FCI	
ltr	ecm no.	dr	date			COPY	www.fciconnect.com		
A				linear	0.X ± 0.5	projection		title 72S	
					0.XX ± 0.25			VERTICAL SOLDER HEADER	
				angles	0.XXX ± 0.1			product family	PwrBlade
				dr	0° ± 2°	scale	1:1	size	A
				enr	WL ZHANG 07/23/10	dwg no	51963-061	code	213
				chr	FW ZHENG 07/23/10	sheet	4 of 4		
				oppd	JOSEPH HSIA 07/23/10				
sheet index	revision sheet							cage code	22526