

Excellent Integrated System Limited

Stocking Distributor

Click to view price, real time Inventory, Delivery & Lifecycle Information:

[FCI](#)
[67095-007LF](#)

For any questions, you can email us directly:

sales@integrated-circuit.com

NOTE

MATERIAL:

1. HOUSING : PBT 15% GLASS FILLED, IJL94V0 BLACK.
THE HOUSING WILL WITHSTAND EXPOSURE TO 260-265°C FOR 3.5 SECONDS
IN A WAVE SOLDERING APPLICATION.
2. PIN : BRASS

PLATING :

- ① 2 MICRON MIN SnPb OVER 1.27 MICRON MIN. NICKEL UNDER COAT(FOR LEADED VERSION)
- ② 2 MICRON MIN MATTE TIN OVER 1.27 MICRON MIN. NICKEL UNDER COAT(FOR LEAD FREE VERSION)
- ③ 0.5 MICRON MIN Au OVER 1.27 MICRON MIN. NICKEL
- ④ 0.3 MICRON MIN Au OVER 1.27 MICRON MIN. NICKEL

6. POLARIZED HEADER SPECIFIED POSITION DOSE NOT HAVE PIN AS SHOWN

* 67095-0974TH FROM RIGHT

* 67095-0982ND FROM RIGHT

8. OPERATING TEMPERATURE : -25°C TO +85°C

9. MECHANICAL PERFORMANCE

DURABILITY (MATING CYCLES)

GOLD : .50

TIN-LEAD : .20

CONTACT RETENTION - 1.5 KG

10. ELECTRICAL PERFORMANCE

WITHSTANDING VOLTAGE : 750 V

INSULATION RESISTANCE : 500M Ω min

CURRENT RATING : 2 amp DC

CONTACT RESISTANCE : 20m Ω max

2.50 x (NO.OF POS.-1)

2.50
TYP

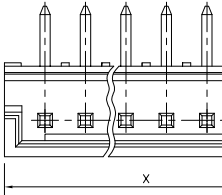

LEFT RIGHT

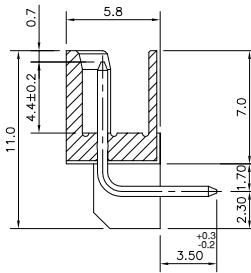
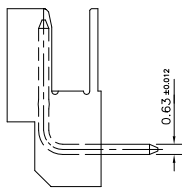
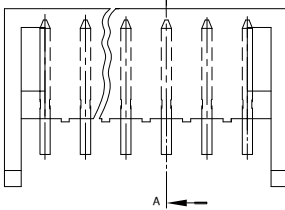

SECTION-AA

2.5 x (NO. OF POS. -1) ±0.08

2.50 ±0.08

40.80 ±0.1

RECOMMENDED PCB LAYOUT

PART NO:	PCS	DIM X	PLATING	PART NO:	PCS	DIM X	PLATING
67095-098 / 67095-098LF	7	20.0	①	67095-089 / 67095-089LF	15	40.0	
67095-097 / 67095-097LF	5	15.0		67095-088 / 67095-088LF	14	37.5	
67095-094 / 67095-094LF	20	52.5		67095-087 / 67095-087LF	13	35.0	
67095-093 / 67095-093LF	19	50.0		67095-086 / 67095-086LF	12	32.5	
67095-092 / 67095-092LF	18	47.5	②	67095-085 / 67095-085LF	11	30.0	
67095-091 / 67095-091LF	17	45.0		67095-084 / 67095-084LF	10	27.5	
67095-090 / 67095-090LF	16	42.5		67095-083 / 67095-083LF	9	25.0	
				67095-082 / 67095-082LF	8	22.5	
				67095-081 / 67095-081LF	7	20.0	
				67095-080 / 67095-080LF	6	17.5	
				67095-079 / 67095-079LF	5	15.0	
				67095-078 / 67095-078LF	4	12.5	
				67095-077 / 67095-077LF	3	10.0	
				67095-076 / 67095-076LF	2	7.5	
				67095-075 / 67095-075LF	20	52.5	
				67095-074 / 67095-074LF	19	50.0	
				67095-073 / 67095-073LF	18	47.5	
				67095-072 / 67095-072LF	17	45.0	
				67095-071 / 67095-071LF	16	42.5	
				67095-070 / 67095-070LF	15	40.0	
				67095-069 / 67095-069LF	13	35.0	
				67095-068 / 67095-068LF	12	32.5	
				67095-067 / 67095-067LF	11	30.0	
				67095-066 / 67095-066LF	10	27.5	
				67095-065 / 67095-065LF	9	25.0	
				67095-064 / 67095-064LF	8	22.5	
				67095-063 / 67095-063LF	7	20.0	
				67095-062 / 67095-062LF	6	17.5	
				67095-061 / 67095-061LF	5	15.0	
				67095-060 / 67095-060LF	2	7.5	
				67095-059 / 67095-059LF	14	37.5	
				67095-058 / 67095-058LF	3	10.0	
				67095-057 / 67095-057LF	4	12.5	
				67095-056 / 67095-056LF	20	52.5	
				67095-055 / 67095-055LF	19	50.0	
				67095-054 / 67095-054LF	18	47.5	
				67095-053 / 67095-053LF	17	45.0	
				67095-052 / 67095-052LF	16	42.5	
				67095-051 / 67095-051LF	15	40.0	
				67095-050 / 67095-050LF	14	37.5	
				67095-049 / 67095-049LF	13	35.0	
				67095-048 / 67095-048LF	12	32.5	
				67095-047 / 67095-047LF	11	30.0	
				67095-046 / 67095-046LF	10	27.5	
				67095-045 / 67095-045LF	9	25.0	
				67095-044 / 67095-044LF	8	22.5	
				67095-043 / 67095-043LF	7	20.0	
				67095-042 / 67095-042LF	6	17.5	
				67095-041 / 67095-041LF	5	15.0	
				67095-040 / 67095-040LF	4	12.5	
				67095-039 / 67095-039LF	3	10.0	
				67095-038 / 67095-038LF	2	7.5	

1. LF Products meet European Union Directives and other country Regulations as described in GS-22-008.
2. The Housing will withstand exposure to 260° peak temperature for 3.5 sec in a wave solder application with a 1.6mm Min thick circuitboard.
3. Lead Free or ROHS Directive labelling to be provided as per GS-14-920 for Lead Free version.

mat'l. code	SEE NOTE 4	surface	tolerance	projection	product family
ISO 1302		ISO 406 ISO 1101			RELIMATE
tr	ecn no	dr	date	angles	linear
P	106-0123	HVN	2006-07-20	0°±2°	
R	107-0039	HVN	2007-03-16		
dr	MINI K VANDANATH		2003-04-14		
engr	Hiran V N		2003-04-14		
chr	HRAN V N		2007-03-16		
appd	HRAN V N		2007-03-16		
sheet index	revision sheet	R	1		

title	product family
RELIMATE HEADER VERTICAL (R/A)	RELIMATE
dwg no	sheet 1 of 1
67095	A3
type	Product Customer Drawing