

Excellent Integrated System Limited

Stocking Distributor

Click to view price, real time Inventory, Delivery & Lifecycle Information:

[FCI](#)

[10106265-D006002LF](#)

For any questions, you can email us directly:

sales@integrated-circuit.com

PRODUCT NUMBER SEE SHEET 2

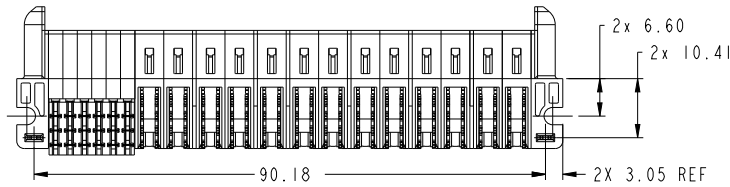
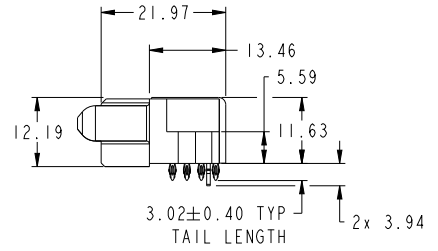
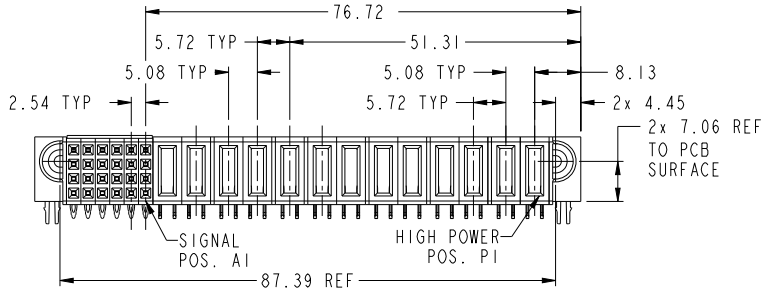
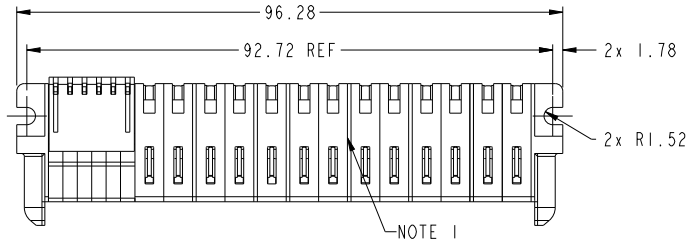

spec ref	*	dr	Rainbow Zhan	20140923	projection	MM	size	A3	scale	3:2	
tolerance std	ASME Y14.5	eng	Rainbow Zhan	20140928			ecm no				
TOLERANCES UNLESS OTHERWISE SPECIFIED		chr	Li-Hu	20140928			product family	PwrBlade+	rel level	Released	
surface	linear	appr	Pai-Ming Zhang	20140928					cat. no.	10106265-D006002	rev
	angular						Product - Customer Drw	sheet 1 of 3			

Print Date - REV C - 2010-04-20

1

2

3

PDS: Rev A

STATUS: Released

Printed: Sep 29, 2014



Copyright FCI.

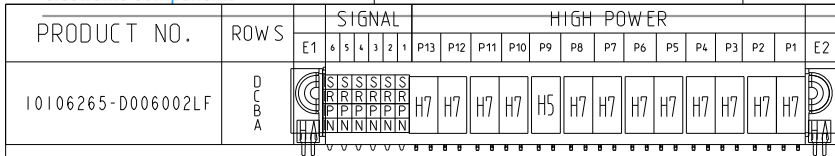

CODE	DESCRIPTION
H5	MFBL HIGH POWER CONTACT(3.02)
H7	STD HIGH POWER CONTACT(3.02)
HA	METAL HOLD DOWN
N	STD SIGNAL CONTACT, ROW A
P	STD SIGNAL CONTACT, ROW B
R	STD SIGNAL CONTACT, ROW C
S	STD SIGNAL CONTACT, ROW D

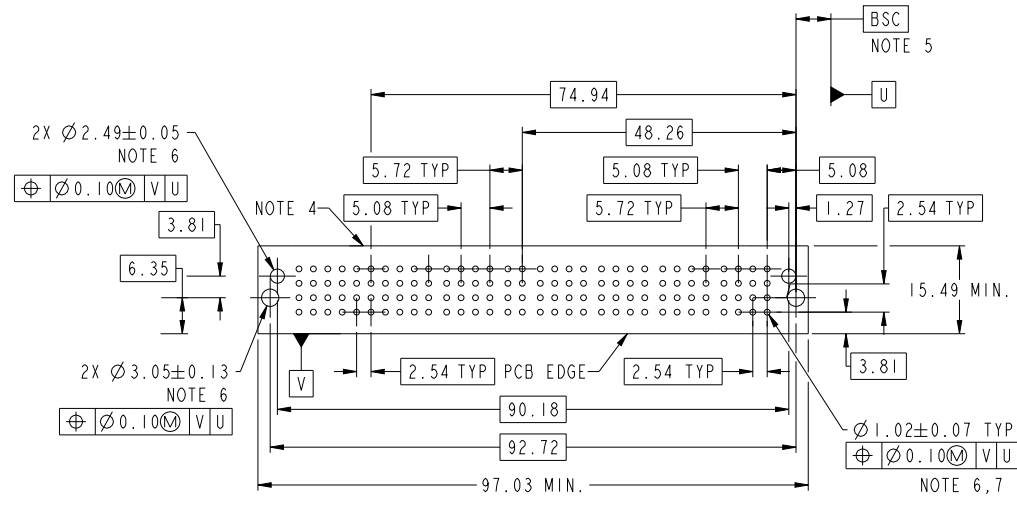

dr	Rainbow Zhan	2014/09/23	projection	MM	size	A3	scale	3:2
eng	Rainbow Zhan	2014/09/28			ecn no	-	rel level	Released
chr	Li-Hu	2014/09/28						
appr	Pai-Ming Zhang	2014/09/28	product family	PwrBlade+				
			title 13HP + 24S RA PF RECEPTACLE			eng no 10106265-D006002		rev A
www.fci.com			cat. no.		Product - Customer Drw		sheet 2 of 3	

Copyright FCI.

NOTES:

- 1) "FCI", PART NUMBER AND DATE CODE TO BE MARKED ON THIS SURFACE.
THE MARK CAN BE OMITTED IF THERE IS NOT ENOUGH SPACE ON THIS SURFACE.
- 2) MATERIALS:
-HOUSING - GLASS FILLED WITH HIGH TEMP THERMOPLASTIC, UL94V-0.
-SIGNAL CONTACT - COPPER ALLOY.
-POWER CONTACT - HIGH CONDUCTIVITY COPPER ALLOY.
- 3) PLATING SPECIFICATION REFER TO FCI 10116351
- 4) DENOTES CONNECTOR KEEP OUT ZONE.
- 5) DATUM AND BASIC DIMENIONS WERE ESTABLISHED BY CUSTOMER.
- 6) ALL HOLE DIAMETERS ARE FINISHED HOLE SIZES.
- 7) 1.15 ± 0.025 MM DRILLED HOLE PLATED WITH 0.00762MM MIN Sn
OVER 0.0254-0.0762MM Cu PLATING TO ACHIEVE A 1.02 ± 0.07 MM HOLE.
- 8) PRODUCT SPECIFICATION REFER TO FCI GS-12-658.
APPLICATION SPECIFICATION REFER TO FCI GS-20-141.
PRODUCT PACKAGED IN TRAYS, REFER TO FCI GS-14-1502.
- 9) THE VOID CORING IN BETWEEN POWER MODULES, SIGNAL
MODULES AND END MODULES ARE OPTIONAL AND THE SHAPE
MAY BE DIFFERENT FOR OPTIMIZE THE MOLDING PROCESS. THE
VOID CORING WILL NOT EFFECT TO PRODUCT FUNCTION.

dr	Rainbow Zhan	20140923	projection	MM	size	A3	scale	3:2
eng	Rainbow Zhan	20140928			ecn no	-	rel level	
chr	Li-Hu	20140928			product family	PwrBlade+	Released	
appr	Pai-Ming Zhang	20140928			cat. no.	10106265-D006002		rev
			title 13HP + 24S RA PF RECEPTACLE		Product - Customer Drw		sheet 3 of 3	
www.fci.com			3		PDS: Rev :A		STATUS:Released	



Copyright FCI.