

Excellent Integrated System Limited

Stocking Distributor

Click to view price, real time Inventory, Delivery & Lifecycle Information:

[FCI](#)

[10106269-5206002LF](#)

For any questions, you can email us directly:

sales@integrated-circuit.com

PRODUCT NUMBER SEE SHEET 2

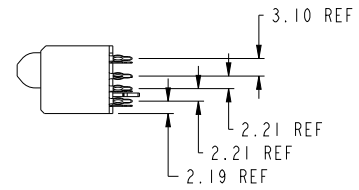
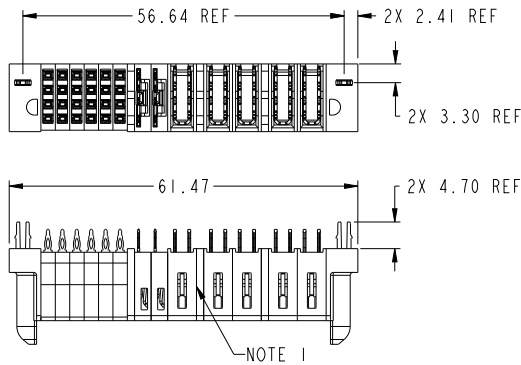

SECTION Z-Z

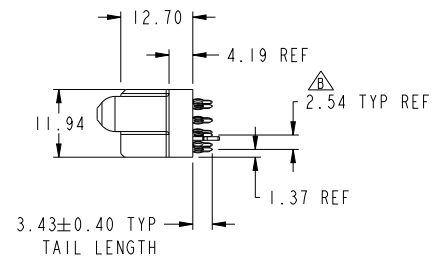
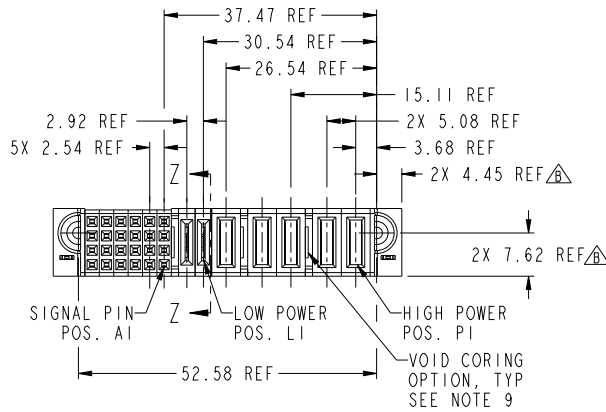

spec ref	dr	Peng-Bing Fu	20120509	projection	MM	size	A3	scale	3:2
tolerance std	eng	Peng-Bing Fu	20121115			ecn no	ELX-00-01546-1	rel level	Released
ASME Y14.5	chr	Tian-Xu Huang	20121115						
TOLERANCES UNLESS OTHERWISE SPECIFIED		appr	Pai-Ming Zhang						
surface	linear	0.X	±0.50			title	5HP + 2LP + 24S		rev
ASME Y14.5	angular	0.XX	±0.25	www.fci.com		cat. no.	10106269-5206002		B
		0.XXX	±0.10	Product - Customer Drw		sheet 1 of 3			
		0°	±2°						

Prod File - REV C - 2009-04-09

1

2

3

PDS: Rev B

STATUS: Released

Printed: Nov 14, 2012



Copyright FCI.

PRODUCT NO.	ROWS	SIGNAL					LP		HIGH POWER						
		E1	6	5	4	3	2	1	IP2	LP1	P5	P4	P3	P2	P1
10106269-5206002LF	D C B A														

CODE	DESCRIPTION
F	STD SIGNAL CONTACT
HA	METAL HOLD DOWN
HD	MFBL HIGH POWER CONTACT (3.43)
HG	STD HIGH POWER CONTACT (3.43)
LT	STD LOW POWER CONTACT (3.43)

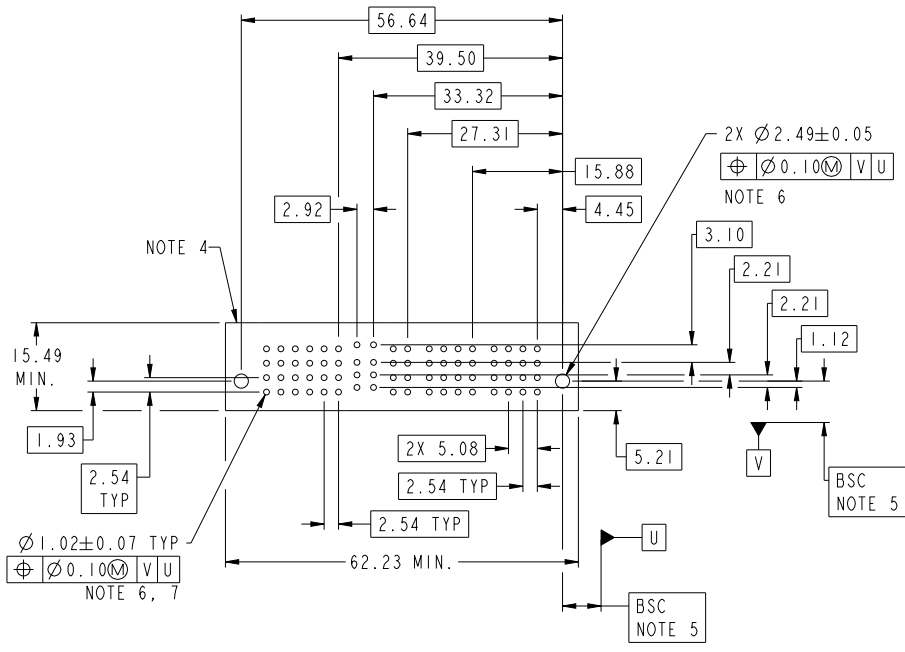

dr	Peng-Bing Fu	20120509	projection	MM	size	A3	scale	3:2
eng	Peng-Bing Fu	20121115		←	ecn no	ELX-00-015146-1		
chr	Tian-Xu Huang	20121115			rel level	Released		
appr	Pai-Ming Zhang	20121115	product family	PowerBlade+				
			title	5HP + 2LP + 24S		eng no	10106269-5206002	
www.fci.com			cat. no.	Product - Customer Draw		rev	B	

NOTES:

- 1) "FCI", PART NUMBER AND DATE CODE TO BE MARKED ON THIS SURFACE.
THE P/N CAN BE OMITTED IF THERE IS NOT ENOUGH SPACE ON THIS SURFACE.
- 2) MATERIALS:
-HOUSING - GLASS FILLED WITH HIGH TEMP THERMOPLASTIC, UL94V-0.
-SIGNAL CONTACT - COPPER ALLOY.
-POWER CONTACT - HIGH CONDUCTIVITY COPPER ALLOY.
- 3) PLATING SPECIFICATION REFER TO FCI 10116351
- 4) DENOTES CONNECTOR KEEP OUT ZONE.
- 5) DATUM AND BASIC DIMENSIONS WERE ESTABLISHED BY CUSTOMER.
- 6) ALL HOLE DIAMETERS ARE FINISHED HOLE SIZES.
- 7) 1.15 ± 0.025 MM DRILLED HOLE PLATED WITH 0.00762MM MIN Sn
OVER 0.0254-0.0762MM Cu PLATING TO ACHIEVE A 1.02 ± 0.07 MM HOLE.
- 8) PRODUCT SPECIFICATION REFER TO FCI GS-12-658.
APPLICATION SPECIFICATION REFER TO FCI GS-20-141.
PRODUCT PACKAGED IN TRAYS, REFER TO FCI GS-14-1502.
- 9) THE VOID CORING IN BETWEEN POWER MODULES, SIGNAL
MODULES AND END MODULES ARE OPTIONAL AND THE SHAPE
MAY BE DIFFERENT FOR OPTIMIZE THE MOLDING PROCESS. THE
VOID CORING WILL NOT EFFECT TO PRODUCT FUNCTION.
- 10) A Δ SYMBOL WILL BE NEXT TO ANY DIMENSION, VIEW, OR NOTE WHICH HAS
BEEN MODIFIED WITH THE CURRENT DRAWING REVISION.

dr	Peng-Bing Fu	20120509	projection	MM	size	A3	scale	1:1
eng	Peng-Bing Fu	20121113			ecn no	ELX-00-01846-1		
chr	Tian-Xu Huang	20121113			rel level	Released		
appr	Pai-Ming Zhang	20121113	product family	PowerBlade+				
		title 5HP + 2LP + 24S VT PF RECEPTACLE	eng no 10106269-5206002	rev B				
www.fci.com		cat. no.	Product - Customer Draw		sheet 3 of 3			



Copyright FCI.